

This map is reproduced from Ordnance Survey material with the permission of Ordnance Survey on behalf of the Controller of Her Majesty's Stationery Office. © Crown copyright. Unauthorised reproduction infringes Crown copyright and may lead to prosecution or civil proceedings. Stockport Metropolitan Borough Council AC0000804784 2024

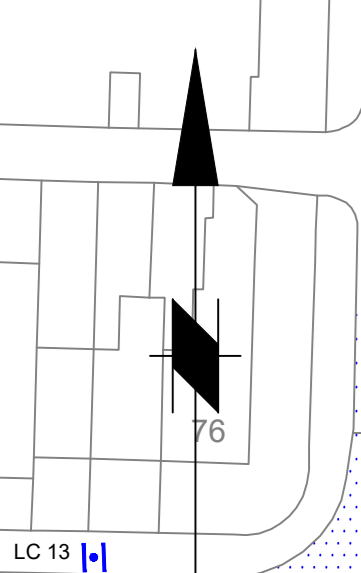

- KEY:**
- PROPOSED 20MPH SPEED LIMIT
  - EXISTING 20MPH
  - BUS STOP UPGRADE
  - PROPOSED BACK TO BACK 20/30 MPH ROUND EL SIGNS
  - PROPOSED BACK TO BACK 20 MPH REPEATER ROUND EL SIGNS
  - PROPOSED 20MPH ROUND EL SIGN (DIAG 670)
  - PROPOSED 30MPH ROUND EL SIGN (DIAG 670)
  - PROPOSED 20MPH ROUND EL ROAD MARKING



SHEET 1  
SHEET 2

SHEET 3  
SHEET 2

END OF SCHEME  
END OF SCHEME

END OF SCHEME  
END OF SCHEME

Rev.	Drawn	Checked	Date	Revision Details
AMENDMENTS				
 <b>STOCKPORT</b> METROPOLITAN BOROUGH COUNCIL <small>ROADS AND TRANSPORTATION SERVICES STOCKPORT SA1 3SE</small>				
<small>NEW YORK DIRECTOR OF PLANNING</small> Job Title				
<b>5217 VAUXHALL INDUSTRIAL AREA</b>				
Drawing Title <b>20 MPH LOCATION PLAN</b>				
Drawn	Engineer	Checked	Approved	
SK	TB	JG	NW	
Date	Date	Date	Date	
01/08/2024	03/09/2024	05/04/2024	05/09/2024	
Size	Scale			
A0	1:500			
Drawing No.	Revision			
F/5217/CON/20MPH/002				

FOR CONSULTATION