

This map is reproduced from Ordnance Survey material with the permission of Ordnance Survey on behalf of the Controller of Her Majesty's Stationery Office. Crown copyright. Unauthorised reproduction infringes Crown copyright and may lead to prosecution or civil proceedings. Stockport Metropolitan Borough Council 100019571 2024

EXISTING

KEY - SIGNAGE



Resident permit holders only

EXISTING SIGN ON POST. ● P

EXISTING SIGN ON LIGHTING COLUMN. ● LC

PROPOSED

KEY - SIGNAGE



Resident permit holders only

PROPOSED SIGN ON NEW POST. ● TS P

PROPOSED SIGN ON LIGHTING COLUMN. ● LC TS

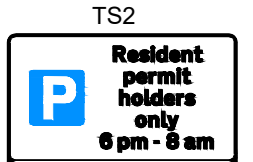

**Resident permit holders only
6 pm - 8 am**

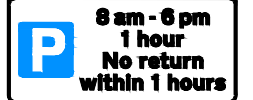

**8 am - 6 pm
1 hour
No return within 1 hours**

EXISTING SIGN ON POST TO REMAIN. ● P

EXISTING SIGN ON LIGHTING COLUMN TO REMAIN. ● LC

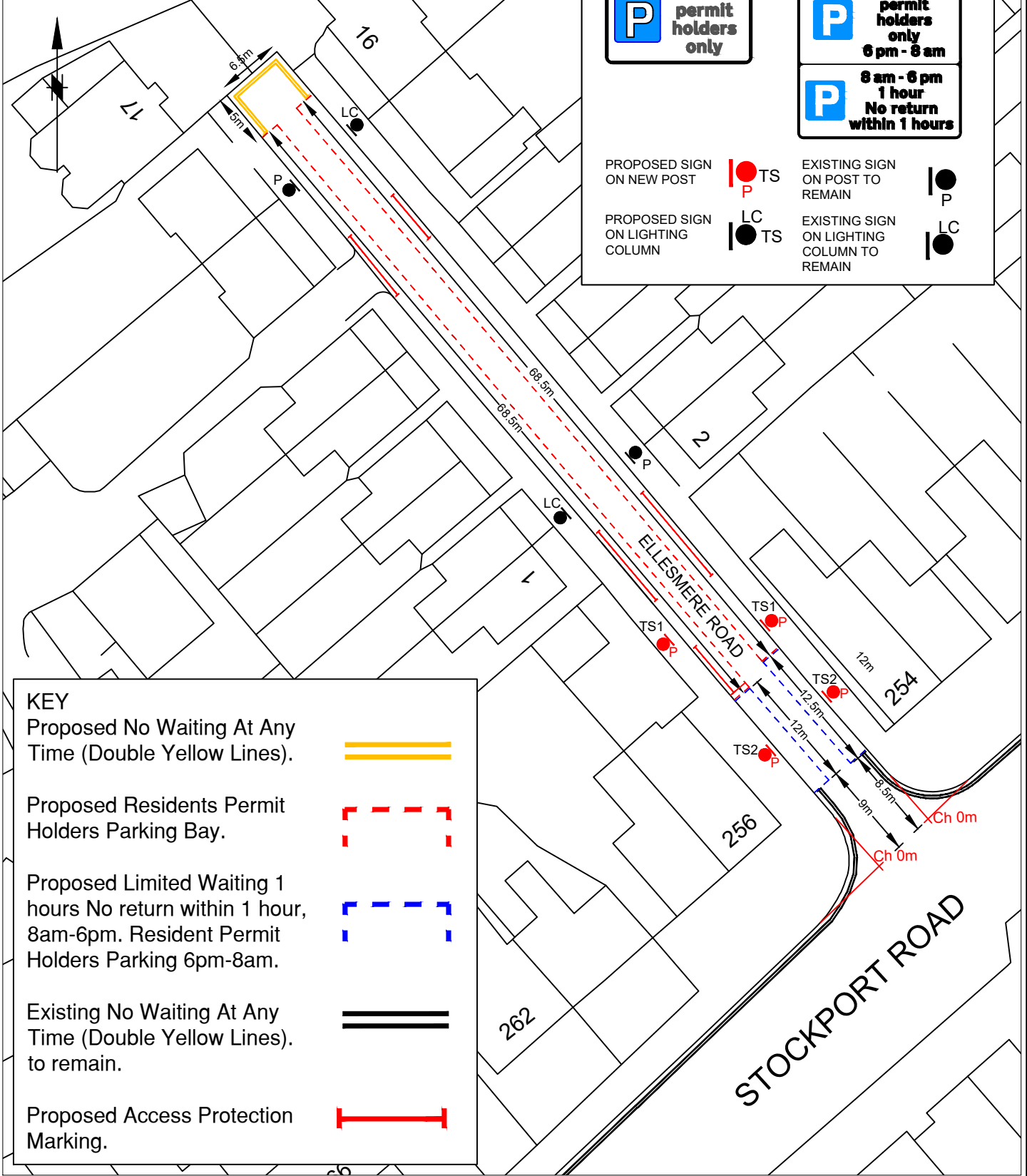
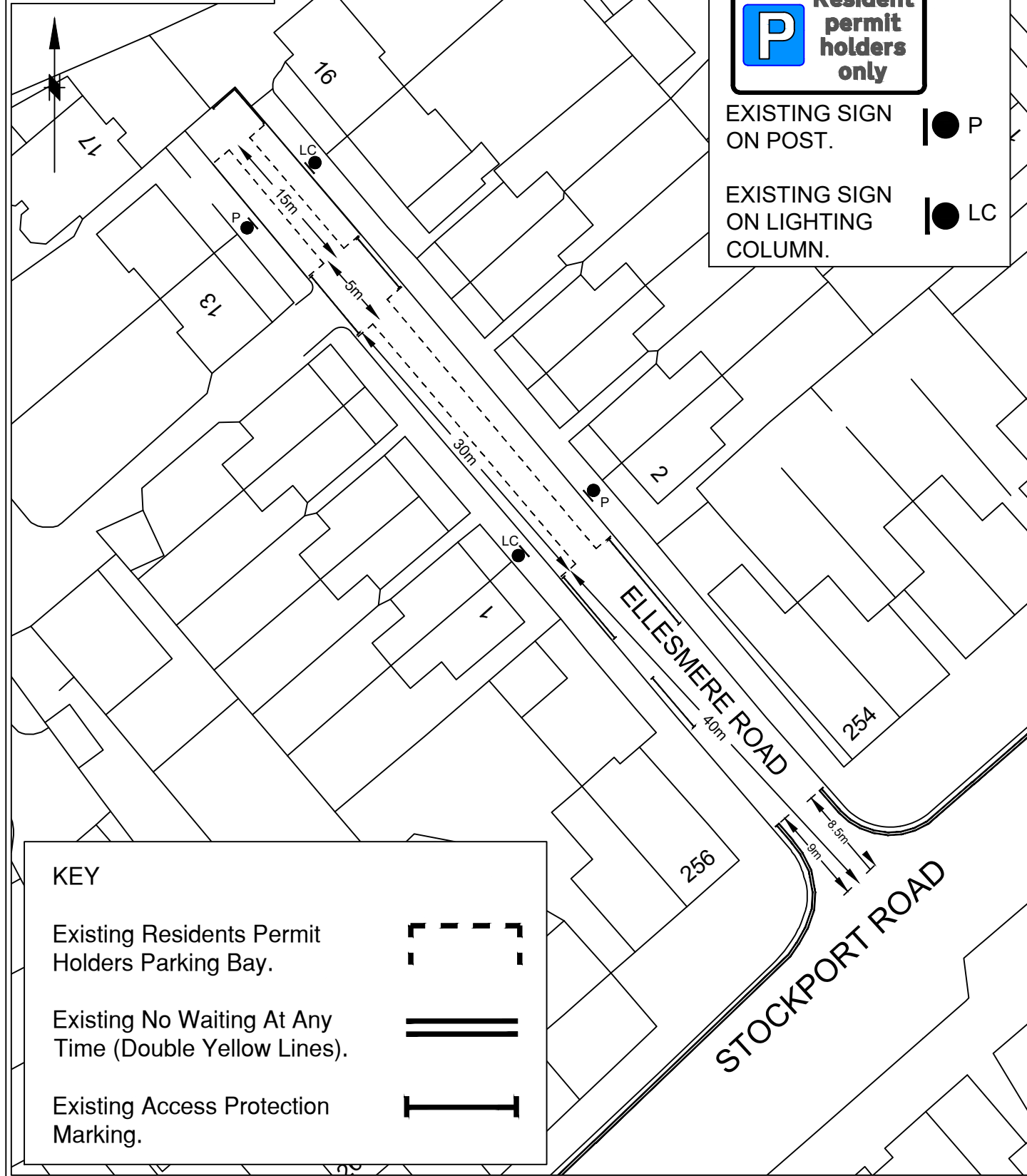

KEY

Proposed No Waiting At Any Time (Double Yellow Lines).

Proposed Residents Permit Holders Parking Bay.

Proposed Limited Waiting 1 hours No return within 1 hour, 8am-6pm. Resident Permit Holders Parking 6pm-8am.

Existing No Waiting At Any Time (Double Yellow Lines). to remain.

Proposed Access Protection Marking.

KEY

Existing Residents Permit Holders Parking Bay.

Existing No Waiting At Any Time (Double Yellow Lines).

Existing Access Protection Marking.



STOCKPORT

METROPOLITAN BOROUGH COUNCIL

HIGHWAYS AND TRANSPORTATION
STOFFORD HOUSE
STOCKPORT SK1 3XE
TEL

SERVICES TO PLACE

AMENDMENTS

| DRAWN | CHECKED | DATE | No | AMENDMENT |
|-------|---------|------|----|-----------|
| | | | | |

JOB TITLE

Ellesmere Road, Cheadle Heath

Proposed Traffic Regulation Order
'No Waiting At Any Time' & 'Residents Permit Parking', 'Limited Waiting' and 'Disabled' Bay.

| Drawn | Engineer | Checked | Approved |
|---------------------------------------|------------------|------------------|------------------|
| SA | NR | NR | EPS |
| Date 23/04/24 | Date 23/04/24 | Date 23/04/24 | Date 23/04/24 |
| Scale 1:500@A3 | | | |
| Drawing No. NM27-Ellesmere Road-01 | | | Revision E |