

This map is reproduced from Ordnance Survey material with the permission of Ordnance Survey on behalf of the Controller of Her Majesty's Stationery Office © Crown copyright. Unauthorised reproduction infringes Crown copyright and may lead to prosecution or civil proceedings. Stockport Metropolitan Borough Council AC0000804794 2024

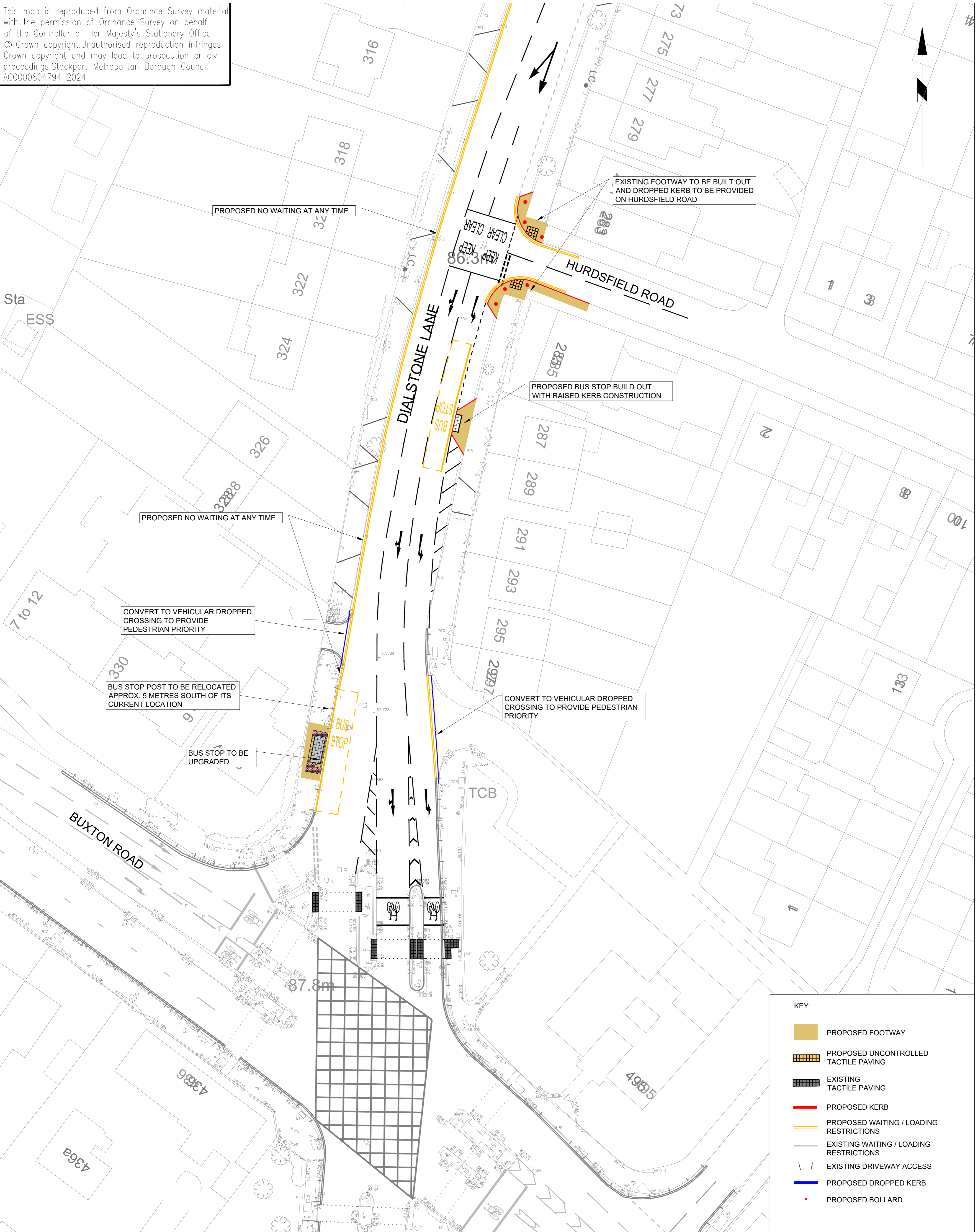

KEY:

- PROPOSED FOOTWAY
- PROPOSED UNCONTROLLED TACTILE PAVING
- EXISTING TACTILE PAVING
- PROPOSED KERB
- PROPOSED WAITING / LOADING RESTRICTIONS
- EXISTING WAITING / LOADING RESTRICTIONS
- EXISTING DRIVEWAY ACCESS
- PROPOSED DROPPED KERB
- PROPOSED BOLLARD



STOCKPORT
METROPOLITAN BOROUGH COUNCIL

HIGHWAYS AND TRANSPORTATION
STOPFORD HOUSE
STOCKPORT SK1 3XE

MARK GLYNN
DIRECTOR OF PLACE MANAGEMENT

Rev.	Drawn	Checked	Date	Revision Details
C	RPO	CAS	12.09.24	AMENDMENTS AS PER DRP REPORT

DRAWN	ENGINEER	CHECKED	APPROVED
KS & RPO	KS & RPO	CAS	NW
DATE	DATE	DATE	DATE
24/08/24	24/08/24	26/06/24	26/06/24

SCALE 1:250 @ A1
DRAWING NUMBER F-0700-01B-001
Revision C

JOB TITLE **BUS PINCH POINTS**

DRAWING TITLE **A6 DIALSTONE LANE CAPACITY IMPROVEMENTS - A6 BUXTON RD / DIALSTONE LN**