

This map is reproduced from Ordnance Survey material with the permission of Ordnance Survey on behalf of the Controller of Her Majesty's Stationery Office. © Crown copyright. Unauthorised reproduction infringes Crown copyright and may lead to prosecution or civil proceedings. Stockport Metropolitan Borough Council AC0000804784 2024

- KEY - GENERAL:**
- PROPOSED CARRIAGEWAY RESURFACING
 - PROPOSED PEDESTRIAN SIGNALISED CROSSING
 - PROPOSED PEDESTRIAN & CYCLE TOUCAN CROSSING
 - PROPOSED TRAFFIC CALMING FEATURE
 - PROPOSED KERBS
 - PROPOSED EDGINGS
 - PROPOSED FOOTWAY SURFACING
 - PROPOSED SHARED FOOTWAY / CYCLEWAY
 - PROPOSED SEGREGATED CYCLEWAY
 - PROPOSED WHITE ROAD MARKINGS
 - PROPOSED YELLOW ROAD MARKINGS
 - PROPOSED OR EXISTING RED TACTILE PAVING (CONTROLLED CROSSING)
 - PROPOSED BUFF TACTILE PAVING (UNCONTROLLED CROSSING)
 - EXISTING BUFF TACTILE PAVING (UNCONTROLLED CROSSING)
 - PROPOSED CYCLE CORDUROY PAVING (SHARED USE BOUNDARY)
 - PROPOSED BUS STOP PAVING
 - PROPOSED BOLLARD
 - VERGE
 - PROPOSED HEDGES
 - PROPOSED WOODEN FENCE
 - PROPOSED TREE
 - EXISTING TREE TO BE REMOVED

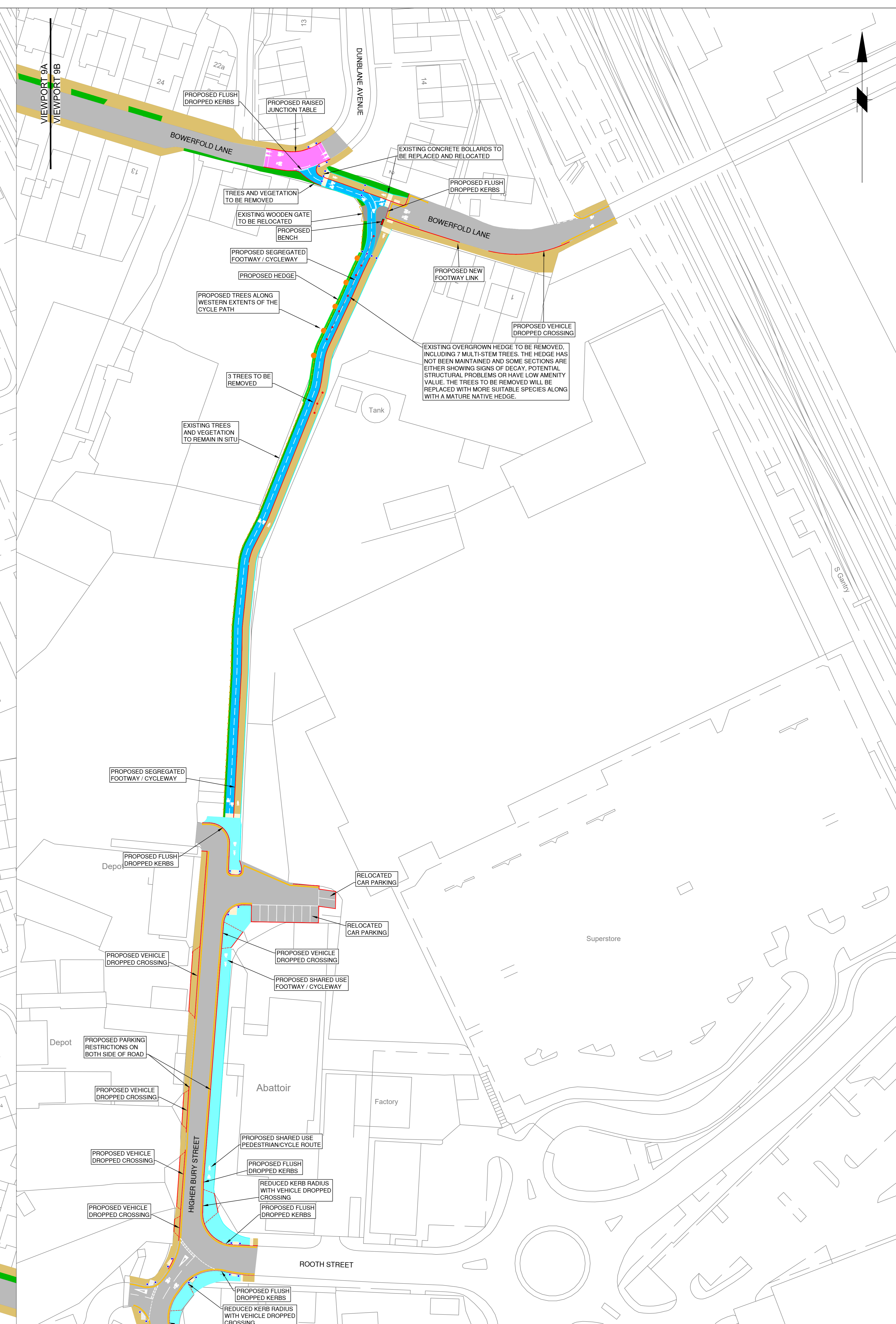

SHEET 9 (VIEWPORT 9A)



SHEET 9 (VIEWPORT 9B)

FOR CONSULTATION

Rev	Drawn	Checked	Date	Revision Details
AMENDMENTS				
 STOCKPORT METROPOLITAN BOROUGH COUNCIL <small>ROADWAYS AND TRANSPORTATION SERVICES</small>				
Job Title: AS CORRIDOR (IN STOCKPORT) IMPROVING JOURNEYS				
Drawing Title: WESTERN ROUTE GENERAL ARRANGEMENT SHEET 9 OF 13				
Drawn	Engineer	Checked	Approved	
DN	DN	JG	NDW	
Date	Date	Date	Date	
16/02/24	16/02/24	16/02/24	16/02/24	
Size	Scale			
A0	1:500			
Drawing No. F-5223-A6BR-CON-0009				