

This map is reproduced from Ordnance Survey material with the permission of Ordnance Survey on behalf of the Controller of Her Majesty's Stationery Office © Crown copyright. Unauthorised reproduction infringes Crown copyright and may lead to prosecution or civil proceedings. Stockport Metropolitan Borough Council 100019571 2023

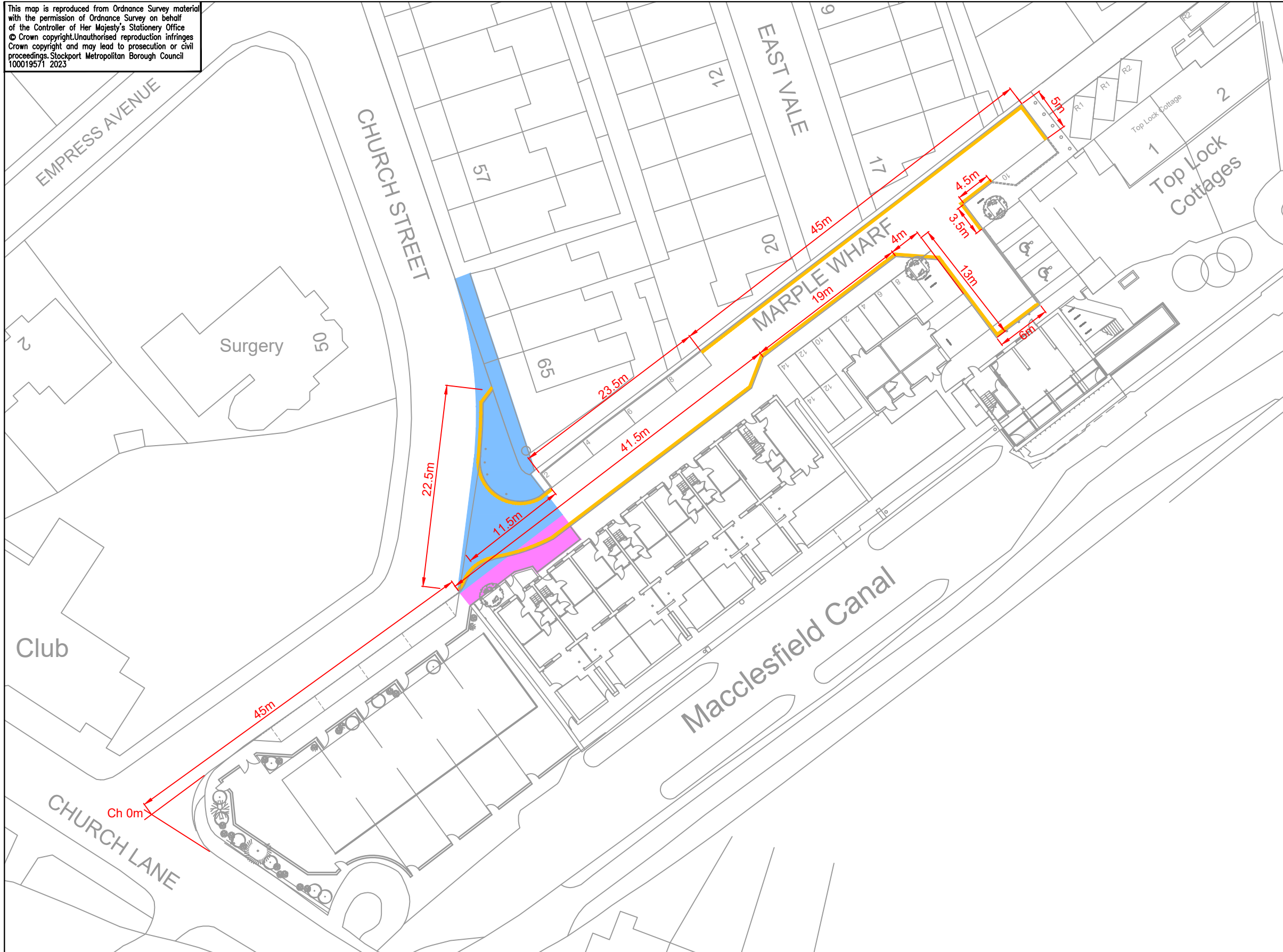

KEY:

- DENOTES EXTENT OF PRIVATELY OWNED LAND
- DENOTES EXTENT OF EXISTING ADOPTED HIGHWAY WHERE WORKS WILL BE UNDERTAKEN
- DENOTES EXTENT OF ROAD AND FOOTWAY BEING OFFERED FOR ADOPTION TO SMBC
- PROPOSED NO WAITING AT ANY TIME (DOUBLE YELLOW LINES)



STOCKPORT
 METROPOLITAN BOROUGH COUNCIL
 HIGHWAYS AND TRANSPORTATION
 STOPFORD HOUSE
 STOCKPORT SK1 3XE

MARK GLYNN
 DIRECTOR OF PLACE MANAGEMENT

AMENDMENTS

DRAWN	CHECKED	DATE	No	AMENDMENT
ALB	MDJ	13.06.24	A	MARPLE WHARF street name added

JOB TITLE

MARPLE WHARF - DC/074338

DRAWING TITLE

TRO PLAN

Drawn ALB	Engineer ALB	Checked MDJ	Approved EPS
Date 03/05/24	Date 03/05/24	Date 07/05/24	Date 07/05/24
Scale 1:250@A3			
Drawing No. C_4335_0000_001_02			Revision B