

This map is reproduced from Ordnance Survey material with the permission of Ordnance Survey on behalf of the Controller of Her Majesty's Stationery Office © Crown copyright. Unauthorised reproduction infringes Crown copyright and may lead to prosecution or civil proceedings. Stockport Metropolitan Borough Council 100019571 2022

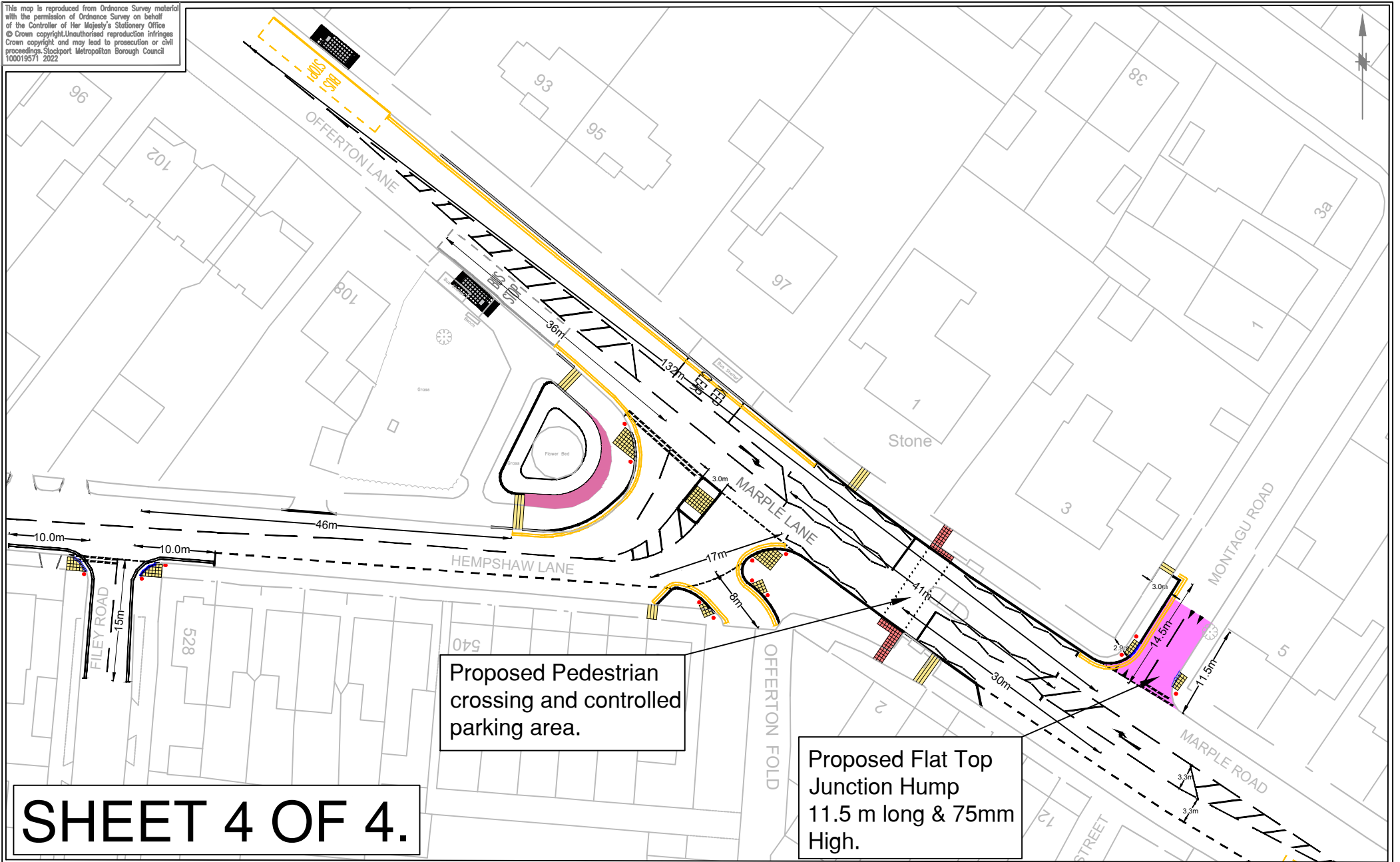

Proposed Pedestrian crossing and controlled parking area.

Proposed Flat Top Junction Hump
11.5 m long & 75mm High.

SHEET 4 OF 4.



STOCKPORT
METROPOLITAN BOROUGH COUNCIL
HIGHWAYS AND TRANSPORTATION
STOPFORD HOUSE
STOCKPORT SK1 3ZE
TEL

SERVICES TO PLACE

AMENDMENTS				
DRAWN	CHECKED	DATE	No	AMENDMENT

JOB TITLE
Hempsshaw Lane, Stockport CRSTS Scheme
Proposed Pedestrian Crossing and Traffic Calming Feature

Drawn SA	Engineer SA	Checked PH	Approved EPS
Date 28/03/24	Date	Date	Date
Scale NTS			
Drawing No. CRSTS -Hempsshaw-TRO-01			Revision