

This map is reproduced from Ordnance Survey material with the permission of Ordnance Survey on behalf of the Controller of Her Majesty's Stationery Office. © Crown copyright and may be reproduced in any form without the prior written permission of Ordnance Survey. All rights reserved. 10001951, 2022

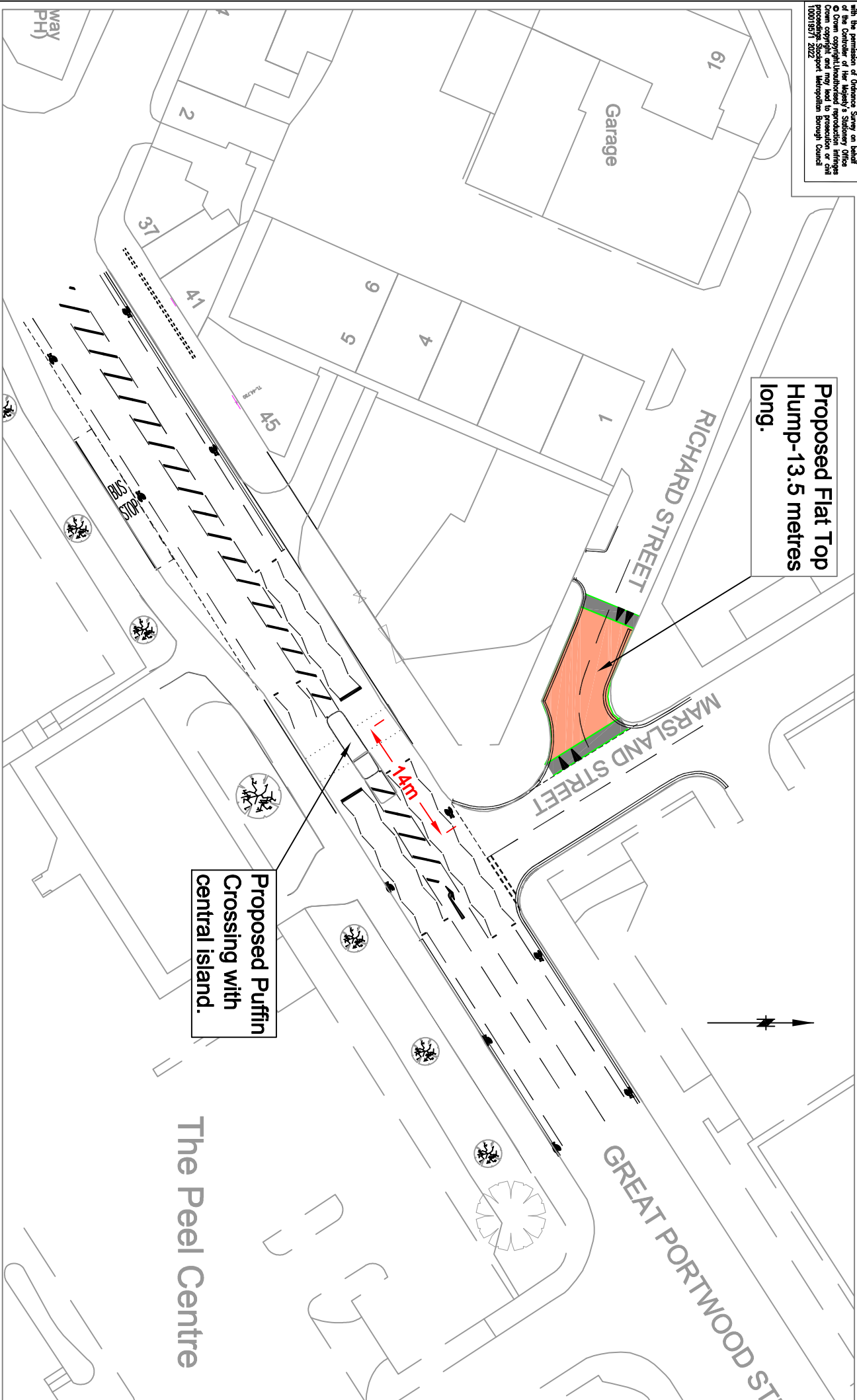

**Proposed Flat Top Hump-13.5 metres long.**

**Proposed Puffin Crossing with central island.**

**The Peel Centre**



**STOCKPORT**  
METROPOLITAN BOROUGH COUNCIL  
HIGHWAYS AND TRANSPORTATION  
STOCKPORT SKI SITE

SERVICES TO PLACE

AMENDMENTS				
DRAWN	CHECKED	DATE	NO	AMENDMENT

**JOB TITLE**  
CRSTS A560 QUALITY BUS TRANSIT

SCHEME A - GREAT PORTWOOD STREET  
FLAT TOP HUMPS & PUFFIN CROSSING

Drawn	Engineer	Checked	Approved
SA	SA	JH	NW
Date	Date	Date	Date
05/07/2024	05/07/2024	05/07/2024	05/07/2024

Scale  
NTS  
Drawing No.  
F-0712-TRO-01

Revision