

- KEY - GENERAL:**
- PROPOSED CARRIAGEWAY
  - EXISTING OR PROPOSED HARD STANDING
  - PEDESTRIAN SIGNALISED CROSSING
  - PEDESTRIAN & CYCLE TOUCAN CROSSING
  - PROPOSED TRAFFIC CALMING FEATURE
  - PROPOSED KERBS
  - PROPOSED FOOTINGS
  - PROPOSED EDGINGS
  - PROPOSED SHARED FOOTWAY / CYCLEWAY
  - PROPOSED SEGREGATED FACILITY
  - PROPOSED WHITE ROAD MARKINGS
  - PROPOSED YELLOW ROAD MARKINGS
  - PROPOSED RED TACTILE PAVING (CONTROLLED CROSSING)
  - PROPOSED BUFF TACTILE PAVING (UNCONTROLLED CROSSING)
  - EXISTING BUFF TACTILE PAVING (UNCONTROLLED CROSSING)
  - PROPOSED CYCLE CORRIDOR PAVING (SHARED USE BOUNDARY)
  - PROPOSED BUS STOP PAVING
  - PROPOSED BOLLARD
  - PROPOSED BENCH
  - PROPOSED TREE
  - VERGE

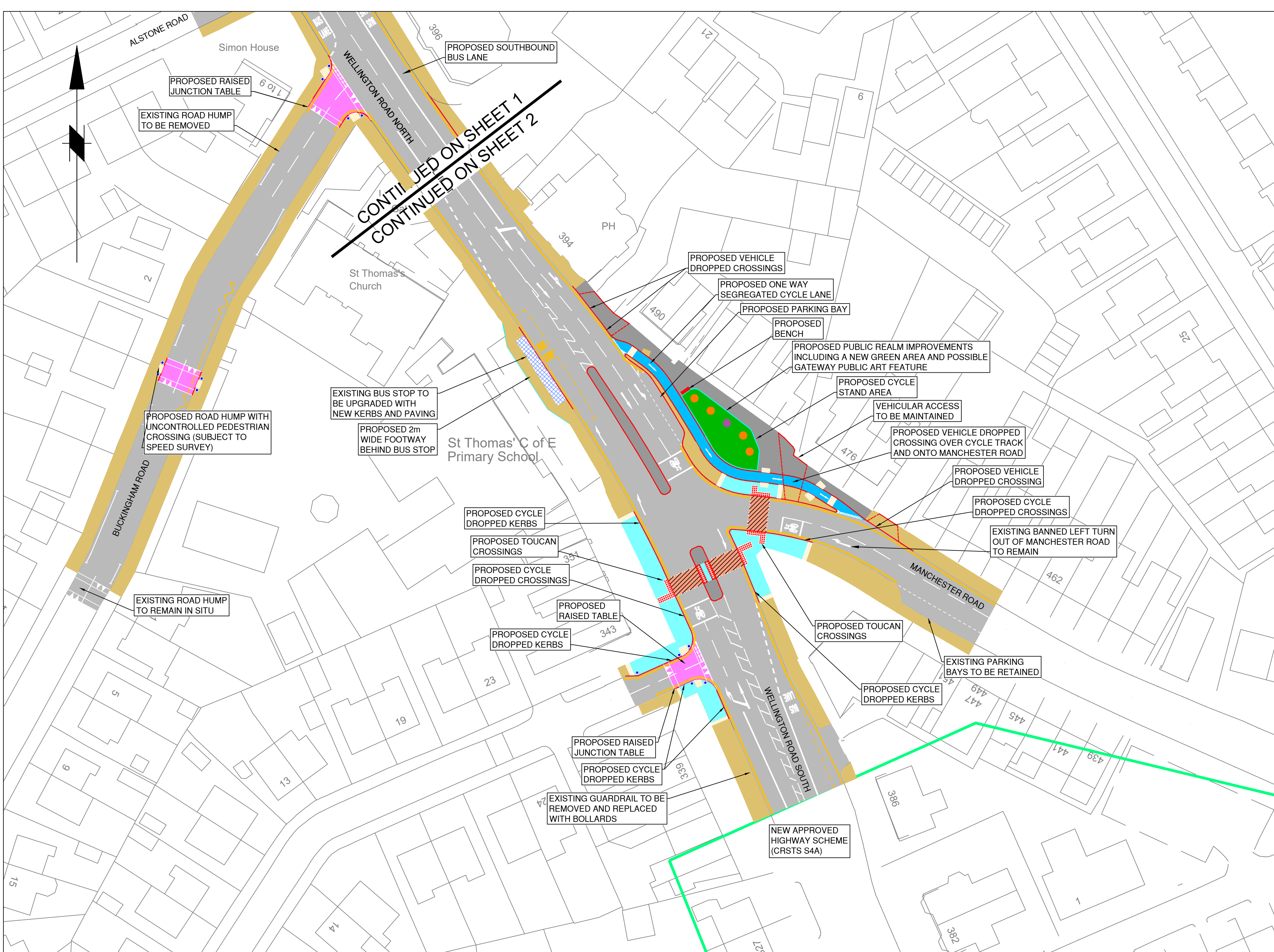

SHEET 2 (VIEWPORT 2A) - OPTION 1A

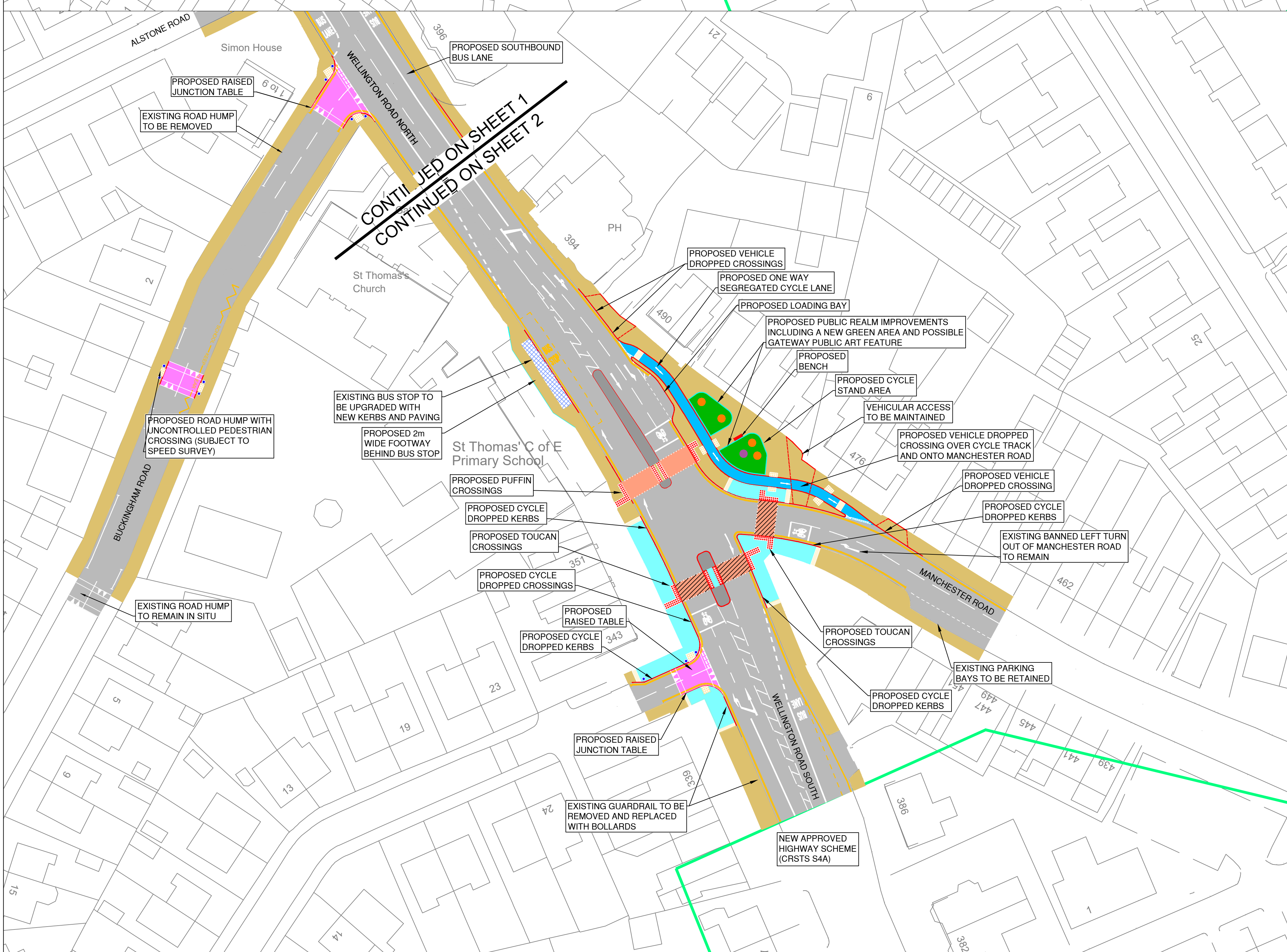

SHEET 2 (VIEWPORT 2A) - OPTION 2A

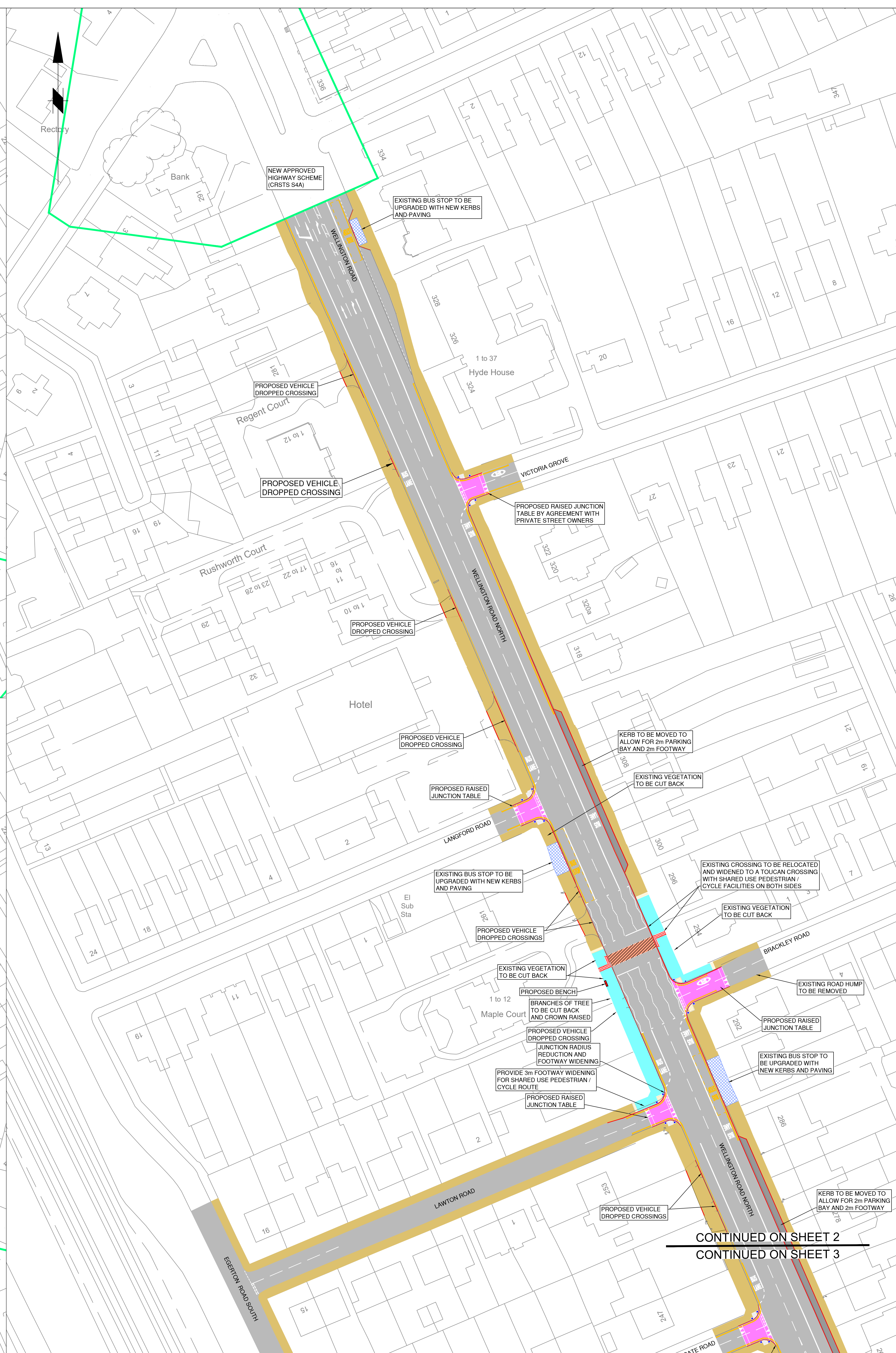

SHEET 2 (VIEWPORT 2B)

**FOR APPROVAL**

Rev.	Drawn	Checked	Date	Revision Details
1	DN	JG	21/02/24	Issue for approval
2	DN	JG	21/02/24	Issue for approval
3	DN	JG	21/02/24	Issue for approval

AMENDMENTS

**STOCKPORT**  
METROPOLITAN BOROUGH COUNCIL  
ROADS AND TRANSPORTATION  
STOCKPORT 241 202

Job Title			
A6 CORRIDOR (IN STOCKPORT)			
IMPROVING JOURNEYS			
Drawing Title			
A6 BUS ROUTE			
GENERAL ARRANGEMENT			
SHEET 2 OF 15			
Drawn	Engineer	Checked	Approved
DN	DN	JG	NDW
Date	Date	Date	Date
21/02/24	21/02/24	21/02/24	21/02/24
Size	Scale		
A0	1:500		
Drawing No.			
F-5223-A6BR-CON-0002			
Revision			
C			