

This map is reproduced from Ordnance Survey material with the permission of Ordnance Survey on behalf of the Controller of Her Majesty's Stationery Office. © Crown copyright. Unauthorised reproduction infringes Crown copyright and may lead to prosecution or civil proceedings. Stockport Metropolitan Borough Council A00000804784 2024

- KEY - GENERAL:**
- PROPOSED CARRIAGEWAY
 - EXISTING OR PROPOSED HARD STANDING
 - PEDESTRIAN SIGNALISED CROSSING
 - PEDESTRIAN & CYCLE TOUCAN CROSSING
 - PROPOSED TRAFFIC CALMING FEATURE
 - PROPOSED KERBS
 - PROPOSED EDGINGS
 - PROPOSED FOOTWAY
 - PROPOSED SHARED FOOTWAY / CYCLEWAY
 - PROPOSED SEGREGATED FACILITY
 - PROPOSED WHITE ROAD MARKINGS
 - PROPOSED YELLOW ROAD MARKINGS
 - PROPOSED RED TACTILE PAVING (CONTROLLED CROSSING)
 - PROPOSED BUFF TACTILE PAVING (UNCONTROLLED CROSSING)
 - EXISTING BUFF TACTILE PAVING (UNCONTROLLED CROSSING)
 - PROPOSED CYCLE CORDUROU PAVING (SHARED USE BOUNDARY)
 - PROPOSED BUS STOP PAVING
 - PROPOSED BOLLARD
 - PROPOSED BENCH
 - PROPOSED TREE
 - VERGE

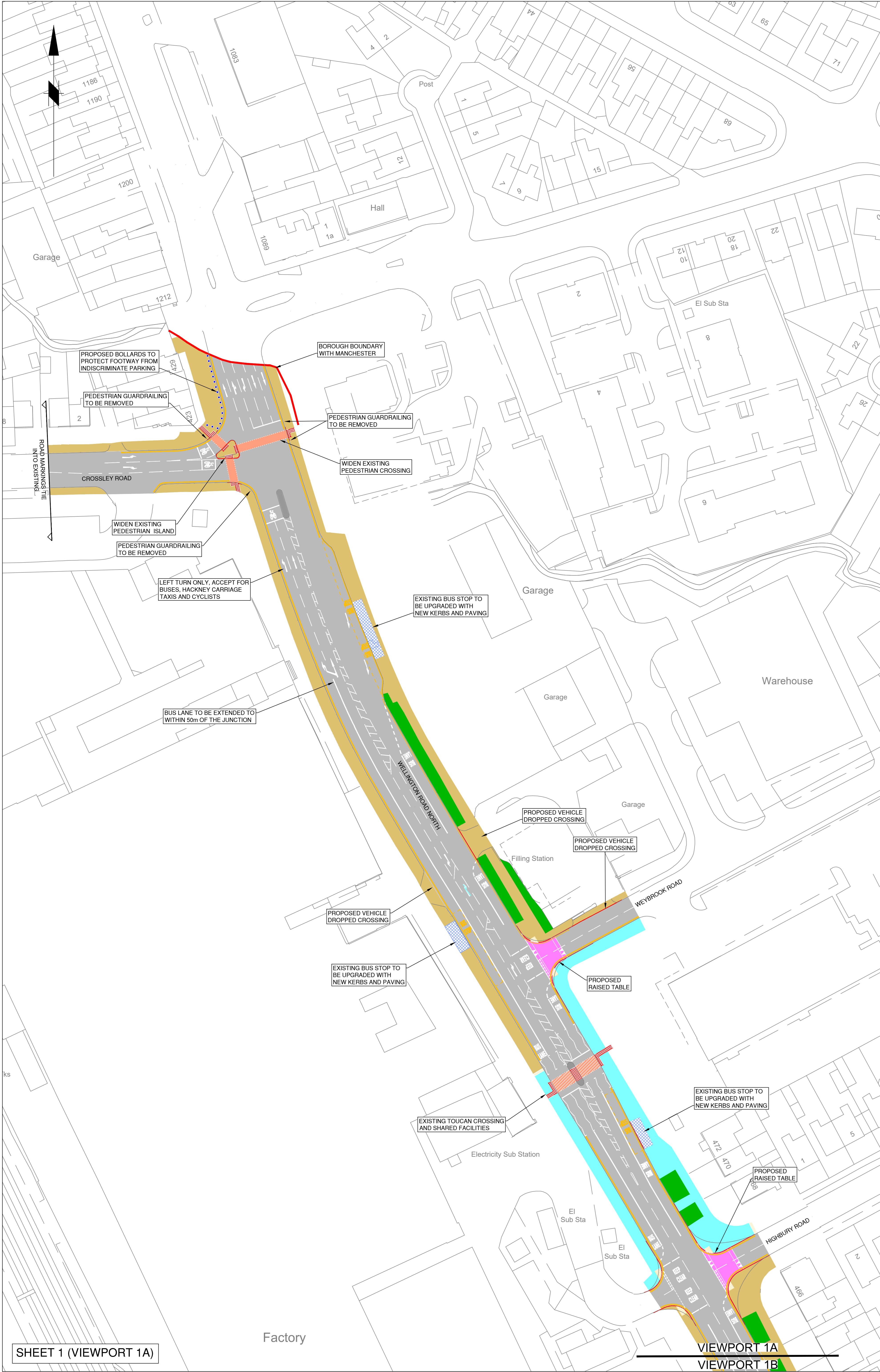

SHEET 1 (VIEWPORT 1A)

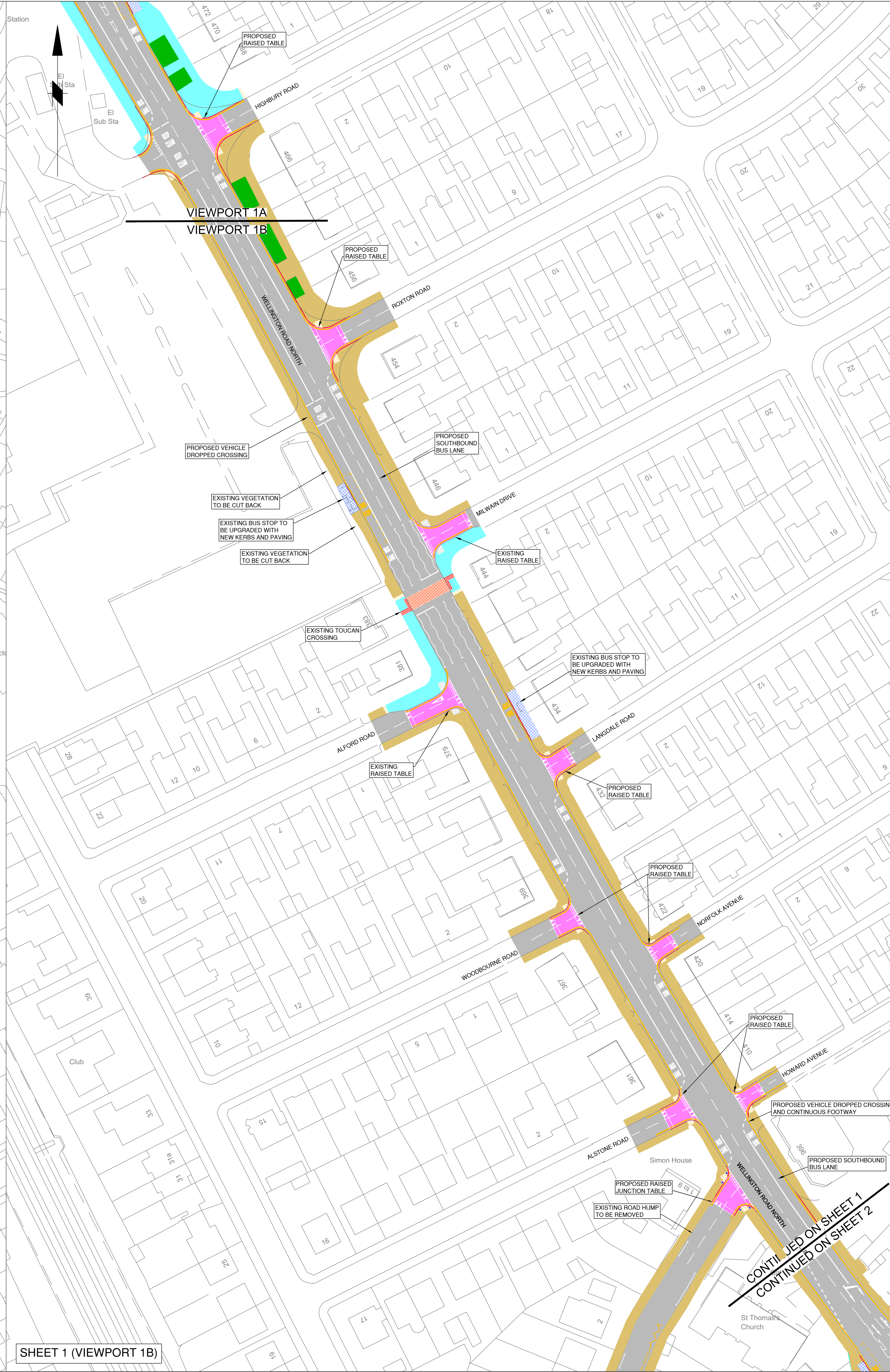

SHEET 1 (VIEWPORT 1B)

FOR APPROVAL

Rev.	Drawn	Checked	Date	Revision Details
1	DN	JG	21/02/24	Key updated
2	DN	JG	21/02/24	Minor changes to layout
3	DN	JG	21/02/24	Changes to design submitted for consultation

AMENDMENTS

STOCKPORT
METROPOLITAN BOROUGH COUNCIL
ROADS AND TRANSPORTATION
STOCKPORT 341 202
Tel: 0161 475 4100

Job Title: **A6 CORRIDOR (IN STOCKPORT) IMPROVING JOURNEYS**

Drawing Title: **A6 BUS ROUTE GENERAL ARRANGEMENT SHEET 1 OF 15**

Drawn	Engineer	Checked	Approved
DN	DN	JG	NDW
Date: 21/02/24	Date: 21/02/24	Date: 21/02/24	Date: 21/02/24
Size: A0	Scale: 1:500		

Drawing No. **F-5223-A6BR-CO-001** Revision: **C**

CONTINUED ON SHEET 1
CONTINUED ON SHEET 2