

This map is reproduced from Ordnance Survey material with the permission of Ordnance Survey on behalf of the Controller of Her Majesty's Stationery Office © Crown copyright. Unauthorised reproduction infringes Crown copyright and may lead to prosecution or civil proceedings. Stockport Metropolitan Borough Council 100019571 2023

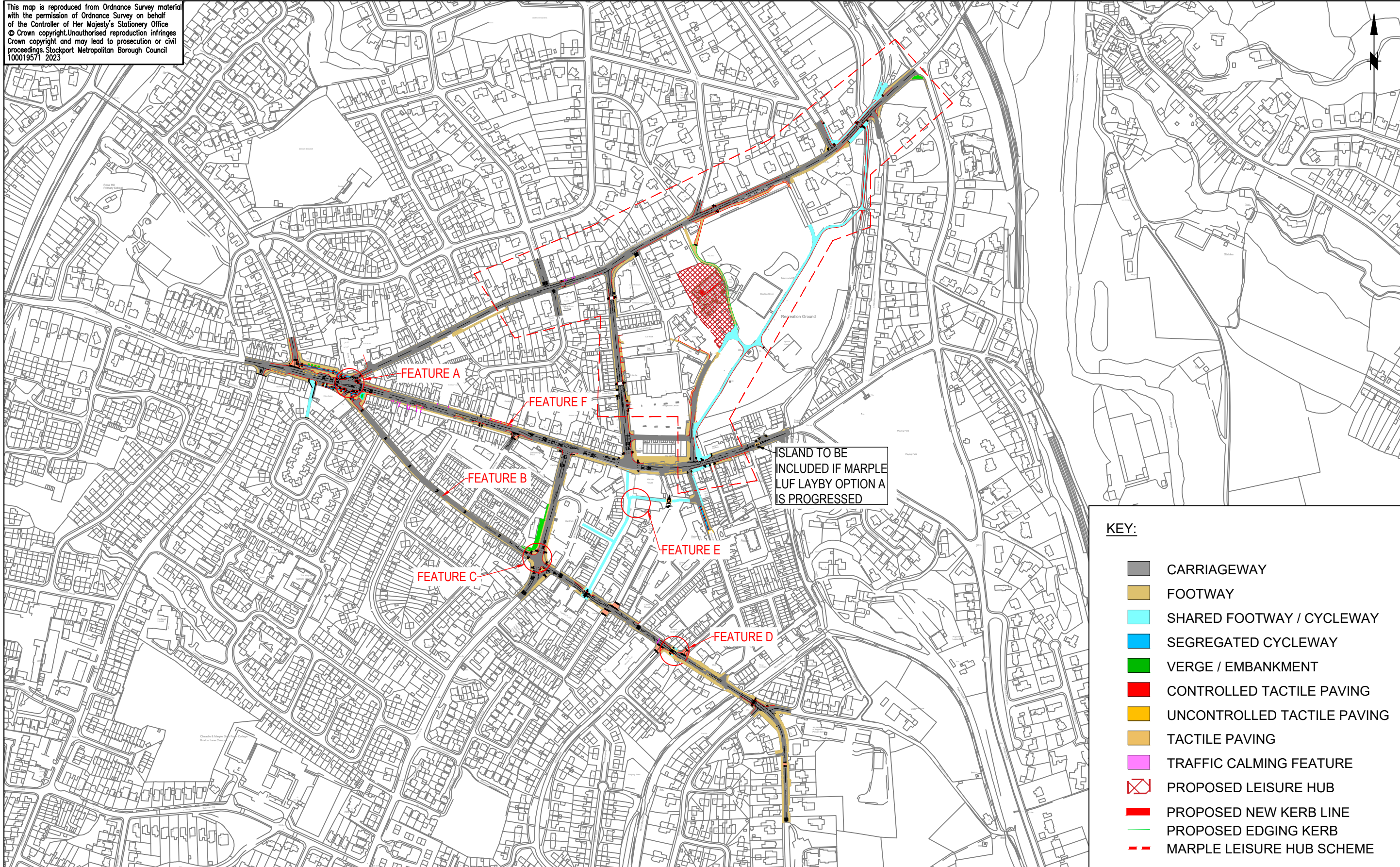

KEY:

- CARRIAGEWAY
- FOOTWAY
- SHARED FOOTWAY / CYCLEWAY
- SEGREGATED CYCLEWAY
- VERGE / EMBANKMENT
- CONTROLLED TACTILE PAVING
- UNCONTROLLED TACTILE PAVING
- TACTILE PAVING
- TRAFFIC CALMING FEATURE
- PROPOSED LEISURE HUB
- PROPOSED NEW KERB LINE
- PROPOSED EDGING KERB
- MARPLE LEISURE HUB SCHEME



STOCKPORT
 METROPOLITAN BOROUGH COUNCIL
 HIGHWAYS AND TRANSPORTATION
 STOPFORD HOUSE
 STOCKPORT SK1 3XE

MARK GLYNN
 DIRECTOR OF PLACE MANAGEMENT

AMENDMENTS

DRAWN	CHECKED	DATE	No	AMENDMENT

JOB TITLE

MARPLE ACTIVE COMMUNITY HUB

DRAWING TITLE

MARPLE LEISURE HUB & MACAWS OVERVIEW

Drawn RPO	Engineer CAS	Checked CAS	Approved NW
Date 11/08/23	Date 18/08/23	Date 18/08/23	Date 18/08/23
Scale N.T.S			
Drawing No. F / 5194 / D / 002			Revision