

This map is reproduced from Ordnance Survey material with the permission of Ordnance Survey on behalf of the Controller of Her Majesty's Stationery Office. © Crown copyright. Unauthorised reproduction infringes Crown copyright and may lead to prosecution or civil proceedings. Stockport Metropolitan Borough Council 100019571 2020

KEY

- - - ROMILEY TO STOCKPORT CYCLE ROUTE PHASE 1 (SCHEME XY)
- NEW SIGNAL CROSSING
- UPGRADED SIGNAL CROSSING
- ROAD CLOSED TO VEHICLES
- ROAD CLOSED TO NORTHBOUND VEHICLES (COMPSALL ROAD TO CENTRAL DRIVE)
- - - EXISTING 20MPH SPEED LIMIT
- - - PROPOSED 20MPH SPEED LIMIT (SCHEME E)
- A SCHEME REFERENCE

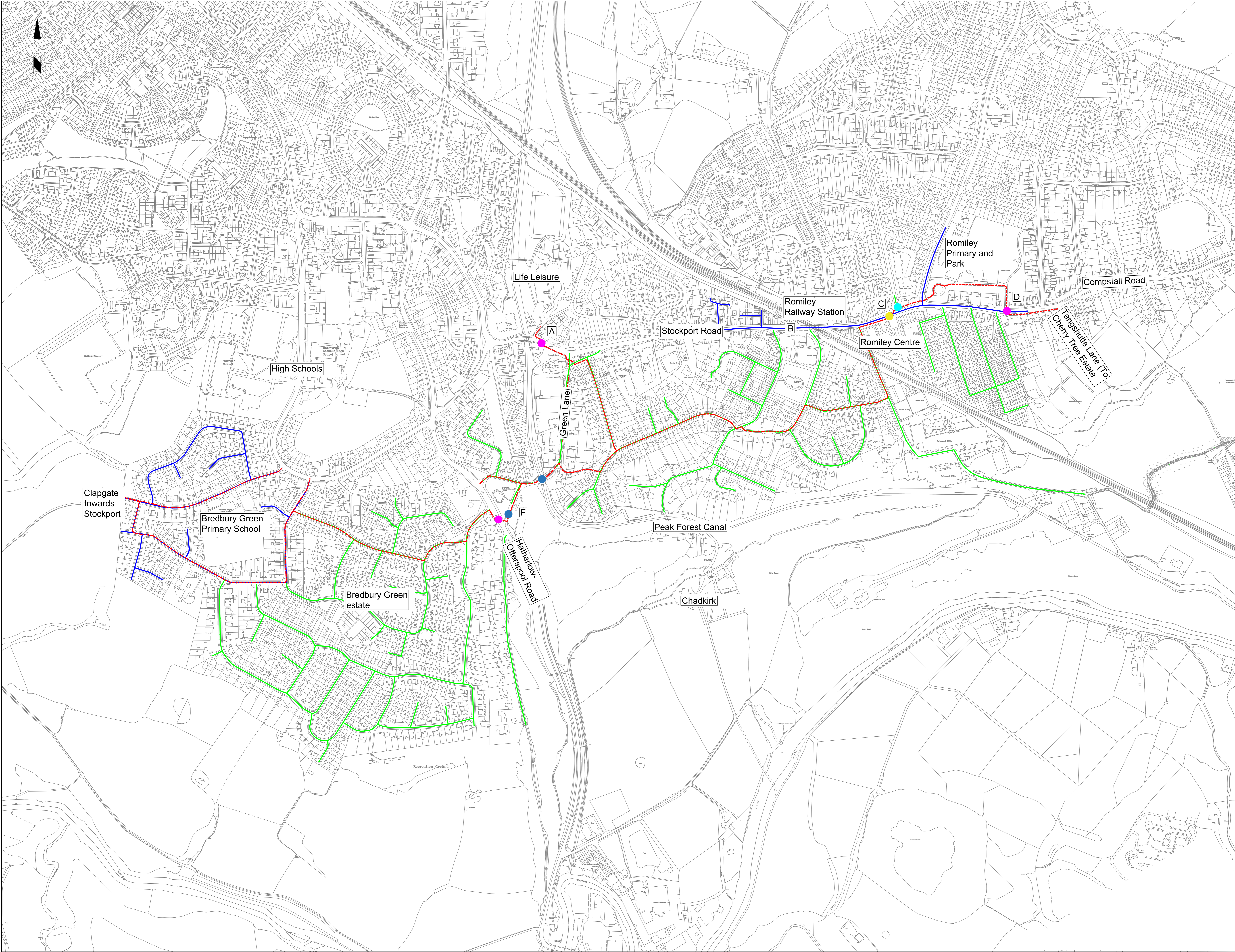

FOR FEASIBILITY

Rev.	Drawn	Checked	Date	Revision Details

AMENDMENTS

STOCKPORT
METROPOLITAN BOROUGH COUNCIL

ROADWAYS AND TRANSPORTATION SERVICES DIVISION
STOCKPORT S&A 202
Tel: 0161 434 4444

Job Title

**ATF 4
ROMILEY CYCLE LINKS**

Drawing Title

**OVERVIEW PLAN
SHEET 1**

Drawn	Engineer	Checked	Approved
Date	Date	Date	Date
RM	RM		
17/07/24	17/07/24		
AD	Scale	1:500	

Drawing No. Revision