

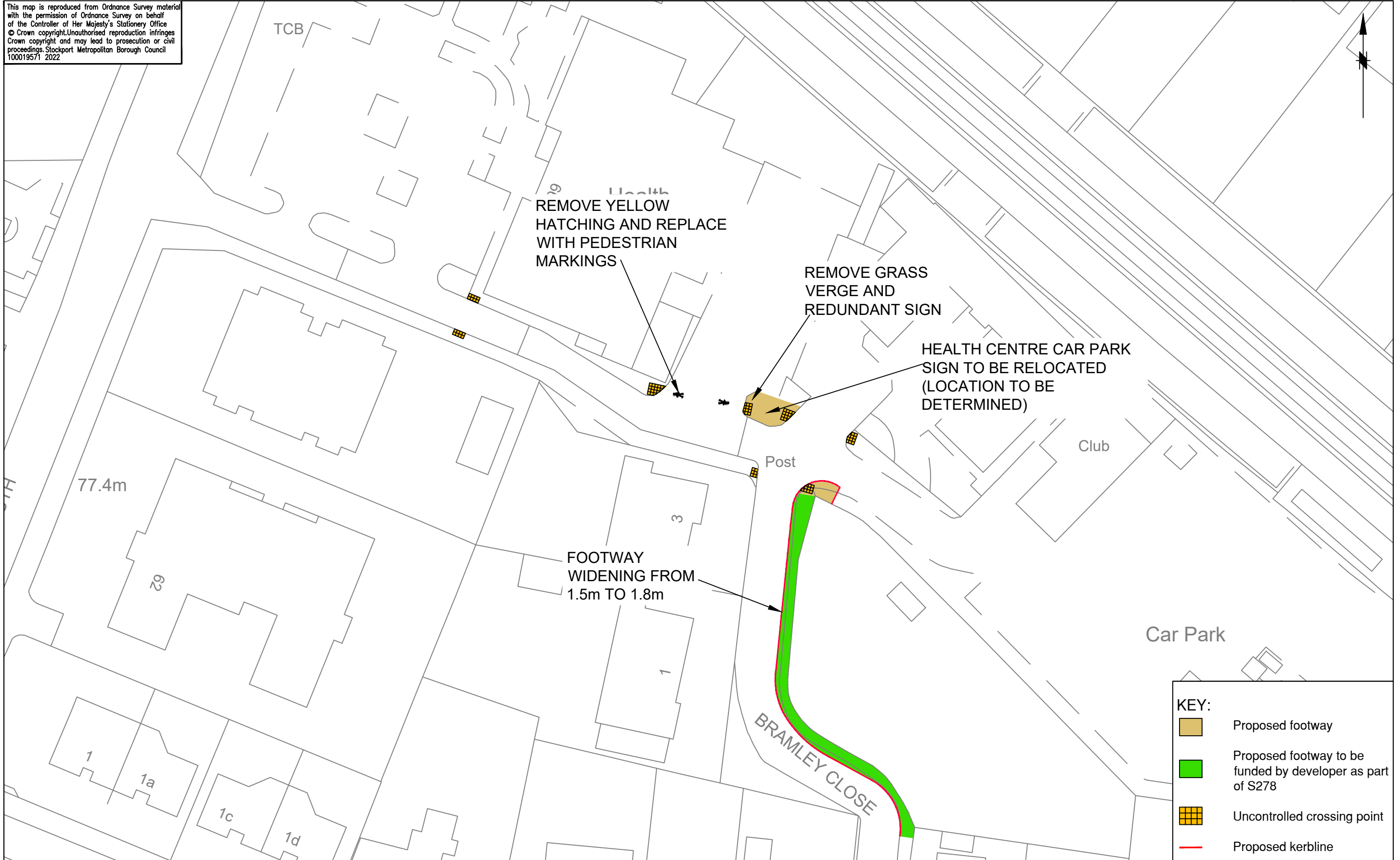

This map is reproduced from Ordnance Survey material with the permission of Ordnance Survey on behalf of the Controller of Her Majesty's Stationery Office © Crown copyright. Unauthorised reproduction infringes Crown copyright and may lead to prosecution or civil proceedings. Stockport Metropolitan Borough Council 100019571 2022



**KEY:**

- Proposed footway
- Proposed footway to be funded by developer as part of S278
- Uncontrolled crossing point
- Proposed kerbline



**STOCKPORT**  
METROPOLITAN BOROUGH COUNCIL  
HIGHWAYS AND TRANSPORTATION  
STOPFORD HOUSE  
STOCKPORT SK1 3XE  
Tel : 0161 474

MARK GLYNN  
DIRECTOR OF PLACE MANAGEMENT

AMENDMENTS				
DRAWN	CHECKED	DATE	No	AMENDMENT

**JOB TITLE**  
BRAMLEY CLOSE, BRAMHALL

**DRAWING TITLE**  
FOOTWAY DETAILS - OPTION 2

Drawn RPO	Engineer NR	Checked NR	Approved EPS
Date 02/04/24	Date	Date	Date
Scale 1:250			
Drawing No. NM1 / BRAMLEY CLOSE / 02			Revision