

This map is reproduced from Ordnance Survey material with the permission of Ordnance Survey on behalf of the Controller of Her Majesty's Stationery Office © Crown copyright. Unauthorised reproduction infringes Crown copyright and may lead to prosecution or civil proceedings. Stockport Metropolitan Borough Council AC0000804794 2024

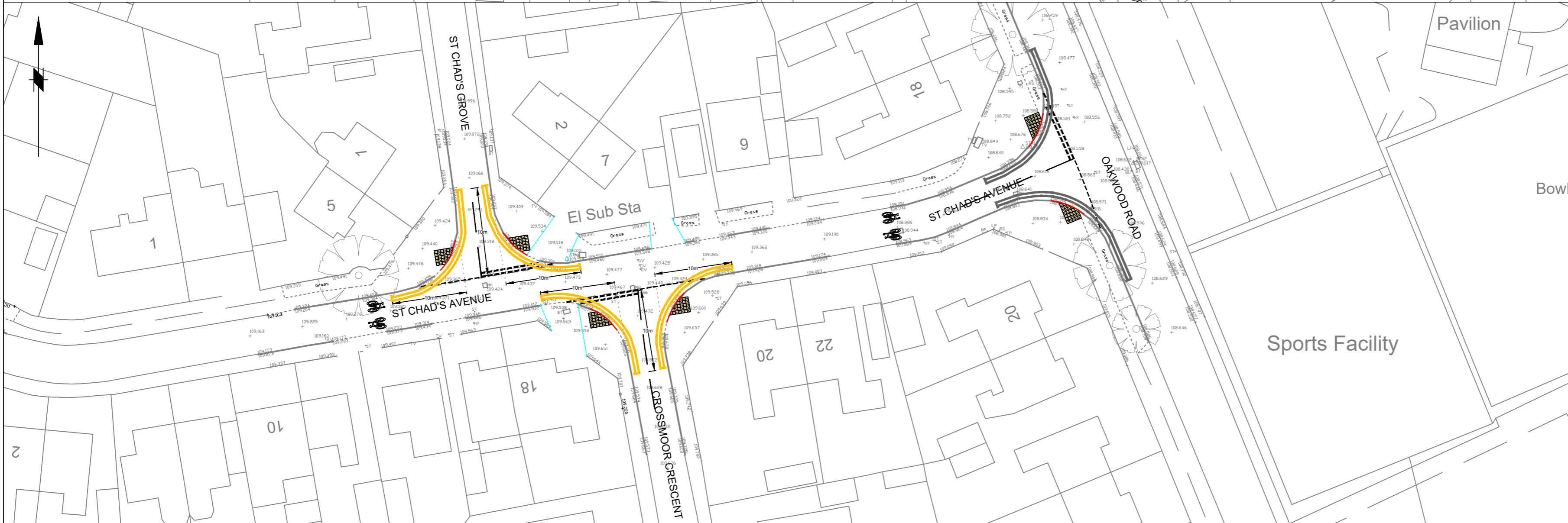

KEY - XY

'No Waiting at Any Time' restrictions

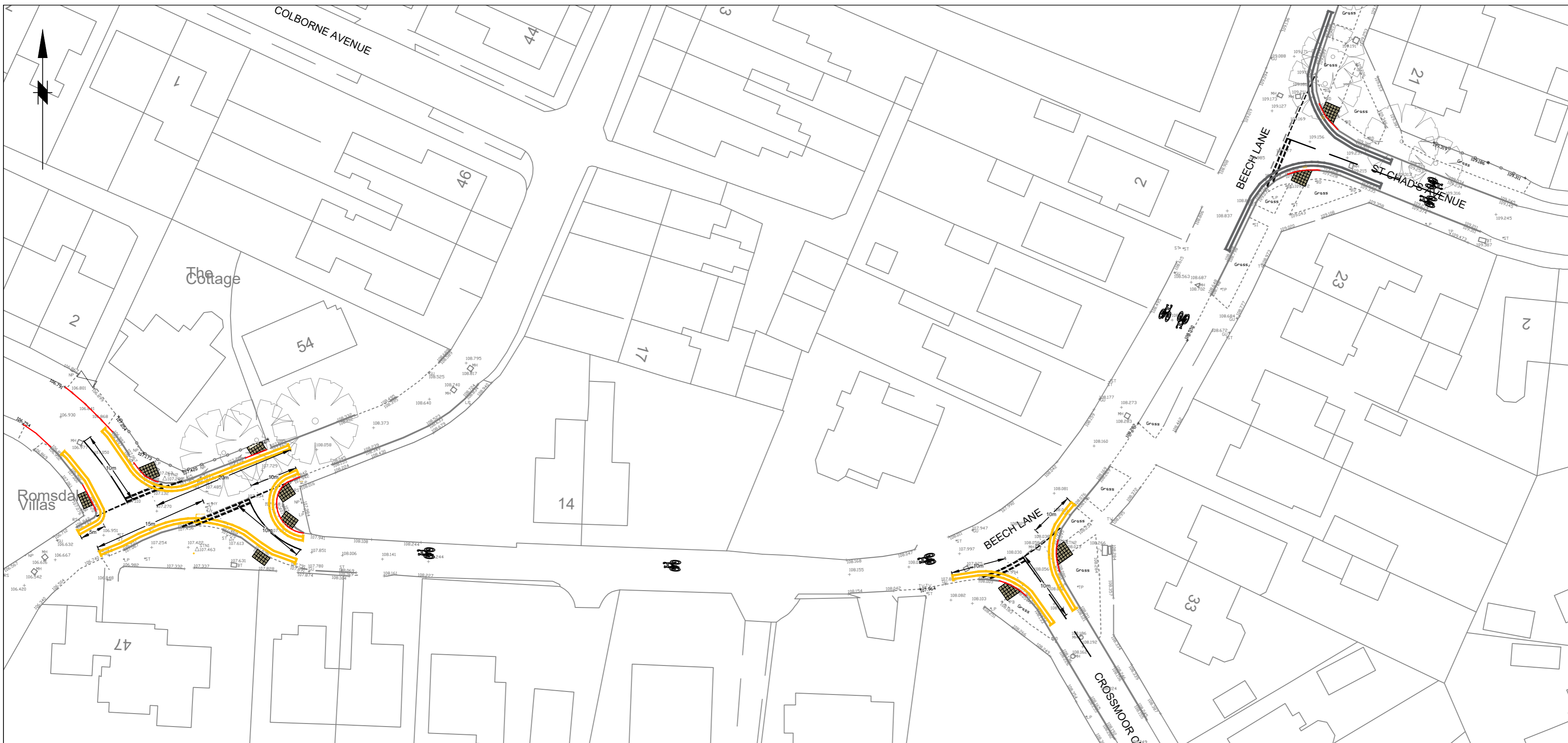

Existing 'No Waiting at Any Time' restrictions



New/ Re-aligned kerb line



New dropped kerb crossing & tactile paving

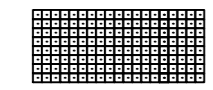

Cycle symbol road markings



Note: Other existing restrictions in the area are not shown on the drawing for clarity. These remain operative and enforceable.

| Rev. | Drawn | Checked | Date | Revision Details |
|------------|-------|---------|------|------------------|
| AMENDMENTS | | | | |

STOCKPORT
 METROPOLITAN BOROUGH COUNCIL
HIGHWAYS AND TRANSPORTATION STOCKPORT HOUSE STOCKPORT SK1 3TT TEL

Job Title

**ATF4
ROMILEY**

Drawing Title

**TRAFFIC
REGULATION
ORDERS - Scheme XY - 5 of 5**

| | | | |
|------------------------------|--------------------|--------------------|--------------------|
| Drawn NN | Engineer NN | Checked AP | Approved EPS |
| Date 06/02/2024 | Date 06/02/2024 | Date 06/02/2024 | Date 06/02/2024 |
| Size A2 | Scale NTS | | |
| Drawing No. O284TRO_XY_05 | | | Revision - |