

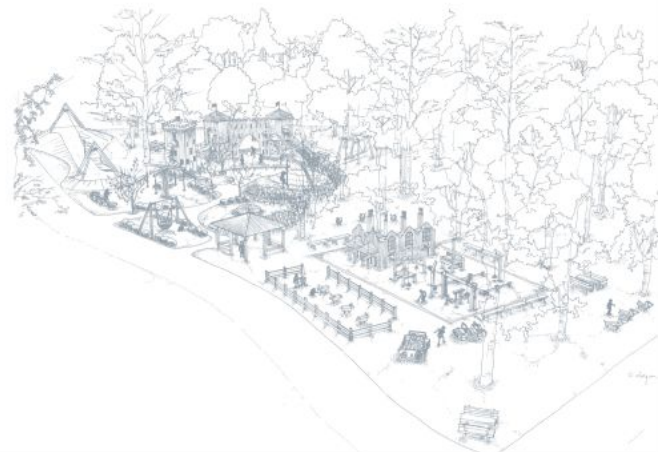

timberplay



Timberplay Stockport Temporary Play Provision



Introduction

Castle Street 'On The Way Play SK'

Timberplay x Civic and Social

This report details the recommended play equipment interventions to realise the planned pilot to transform Castle Street into a temporary destination for play and dwell.

It includes chosen Richter Spielgeräte equipment, which will be adapted to ensure its movability.

It also includes conceptual visualisations of how these pieces could look alongside temporary art installations in development as part of the wider 'On The way Play' project aims.



Context

Castle Street

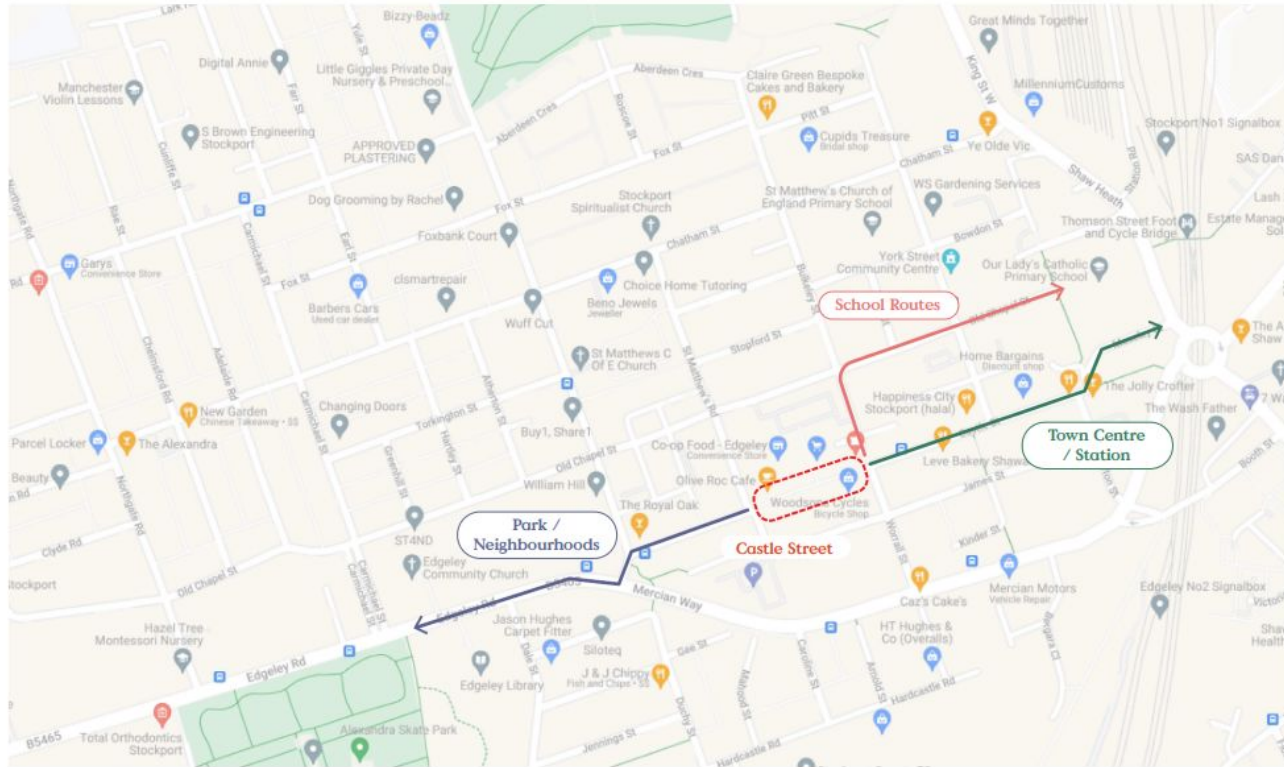

- Ground plan, scale 1:250
- ↗ ↘ Falling space according to EN standard

Timberplay Ltd · Aizlewoods Mill · Nursery Street · Sheffield S3 8GG · T 0114 282 3474 · www.timberplay.com

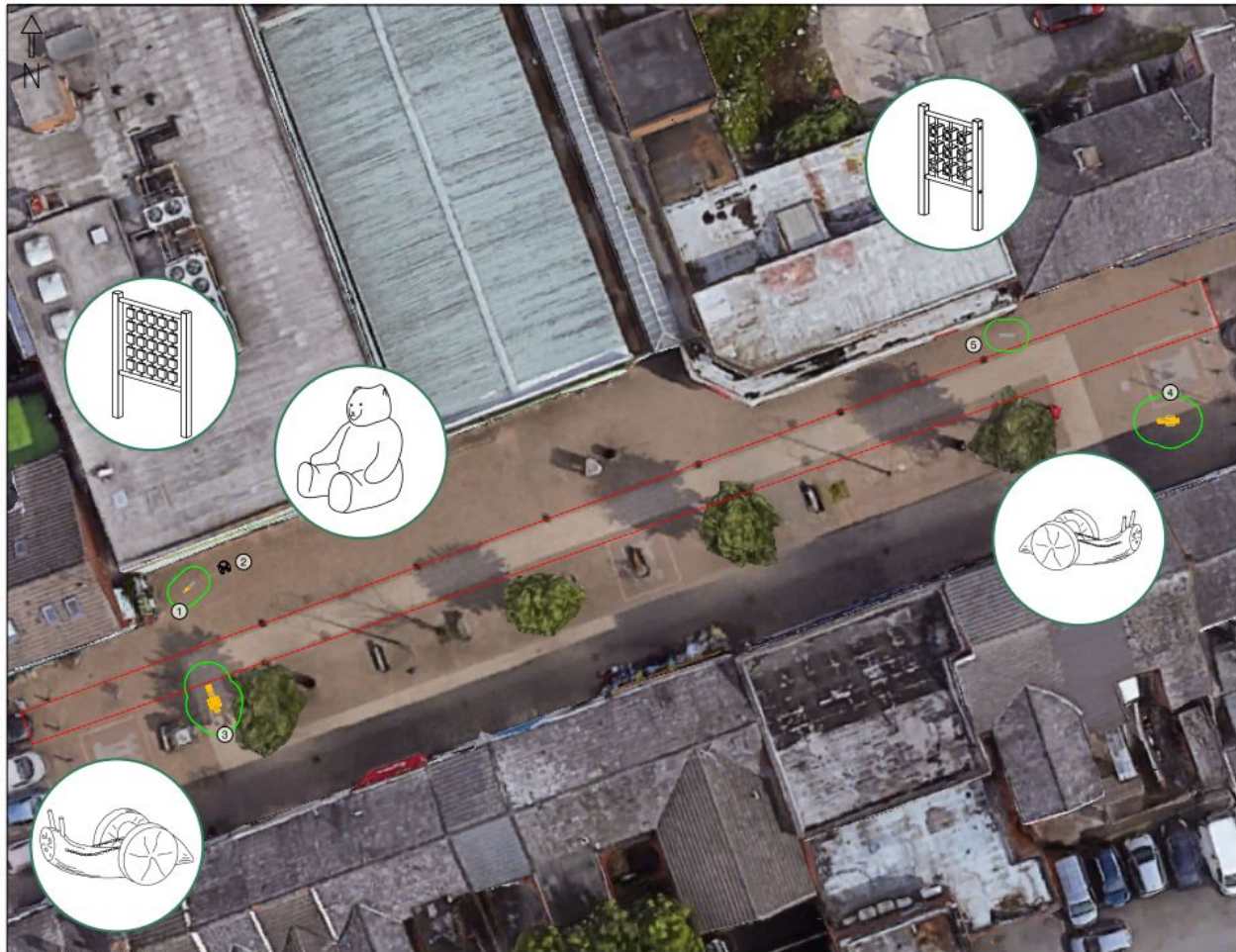

Legend:

Play Equipment

- ① 9.15200 Pairs (base plate fixed)
- ② 4.69070 Stroking Stone: Bear, grey
- ③ 4.24230 Snail
- ④ 4.24235 Little Snail
- ⑤ 9.15300 Tic Tac Toe (base plate fixed)

Access Route – Clearway, kept free of equipment

Rev	Description	Date

Do not scale from this drawing



Project: Stockport Temporary Play
Castle Street
Play Proposals

Drawing title: Stockport Temporary Play
General Arrangement Plan

Scale:	1:250@A3	Date:	06-11-23	Drawn:	EB
Creation Number:	TIMQ	Checked:	MG		

© All rights to the design and equipment belong to Timberplay Ltd, and other intellectual property. This drawing is the property of Timberplay Ltd. Copyright is reserved by them and the drawing is issued on the condition that it is not copied, reproduced, modified or disclosed to any unauthorized person other than in a part without the consent of Timberplay.

Important note for customers!
The contractor has to check on site if all conditions (required space existing space etc.) for the installation of the equipment are ensured, also supply pipes (in ground or overhead cables) and other conditions have to be observed.

Recommendation for the installation of slides:
Do not install slides with sliding direction between southeast and southwest, because of heating up the material – If it is not possible, shading of the slide has to be ensured by suitable means.

Dimensions:
All dimensions are shown in centimetres unless otherwise stated.

Equipment

Selections



Equipment

- 1 9.15200 Pairs (base plate fixed)
- 2 4.69070 Stroking Stone: Bear, grey
- 3 4.24230 Snail
- 3 4.24235 Little Snail
- 5 9.15300 Tic Tac Toe (base plate fixed)

Equipment

Selections

Equipment Selection

9.15200 Pairs Game - facilitates social play and interactions. Can be utilised by all ages and encourages playful competition. Stainless Steel frame and moving elements, with Larch cubes with laser cut icons for matching.

4.69070 Stroking Stone: Bear, grey - friendly encounter for children. The bear can become a friendly symbol and playful encounter for children passing through they space, and used as seating. Very tactile in it's nature, the concrete Bear also provides a calm sensory experience. Crafted from polished concrete.

4.24230 Snail & **4.24235** Little Snail - friendly encounters for children. The timber animals can be interacted with - they can be ridden, sat on, 'fed', or 'raced'. They are also to symbolise the object of slowing people's journeys in a playful way - encouraging social connectedness, engagement and interactions. Crafted from solid Mountain Larch, which galvanised steel chain.

9.15300 Tic Tac Toe - facilitates social play and interactions. Can be utilised by all ages and encourages playful competition. Stainless Steel frame and moving elements, with Larch cubes with laser cut icons for play.

Please see accompanying documents with play equipment specifications

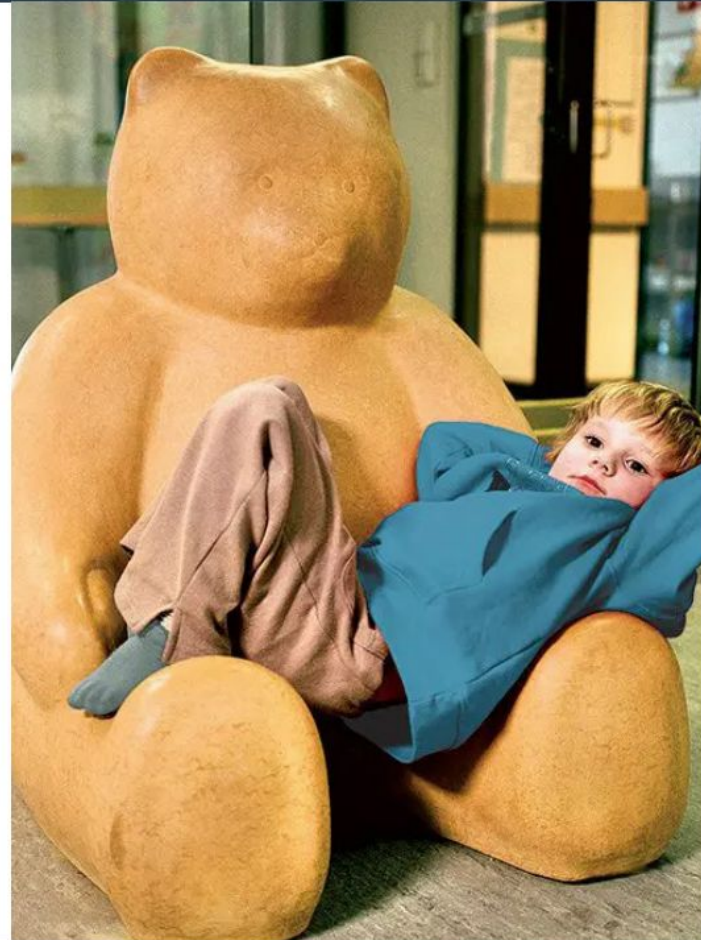

Visualisations

Play Equipment Location / Indicative Artwork



Visualisations

Play Equipment Location / Indicative Artwork





Visualisations

Play Equipment Location / Indicative Artwork



Installation

For Temporary Play Provision

Installation

Our standard installation documents are included separately. Normally, the elements are installed with concrete foundations following excavation.

In this situation, the Pairs Game and Tic-Tac-Toe will be provided with steel base plates which will be bolted to the existing paving using resin anchors.

The Snails will be anchored using angled brackets, fixed into the paving using resin anchors.

The Stroking Stone Bear weights almost 500kg and is designed to be stable enough for no foundation. This will be sited on flat ground and anchoring is not required.



Methodology

For Temporary Play Provision

Installation

Timberplay will provide detailed site specific Risk Assessments and Method Statements.

It is proposed that the play equipment will be unloaded outside of the pedestrianisation section of Castle Street, using Banksmen and suitable Traffic Control measures. The unload process will take less than 1 hour. The equipment will then be carried by hand or via pallet truck to their locations.

Each location will be installed one at a time, with the working area closed off from the public with Heras Fencing.

The play equipment is manufactured to meet EN1176* and is designed for unsupervised public settings.

The equipment has been selected for this situation due to their functionality, robustness and due to not requiring safety surfacing for impact protection.

The installation of the play equipment will be completed within 1 day.

Upon completion of the trial project, the equipment will be removed by breaking out the resin anchors and replacing any damaged paving sets to match those existing.

* The British and European Standard for playground equipment and surfacing is BS EN 1176.





Quality Criteria

Timberplay

Our Materials

Whilst Richter Spielgeräte do use a variety of materials in the manufacture of their play equipment, their material of choice is Timber. There are several reasons for this:

- It is tactile
- Not too hot in summer or too cold in winter
- Easy for children to understand the construction and imagine their own ideas for building
- Nice material to work with
- Natural material that changes with the seasons
- Easy to repair or alter
- Blends into a natural environment well, appeals to the senses
- Totally sustainable material – it comes from the ground and returns to the ground.
- Requires little processing as a construction material thereby minimising environmental damage through the manufacturing process

With the very strong environmental ethos behind Richter Spielgeräte, it is the latter two of these reasons that are the most important for them.



Quality Criteria

Timberplay

Mountain Larch

Mainly we use Mountain Larch [*Larix decidua*]. Mountain Larch has been successfully used for hundreds of years in the Alps to construct buildings that are designed to weather well. An important reason for Larch wood being particularly suited to use as play equipment, are the conditions in which it grows. Farmed for avalanche protection, it grows high up in the Alps. At such high altitudes it grows very slowly (close year rings) and this allows the wood to develop its' natural resistance to a considerably higher degree, something that does not happen in valley regions. We use no chemical protection with Mountain Larch.

Once felled the timber supplier can provide EN 45011 PEFC certification to confirm that the stock comes from sustainable responsibly managed forestry.

To further enhance the lifespan of our equipment steel feet are used with the larch support posts to avoid contact with the ground. The end result is a natural untreated timber post that can simply be disposed of at the end of its useful life without the need of specialist recycling or incineration services. A natural and sustainable organic product that grows from the earth and can be returned back to the earth completing the lifecycle and protecting the planet and the future of the children that once will have played upon the equipment.



Quality Criteria

Timberplay

Timber Protection

Where possible we use timber that is naturally resistant to rot so that we don't need to use chemical impregnation or protection. Richter Spielgeräte aim to achieve this in 100% of timber that they use. This again is part of the environmental ethos and is designed to reduce the effect of chemical preservatives seeping into the environment. These preservatives are effective in that they are harmful to pests, but they are also harmful to man and to the environment.

Where we do have to use chemical impregnation, we use AQS which withstands washing out extraordinarily well and does not contain damaging heavy metals. It has been shown to protect wood more effectively than CCA (Copper, Chrome and Arsenic) and is less damaging to the environment.

Richter Spielgeräte have never used CCA as a preservative in their timbers due to the concerns of releasing arsenic into the environment. The method of fixings these salts in the wood is boiler-pressure impregnation which is the most technically advanced and effective method.



Our play equipment is manufactured in a small factory in Frasdorf, Bavaria. These workshops are staffed by skilled craftspeople who are paid properly for their work. Both Timberplay and Richter operate programmes that create jobs for apprentices and students. We aim to employ locally, and support our employees through career development.

RESPONSIBLE



Each component of our equipment can be repaired or replaced like for like. We keep replacement parts in a material bank, all made uniquely in our Frasdorf workshops. This includes everything from the ropes on our bridges to the tiny moving mechanical parts in our swings.

REPAIRABLE



'The 4 Rs'

RENEWABLE



As our name suggests, we love to work with timber. The majority of our equipment is made from mountain larch, which you can read more about on page XX. These trees are grown and felled as part of an avalanche management programme, with replanting occurring immediately. We aim to use materials which come from, and can be returned to, the ground.

Find out more here:
<https://vimeo.com/130724007>

REFLECTIVE



As a company, we understand that consumption and construction are meaningful contributors to the global climate crisis. We seek to examine ways in which we can reduce the need for repeat production, and reduce the environmental impact of the playgrounds that we do produce. Our sustainability journey is never complete.

Ethical Procurement

Timberplay is the exclusive UK distributor of Richter Spielgeräte GmbH. We have a responsibility to ensure that all components of our supply chain comply with international laws relating to: labour standards, workers' and human rights and rule of law.



We have established relationships with our suppliers, built over generations.



We maintain a close working relationship with our production team.



We work with international partners to uphold safe working environments on our overseas sites.