

This map is reproduced from Ordnance Survey material with the permission of Ordnance Survey on behalf of the Controller of Her Majesty's Stationery Office © Crown copyright. Unauthorised reproduction infringes Crown copyright and may lead to prosecution or civil proceedings. Stockport Metropolitan Borough Council 100019571 2023

Key



Proposed:
 Parking restriction
 Mon - Fri
 8am - 4pm, 1 hour,
 No return within 1 hour

Existing:
 (DYL) No Waiting 'At Any Time

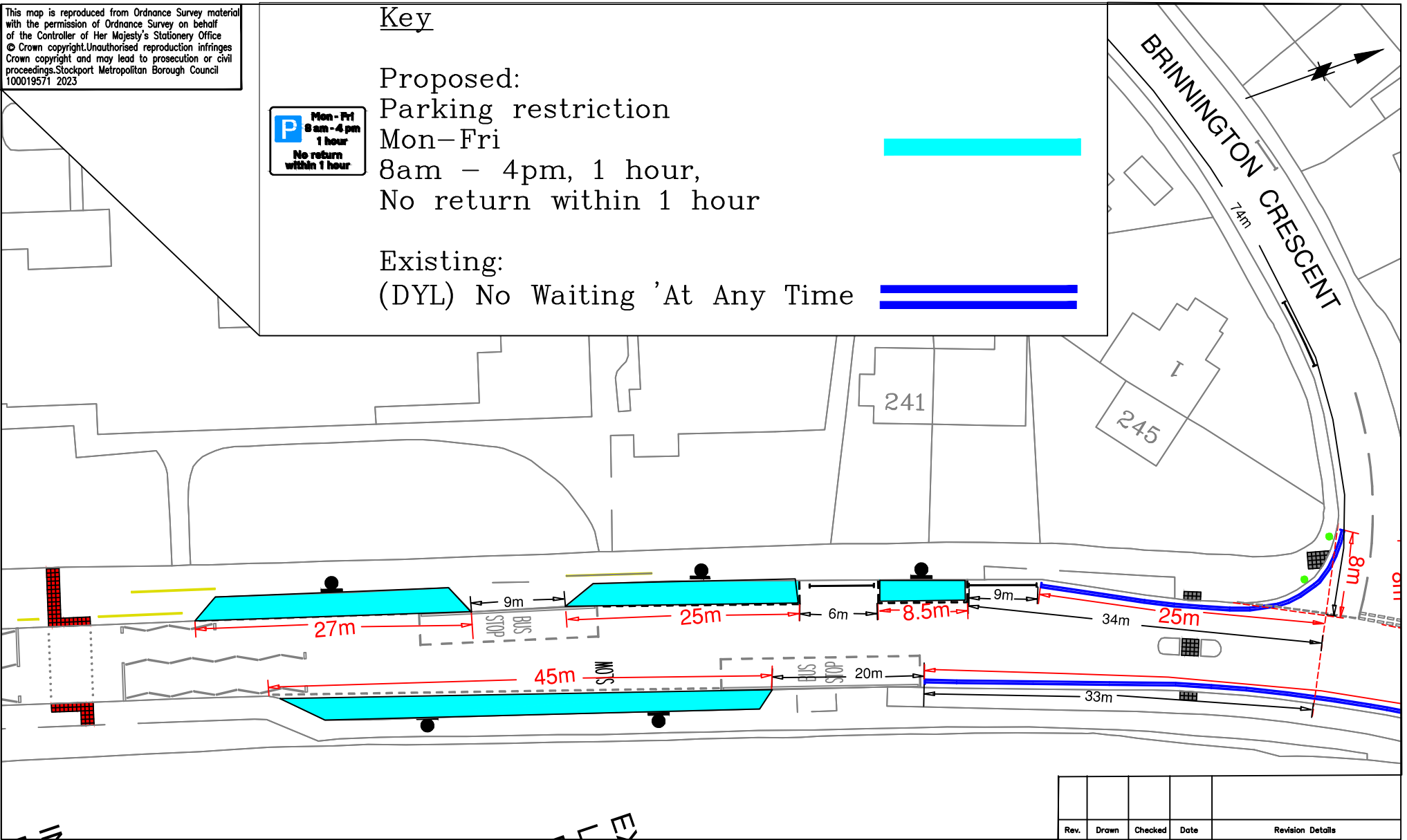

Rev.	Drawn	Checked	Date	Revision Details

SCGJOBNO.

JOB TITLE
 ROAD-SAFETY-AROUND-SCHOOLS

DRAWING TITLE
 ST.PAUL'S-COFE-PARKING-2



STOCKPORT
 METROPOLITAN BOROUGH COUNCIL

HIGHWAYS AND TRANSPORTATION
 STOPFORD HOUSE
 STOCKPORT SK1 3XE

MARK GLYNN
 DIRECTOR OF PLACE MANAGEMENT

Drawn	Engineer	Checked	Approved
GK	GK	CAS	AM
Date 29/07/23	Date 29/07/23	Date 29/07/23	Date 29/07/23
Scale	1:1000		
Drawing No.	0305/67/SP/03.2		
Revision	A		