

This map is reproduced from Ordnance Survey material with the permission of Ordnance Survey on behalf of the Controller of Her Majesty's Stationery Office © Crown copyright. Unauthorised reproduction infringes Crown copyright and may lead to prosecution or civil proceedings. Stockport Metropolitan Borough Council 100019571 2023

- KEY:**
- PROPOSED NWAAT
  - - - PROPOSED NWAAT EXCEPT TAXIS (SPM-MIDNIGHT)
  - - - PROPOSED DISABLE AND LOADING ONLY BAY
  - - - PROPOSED TAXI RANK

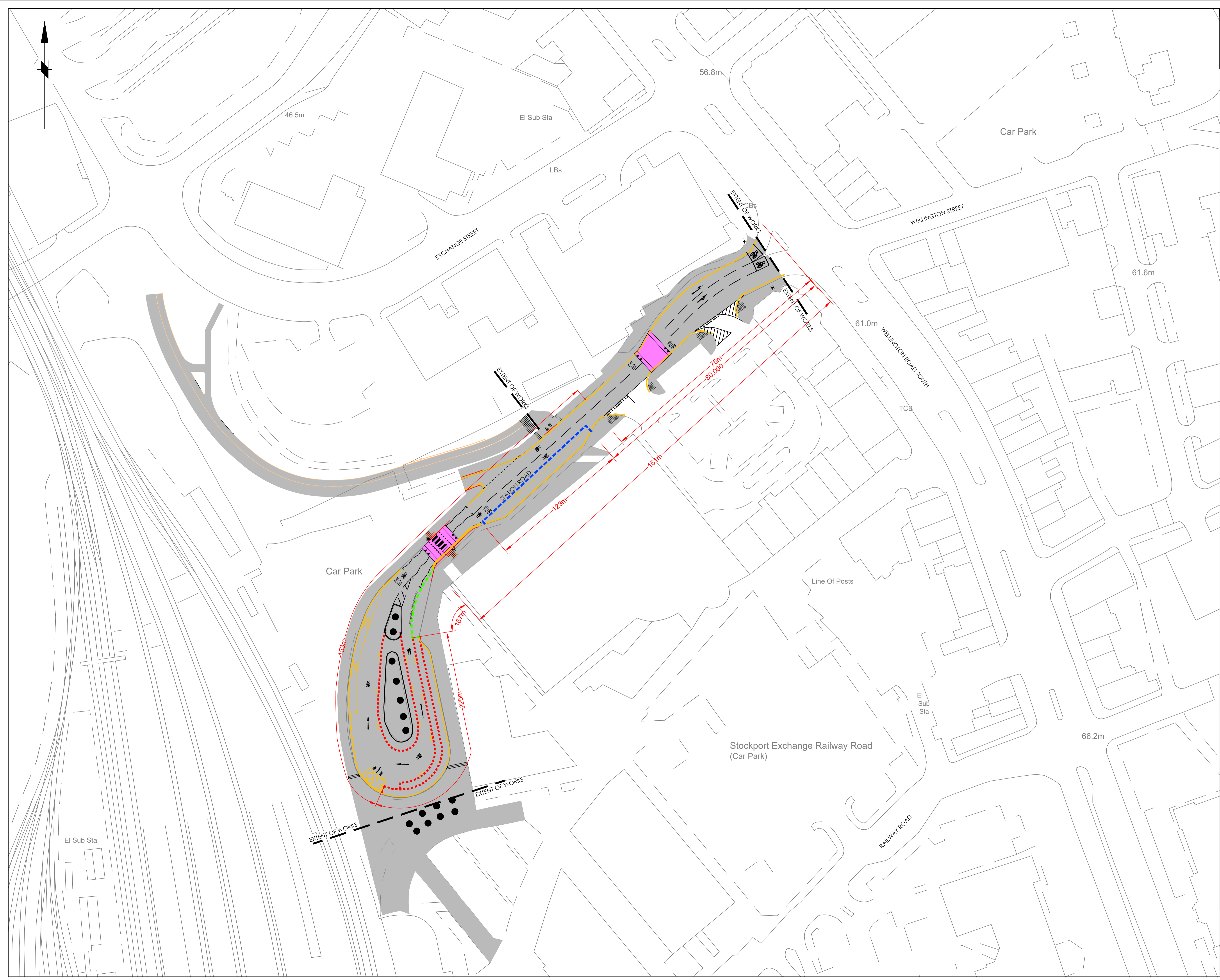

Rev.	Drawn	Checked	Date	Revision Details
AMENDMENTS				

**STOCKPORT**  
METROPOLITAN BOROUGH COUNCIL  
HIGHWAYS AND TRANSPORTATION  
STOCKPORT HOUSE  
STOCKPORT SK1 3SE  
TEL: 0161 474

MARK GLYNN  
DEPUTY CHIEF EXECUTIVE  
Job Title

**STOCKPORT INTERCHANGE - STATION ROAD**

Drawing Title

**PROPOSED TROS  
SHEET 1 OF 2**

Drawn	Engineer	Checked	Approved
RPO	PH	PH	NW
Date	Date	Date	Date
17/11/23			
Size	Scale		
A1	1:500		
Drawing No.	D_0279B_1200_TRO_01		Revision