

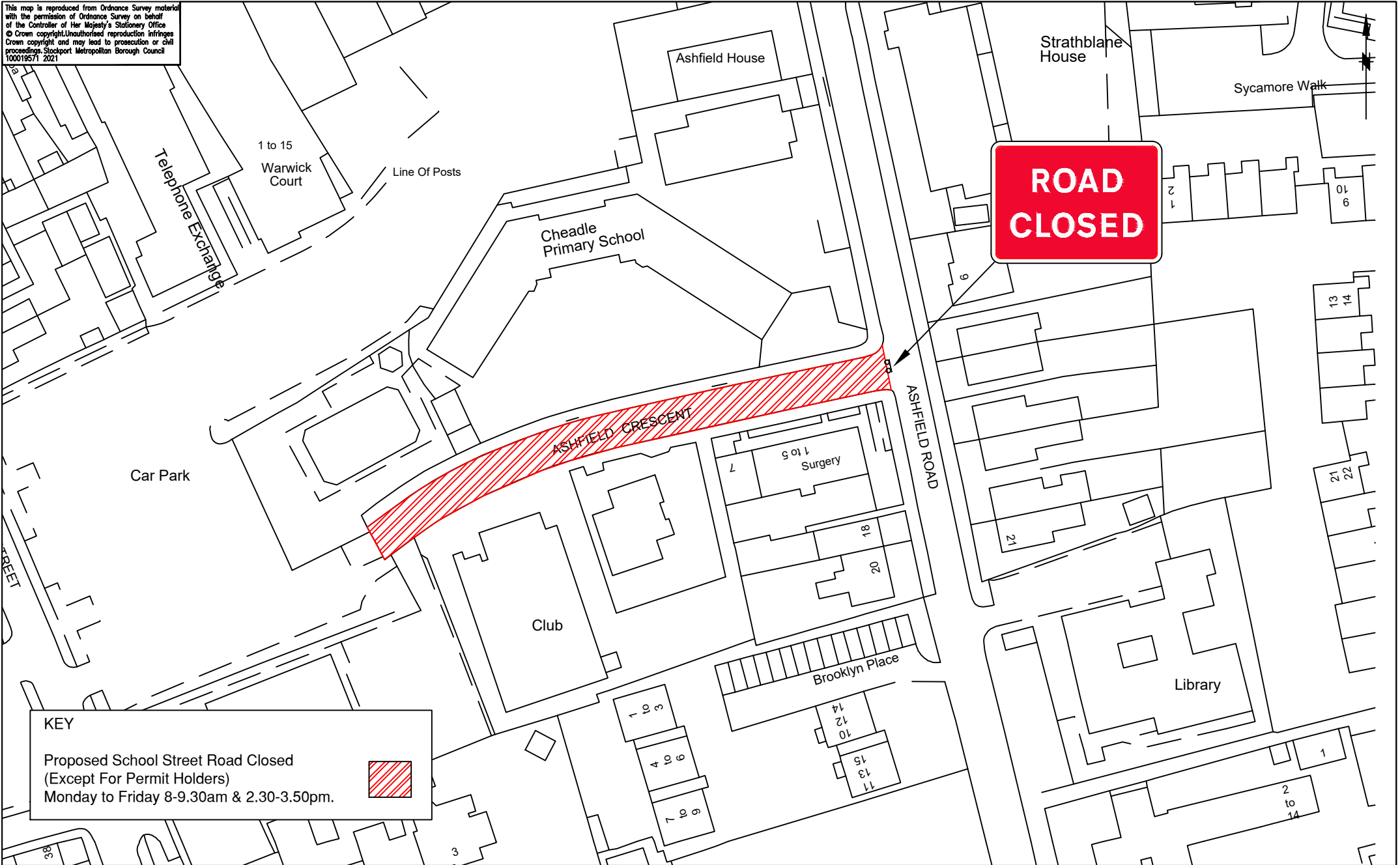

This map is reproduced from Ordnance Survey material with the permission of Ordnance Survey on behalf of the Controller of Her Majesty's Stationery Office  
 © Crown copyright. Unauthorised reproduction infringes Crown copyright and may lead to prosecution or civil proceedings. Stockport Metropolitan Borough Council 100019571 2021



**KEY**

Proposed School Street Road Closed  
 (Except For Permit Holders)  
 Monday to Friday 8-9.30am & 2.30-3.50pm.

**STOCKPORT**  
 METROPOLITAN BOROUGH COUNCIL

HIGHWAYS AND TRANSPORTATION  
 STOPFORD HOUSE  
 STOCKPORT SK1 3XE  
 Tel : 0161 474

CAROLINE SIMPSON  
 DEPUTY CHIEF EXECUTIVE

AMENDMENTS				
DRAWN	CHECKED	DATE	No	AMENDMENT
XX	XX	XX.XX.XX	A	XX

**JOB TITLE**  
 Cheadle Primary School, Cheadle

**DRAWING TITLE**  
 School Streets - Proposed Traffic Regulation Order 'Prohibition of Driving (Except for Permit Holders) when Temporary Road Signage is in place between 8am-9.30am & 2.30-3.50pm Monday to Friday.

Drawn	Engineer	Checked	Approved
SA	NR	EPS	EPS
Date 24/10/23	Date 24/10/23	Date 24/10/23	Date 24/10/23
Scale N.T.S			
Drawing No. NM8-5235-03			Revision