

**STOCKPORT COUNCIL**  
**EXECUTIVE REPORT – SUMMARY SHEET**

**Subject: School Streets ETRO**

**Report to: (a) Cabinet Member Sustainable Stockport**  
**31.05.2022**

**Date:**

**Report of: (b) Director for Place Management**

**Key Decision: (c) NO / (Please circle)**

Forward Plan  General Exception  Special Urgency  (Tick box)

**Summary:** To seek approval for the introduction of an Experimental Traffic Regulation Order (ETRO) between the hours of 8.00 to 9.30 and 14.30 to 15.50 Monday to Friday from 13th June 2022. To be active when signage is in place only. No closures will take place from the 28<sup>th</sup> of July when school summer breaks are in progress. For the sake of expediency and in agreement with the Ward Councillors, this report has been presented to the Cabinet Member only.

**Recommendation(s):**

The Cabinet Member for Sustainable Stockport approves introduction of Experimental Traffic Regulation Orders as shown in **Appendix 1**.

**Relevant Scrutiny Committee** (if decision called in): **(d)**

Communities & Housing Scrutiny Committee

**Background Papers** (if report for publication): **(e)**

There are none.

Contact person for accessing  
background papers and discussing the report

**Officer:** Eraina Smith / Emily Brough  
Tel: 07800 618224/07800816150

**'Urgent Business': (f) YES / NO (please circle)**

**Certification** (if applicable)

This report should be considered as 'urgent business' and the decision exempted from 'call-in' for the following reason(s):

The written consent of Councillor \_\_\_\_\_ and the Chief Executive/Monitoring Officer/Borough Treasurer for the decision to be treated as 'urgent business' was obtained on \_\_\_\_\_ /will be obtained before the decision is implemented.

**AGENDA ITEM**

# **School Streets Experimental Traffic Regulation Order**

## **Report of the Director for Place Management**

### **1. INTRODUCTION AND PURPOSE OF REPORT**

- 1.1 This report is to request approval of Experimental Traffic Regulation Orders (ETROs) as part of the School Streets Trial and request approval for legal advertise.
- 1.2 In 2021, Funding from the Government's Active Travel Fund (ATF) was allocated to TfGM to provide support for Local Authorities to deliver a series of 'School Streets' across the region to increase active and sustainable travel.
- 1.3 A school street is a road outside a school with a temporary restriction on motorised traffic at school drop-off and pick-up times. The restriction applies to all motor traffic, regardless of whether it is associated with the school itself, to create a street environment, which encourages cycling, scooting, or walking part or the entire school run.
- 1.4 In July 2021 Stockport Council submitted applications for funding to TfGM on behalf of the 8 schools who expressed interest in running a School Street at their school and £50k of funding was granted to be split between the 8 schools.
- 1.5 Proposals for consultation were developed in conjunction with the school and included a range of officer input. These identified potential roads needing to be closed and the times for the closures that would encourage more families to travel sustainably. Access to the roads by residents and essential care workers would be necessary and each car requires a permit. Alternative parking has also been identified for those parents/guardians who still need to drive.
- 1.6 The consultation ran between 7th and 28th March 2022. As a result of the consultation and subsequent discussion with local Councillors in the Heatons South Ward, the decision was made to remove St John's Primary School from the trial.
- 1.7 The decision to continue to deliver a trial for the remaining 7 schools was confirmed by the Cabinet Member for Economy and Regeneration. Appendix 2 provides the covering report for the consultation results.
- 1.8 As a result of the consultation and finalisation of details, ETROs are proposed for each of the schools involved in the School Streets trial as shown in Appendix 1.

### **2. INFORMATION AND ADVICE**

2.1. The proposals for the School Streets were discussed with the relevant ward Councillors and we reported back the result of the consultations in their areas and have their permission to approach the cabinet member to expedite the order to ensure the trail is operational before the end of the academic year.

2.2. Consultation will be undertaken in the trial period and post-trial period to reports to area committee and other interested parties the results of the experimental closure and related trial.

### **3. LEGAL POSITION/IMPLICATIONS**

3.1. The Traffic Management Orders would be made under Section 1 of the Road Traffic Regulation Act 1984. The Council is required by the Local Authorities Traffic Order (Procedure) (England and Wales) Regulations 1996 to give notice of its intention to make a Traffic Order (by publishing a draft traffic order). These regulations also require the Council to consider any representations received as a result of publishing the draft Order.

### **4. FINANCIAL IMPLICATIONS**

4.1. There are no financial implications arising from the recommendations in this report as proposals are being funded from Government's Active Travel Fund (ATF) via TfGM.

### **5. ALTERNATIVES CONSIDERED**

5.1. Alternatives were not were considered, however as this is a trail Council Officers will be in attendance ton the first few days and see if amendment / alteration are required for safety reasons.

### **6. RECOMMENDATIONS**

6.1. It is recommended that the Cabinet Member for Sustainable Stockport to approves the legal advertising and implementation of an Experimental Traffic Regulation Orders as shown in Appendix 1.

### **Background Papers**

There are no background papers to this report.

Anyone wishing further information please contact Rosie Batut email on [rosie.batut@stockport.gov.uk](mailto:rosie.batut@stockport.gov.uk)

**Proposed Experimental TROs:****Prohibition of Driving (Except for Permit Holders) When Temporary Road Signage is in Place between the hours of 8.00 to 9.30 and 14.30 to 15.50 Monday to Friday**

<b><u>Location</u></b>	<b><u>Extents</u></b>
Neston Grove, Stockport	At its junctions with Rotherne Road and Arnfield Road for its entire length.
Vernon Close, Cheadle Hulme Blossoms Hey, Cheadle Hulme	At its junction with Turves Road for its entire length. At its junction with Chedlee Drive for its entire length.
Ashfield Crescent, Cheadle Ash Street, Cheadle	At its junction with Ashfield Road for its entire length. For its entire length.
Old Chapel Street, Edgeley	At its junction with York Street in an easterly direction for its entire length.
Bulkeley Street, Edgeley Bowdon Street, Edgeley Lucy Street, Edgeley	Between its junctions with Chatham Street and Derby Street. Between its junctions with Bulkeley Street and York Street. Between its junctions with Bowdon Street and Old Chapel Street.
Fletcher Street, Stockport	From the junction with Wellington Street to a point 86 metres south-east of its junction with St Petersgate.
Tatton Street, Stockport Etchells Street, Stockport	At its junction with St Petersgate for its entire length. At its junction with St Petersgate for its entire length.
Broomfield Drive, Reddish Broomfield Close, Reddish Broom Avenue, Reddish	At its junction with Reddish Road for its entire length. For its entire length. For its entire length.

# Adswood Primary School

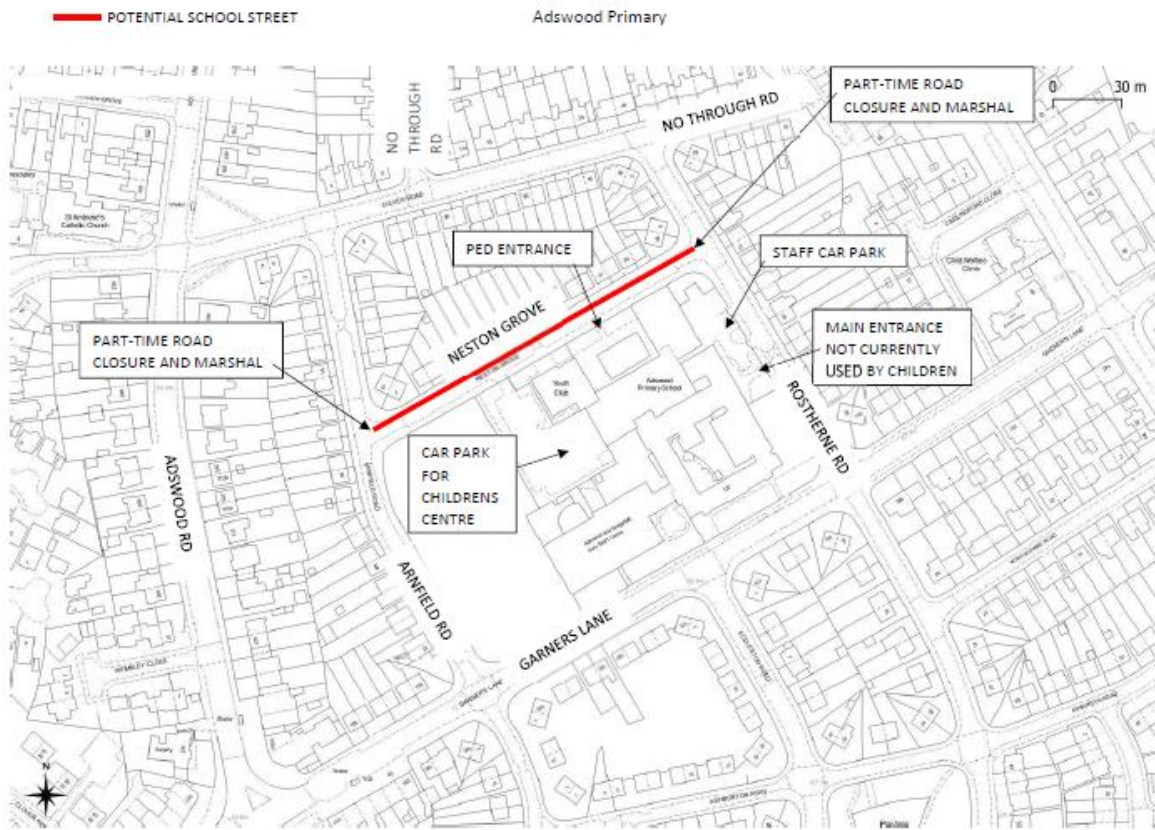

# Bradshaw Hall Primary School

School Street

Bradshaw Hall

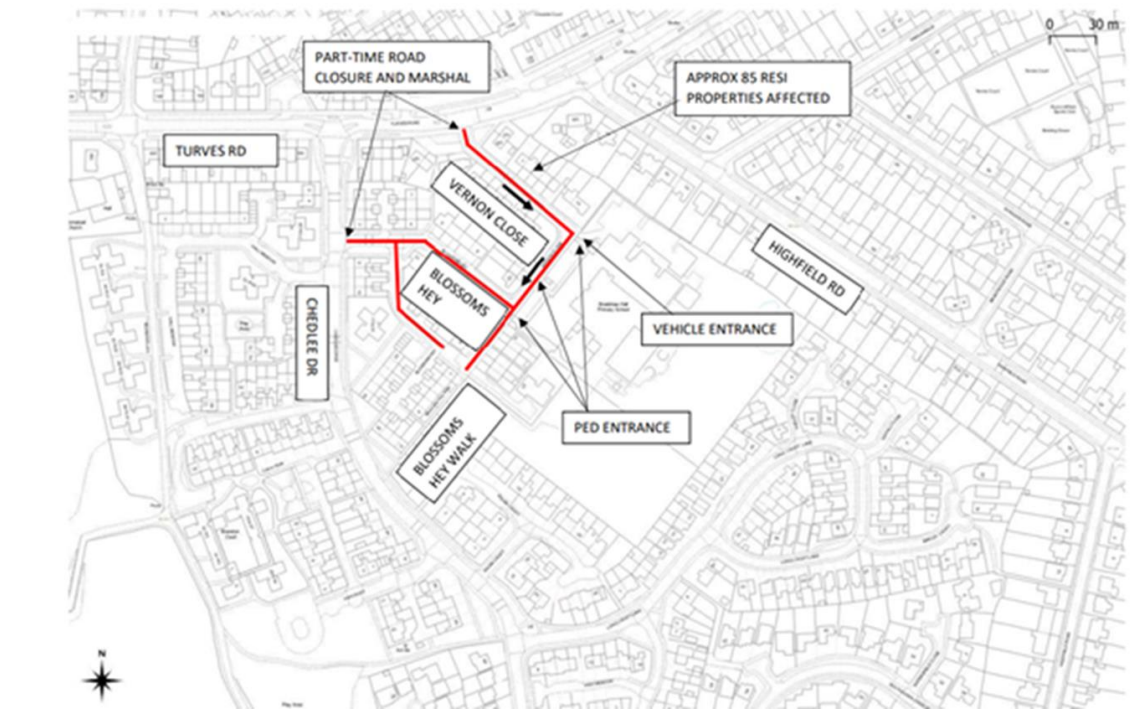

## Cheadle Primary School

— School Street

Cheadle Primary

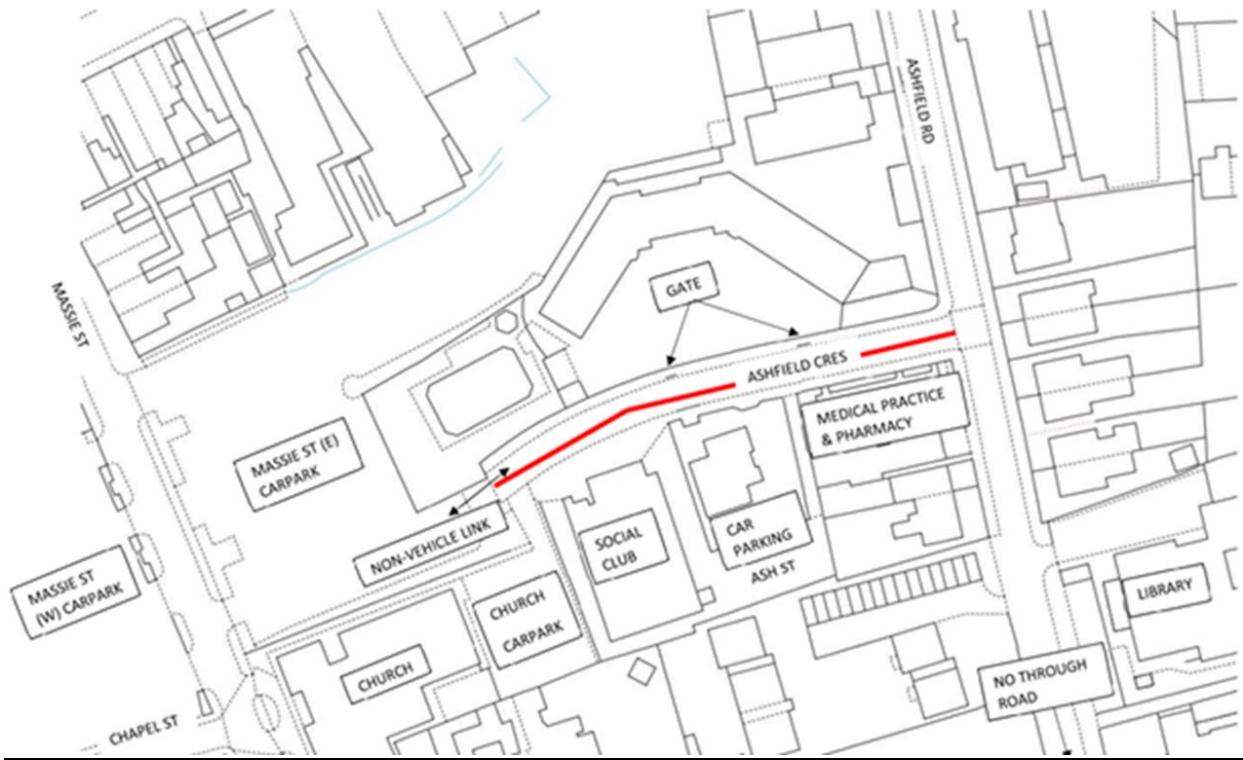

## Our Lady's and St Matthew's Primary Schools

— School Street

Our Lady's Primary and St Matthew's Primary - Edgeley

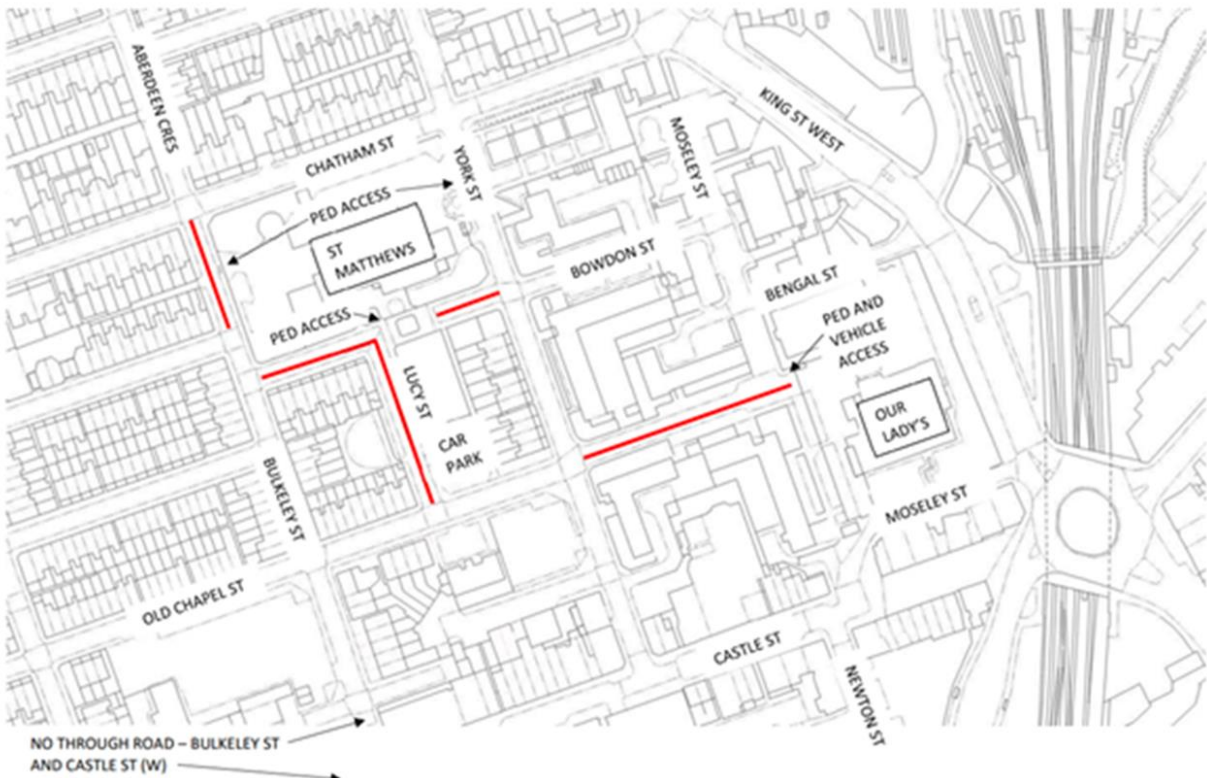

## St Joseph's Primary School

School Street

St Josephs – Etchells Street, Stockport

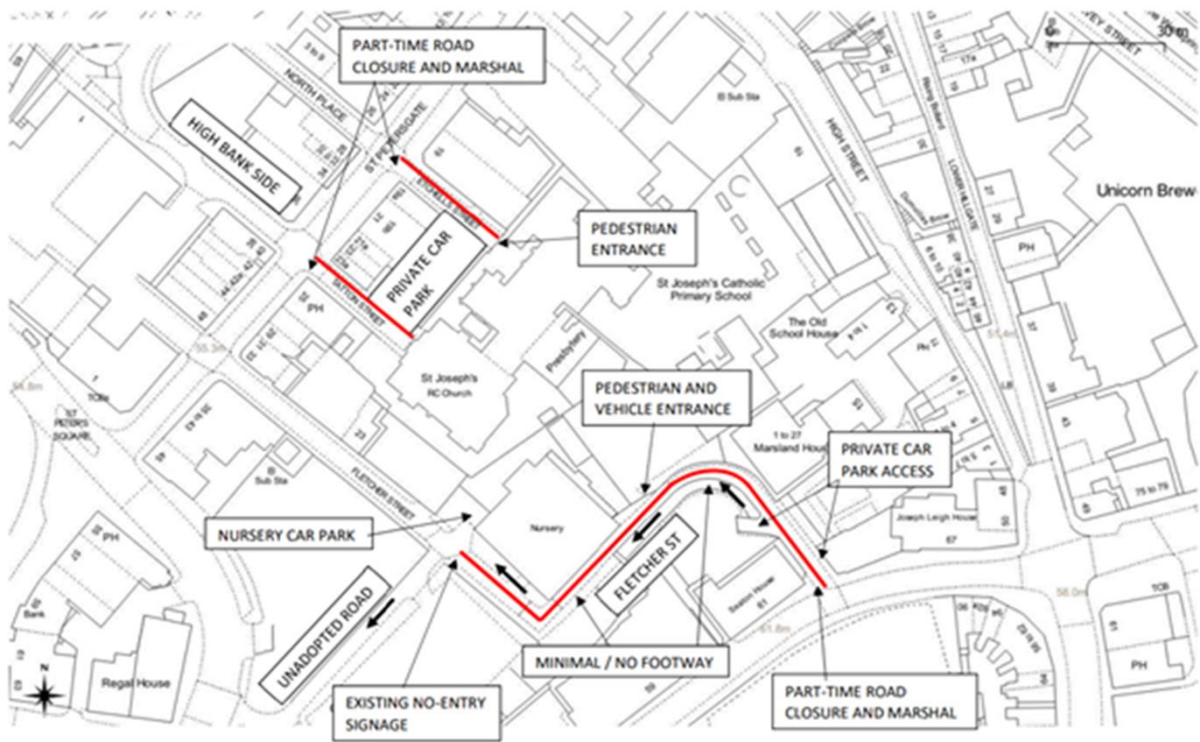

### St Mary's Primary School

School Street

St Marys - Reddish



**School Streets Report Trial Approval 2022**

**Report of the Head of Highways and Transportation**

**1. INTRODUCTION**

- 1.1. In 2021, Funding from the Government's Active Travel Fund (ATF) was allocated to TFGM to provide support for Local Authorities to deliver a series of 'School Streets' across the region to increase active and sustainable travel.
- 1.2. A school street is a road outside a school with a temporary restriction on motorised traffic at school drop-off and pick-up times. The restriction applies to all motor traffic, regardless of whether it is associated with the school itself, to create a street environment, which encourages cycling, scooting, or walking part or the entire school run.
- 1.3. In July 2021 Stockport Council submitted applications for funding to TFGM on behalf of the 8 schools who expressed interest in running a School Street at their school and £50k of funding was granted to be split between the 8 schools.
- 1.4. Proposals for consultation were developed in conjunction with the school and included a range of officer input. These identified roads needing to be closed and the times for the closures. The potential locations in need of being issued with permits that would enable them to pass through the closure and the options for parking for parents who could not travel by alternate modes. Local Councillors were also spoken to about the proposed trials before consultation commenced.
- 1.5. Between 7th and 28<sup>th</sup> March 2022, i.e. over a 3 week period, Stockport Council consulted on all 8 proposals to run school streets at these schools across the borough. The purpose of the consultation was specifically to inform the public, local businesses and interest groups of the school streets proposals and to capture their views and comments.
- 1.6. As well as an online consultation, supported by a letter drop to all residents and parents/guardians and staff of the school, there were also drop in event for each of the school locations as follows:
  - 1.6.1. Adswood Primary School: Adswood Community Centre- Wednesday 23rd March 1-7pm
  - 1.6.2. Bradshaw Hall Primary school – Tuesday 22nd March 3-7pm.
  - 1.6.3. Cheadle Primary school: Cheadle Library- Thursday 24th March 2-7pm
  - 1.6.4. Our Lady's Catholic Primary school: school hall: Wednesday 16th March 3.30-7pm (also open to St Matthews parents and residents)
  - 1.6.5. St Matthew's C of E Primary school: school hall: Tuesday 15th March – 2.30-4.30pm
  - 1.6.6. St Mary's C of E Primary school – School library area: Monday 21st March 3.20-6.30pm



- 1.6.7. St Johns CE Primary school – school hall: Monday 21st March 3-7pm
- 1.6.8. St Joseph's Catholic Primary school: school hall on Thursday 17th March 3-7pm.

1.7. This report presents the response to the proposals and proposed next steps. Details for each school as shared with Councillors for the relevant areas can be seen in the Appendices.

## **2. OVERALL RESULTS**

### **2.1. Adswood School**

- 2.1.1. The consultation results were in favour of making the roads around the school safer, however, there was no overall majority in favour of the proposals put forward. There were only 25 responses and the majority of the responses against the scheme were on the roads nearest to the school not to be closed.
- 2.1.2. The School and local councillors are still in favour of trialling the closure as there are limited other options that the school does not already have in place. It had been suggested that a further road could be closed but the school did not wish to trial this in the initial scheme.
- 2.1.3. Officers recommend this scheme to go ahead with a strong focus on the use of sustainable modes, promotion of safer parking behaviours and a monitoring of the impact on nearby streets to inform future decisions about the scheme after the trial. The major issues for local residents focused on the impact of the closure on the nearby streets and this will need to be addressed to enable the school to be able to undertake a successful scheme.

### **2.2. Bradshaw Hall Primary school**

- 2.2.1. This school received 97 responses. Residents around Bradshaw Hall Primary School on the closed street are in favour of the School Street scheme. However there are issues highlighted by other residents regarding the transfer of congestion and the impact of related anti-social behaviour. The school and the councillors for the area are in favour of the scheme being trialled.
- 2.2.2. Officers recommends this scheme to go ahead with the supporting activities around addressing anti-social parking and the move to sustainable modes were possible.

### **2.3. Cheadle Primary school**

- 2.3.1. There were 82 responses to the consultation. Residents around Cheadle Primary School are in favour of the School Street scheme. The proposal is supported by the school and local councillors.
- 2.3.2. Officers recommends this scheme to go ahead with appropriate support to insure that local businesses, specifically the Doctors surgery, have access to permits as needed with assistance given to make sure that they are supported in the use and impact of the scheme on their staff. The supporting road safety advices and parking support will also need to be given to parents and pupils where necessary.

## **2.4. Our Lady's Catholic Primary School and St Matthew's C of E Primary School**

- 2.4.1. These schools due to the close proximity are being looked at together. There were 28 responses altogether this is despite extra advertising of the consultation on Facebook as well as the letter drops etc. received by all other schools. Both schools consultations identified a strong need to improve traffic and safety in the area. However, this particular scheme did not receive clear support. The large reason for this is the congestion on the roads and the likely displaced impact.
- 2.4.2. Both schools are still in favour of the scheme.
- 2.4.3. Officers recommend this scheme to go ahead with the necessary work to assist the residents in the flats and houses near the schemes to be able to access their properties as needed. Part of this will include enforcement on nearby streets and the need to strongly encourage better parking and use of the park and stride car parks. The success of the scheme depends on encouraging parents who must drive to park in car parks in the area and walk to the school.

## **2.5. St Mary's C of E Primary School**

- 2.5.1. Of the 42 responses 83% are in favour of the scheme. The proposal for a trial is supported by the Councillors and the school. Officers recommend this scheme to go ahead with supporting work on the use of the park and stride facilities available for parents being undertaken to address the issue of the congestion moving to other close by streets.

## **2.6. St Johns CE Primary school**

- 2.6.1. There were 54 responses to the scheme and these did indicate local support. However, it is also clear that there is concern on the adjoining roads about the impact of displacement parking and that there are few other options to encourage appropriate parking.
- 2.6.2. Contact with the school has confirmed they would still like to take part but are still concerned about their ability to provide marshals for the closures.
- 2.6.3. The Councillors have expressed concerns about the scheme due to the low consultation numbers and the parking issues likely on the other roads. Therefore they do not wish to support the scheme.
- 2.6.4. Officers recommend that the school is advised that the scheme is not to go ahead and the local residents are advised of this decision.

## **2.7. St Joseph's Catholic Primary School**

- 2.7.1. Residents/ businesses around St Joseph's Catholic Primary School who responded are mostly in favour of the School Street scheme. The proposal for a trial is supported by the Councillors and the school.
- 2.7.2. Officers recommends this scheme to go ahead with the supporting actions regarding parking and permits for the businesses in the area.

### **3. PROPOSED NEXT STEPS**

3.1. Officers will take the following next steps:

- 3.1.1. Contact Schools and organise work to put in place Risk Assessments, Train Marshals in safe road closure and closure management and organise assemblies for children on the scheme and road safety.
- 3.1.2. Contact the residents and parents about the future of the scheme and the process going forward.
- 3.1.3. Contact the residents who will need permits to put them in place for the residents including supporting residents and businesses with more complex access needs.
- 3.1.4. Procure the necessary equipment to put closures in to place
- 3.1.5. Finalise the details of the closures placement and put in place TROs for School Street Trials. The Traffic Management Orders would be made under Section 1 of the Road Traffic Regulation Act 1984.
- 3.1.6. Organise wider publicity about the school street closures.

### **4. RECOMMENDATION**

4.1. The cabinet member of Economy and Regeneration approves the trial of the following School Streets be progressed:

- 4.1.1. Adswold Primary School, closing Neston Grove
- 4.1.2. Bradshaw Hall Primary School, closing the Vernon Close and Blossoms Hey
- 4.1.3. Cheadle Primary School, closing the Ashfield Crescent
- 4.1.4. Our Lady's Primary School, closing the Old Chapel Street (East of York St)
- 4.1.5. St Mary's C of E Primary School, closing the Broomfield Drive, Broomfield Close, Broom
- 4.1.6. St Matthew's Primary School, closing the Bulkeley Street (school frontage only), Bowdon Street (west of York St), Lucy Street, and
- 4.1.7. St Joseph's will involve closing Fletcher Street, Etchells Street, Tatton Street