

This map is reproduced from Ordnance Survey, intended with the permission of Ordnance Survey on behalf of the Controller of Her Majesty's Stationery Office. It is not to be used for any purpose other than that for which it was prepared, and may lead to prosecution or civil proceedings. Stockport Metropolitan Borough Council 10/01/9/17/2022

# TROS TO BE REVOKED

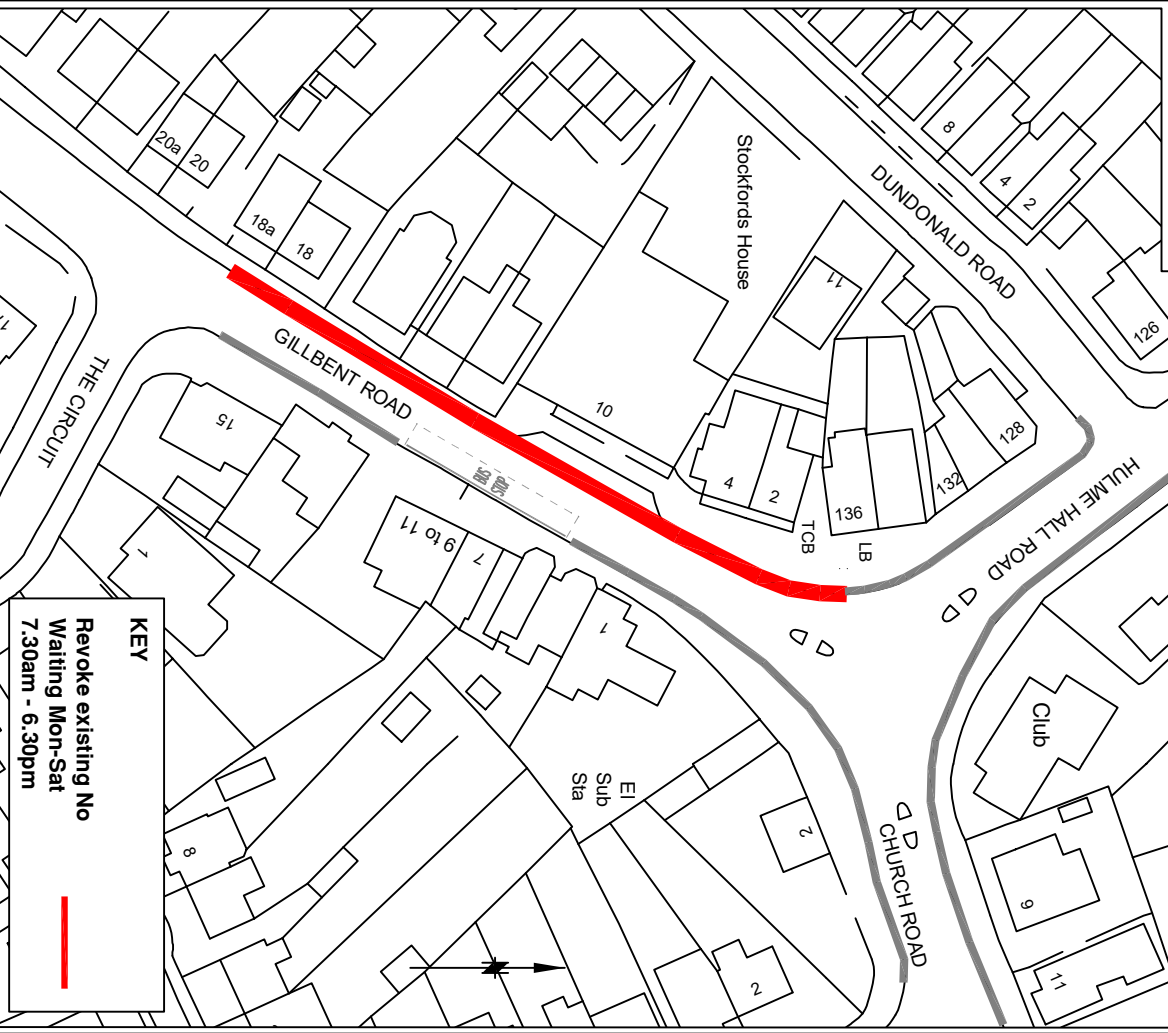

**KEY**  
 Revoke existing No Waiting Mon-Sat 7.30am - 6.30pm

# PROPOSED TRO CHANGES

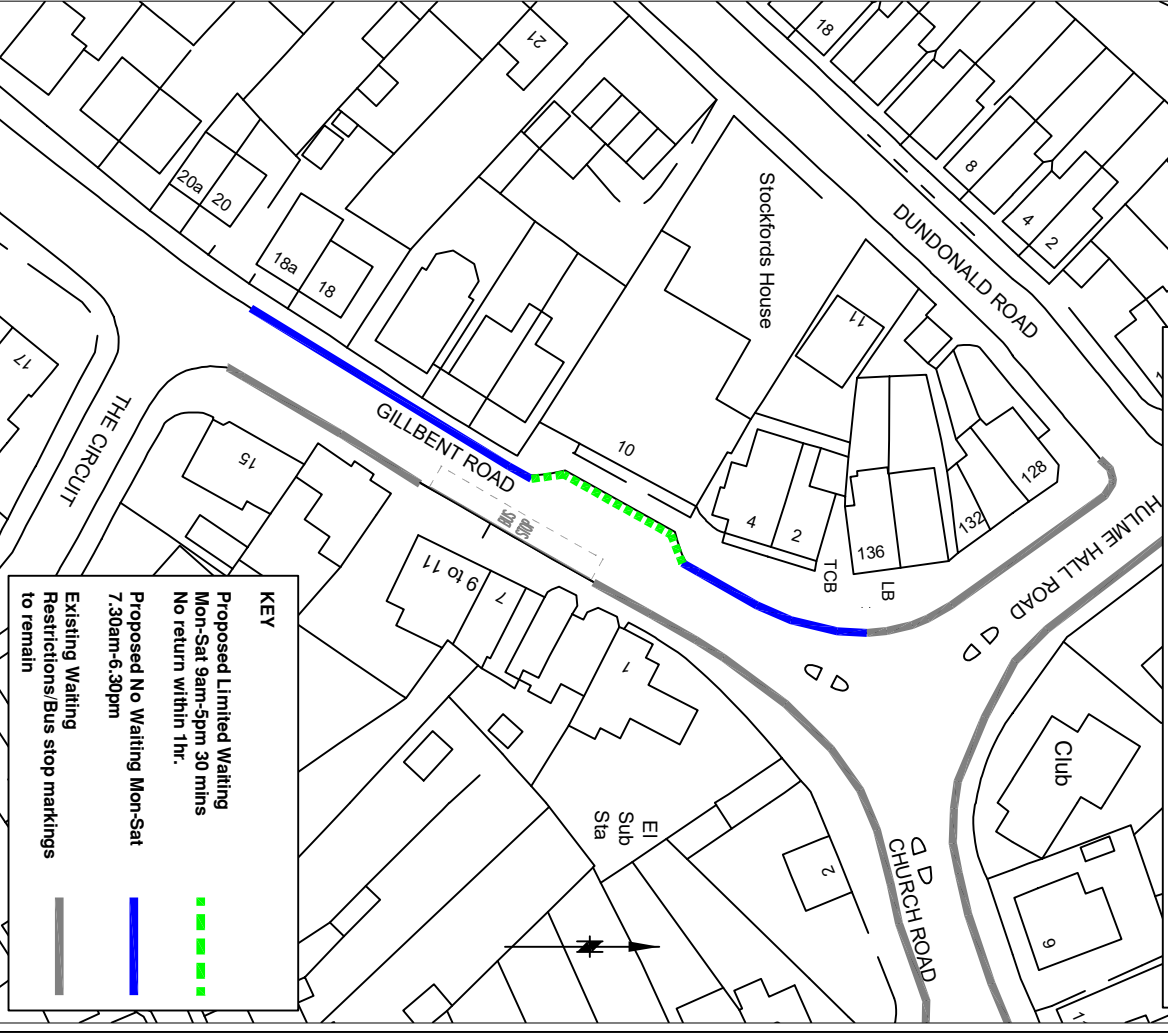

**KEY**  
 Proposed Limited Waiting Mon-Sat 9am-5pm 30 mins No return within 1hr. (Green dashed line)  
 Proposed No Waiting Mon-Sat 7.30am-6.30pm (Blue solid line)  
 Existing Waiting Restrictions/Bus stop markings to remain (Grey solid line)

### AMENDMENTS

DRAWN	CHECKED	DATE	No	AMENDMENT

### JOB TITLE

Gillbent Road, Cheadle Hulme

Proposed Traffic Regulation Order

Drawn	Engineer	Checked	Approved
SA	NR	EPS	EPS
Date	Date	Date	Date
18/07/23	18/07/23	18/07/23	18/07/23

Scale: NTS  
 Drawing No: 1013-Gillbent Road-2023-01  
 Revision:



**STOCKPORT**  
 METROPOLITAN BOROUGH COUNCIL  
 HIGHWAYS AND TRANSPORTATION  
 STOCKPORT SKI 1013

SERVICES TO PLACE