







This map is reproduced from Ordnance Survey material with the permission of Ordnance Survey on behalf of the Controller of Her Majesty's Stationery Office © Crown copyright. Unauthorised reproduction infringes Crown copyright and may lead to prosecution or civil proceedings. Stockport Metropolitan Borough Council 100019571 2022

KEY:

-  FOOTWAY
-  CARRIAGEWAY
-  VERGE
-  UNCONTROLLED TACTILE PAVING

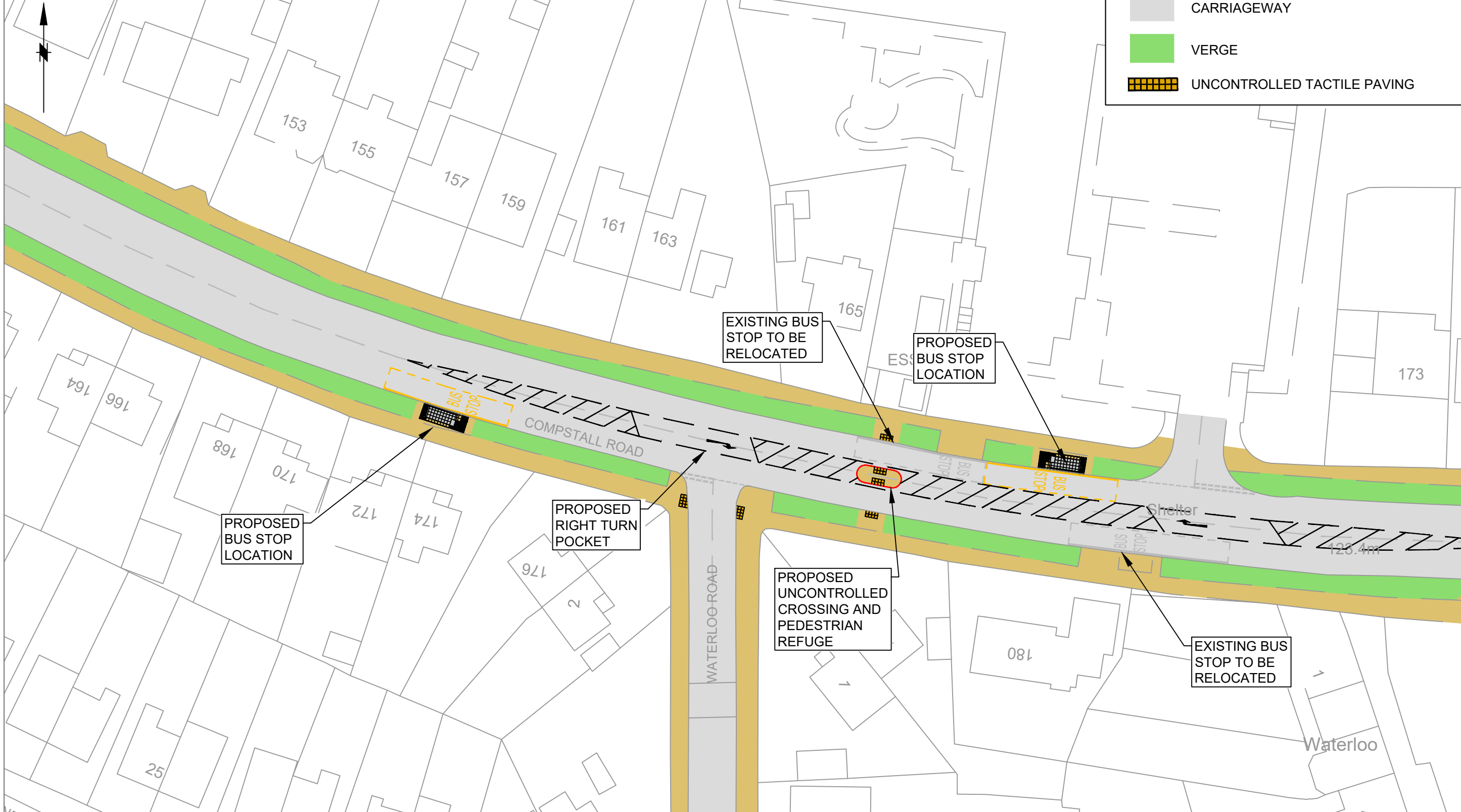
STOCKPORT
METROPOLITAN BOROUGH COUNCIL
HIGHWAYS AND TRANSPORTATION
STOPFORD HOUSE
STOCKPORT SK1 3XE
TEL

SERVICES TO PLACE

AMENDMENTS				
DRAWN	CHECKED	DATE	No	AMENDMENT

JOB TITLE
BUS PINCH POINTS

DRAWING TITLE
COMPSTALL ROAD / WATERLOO ROAD, ROMILEY
PROPOSED PEDESTRIAN REFUGE

Drawn TOG	Engineer TOG	Checked RM	Approved KF
Date 12/10/22	Date 12/10/22	Date 12/10/22	Date
Scale 1:500			
Drawing No. 0700-100-S8-01B			Revision -