

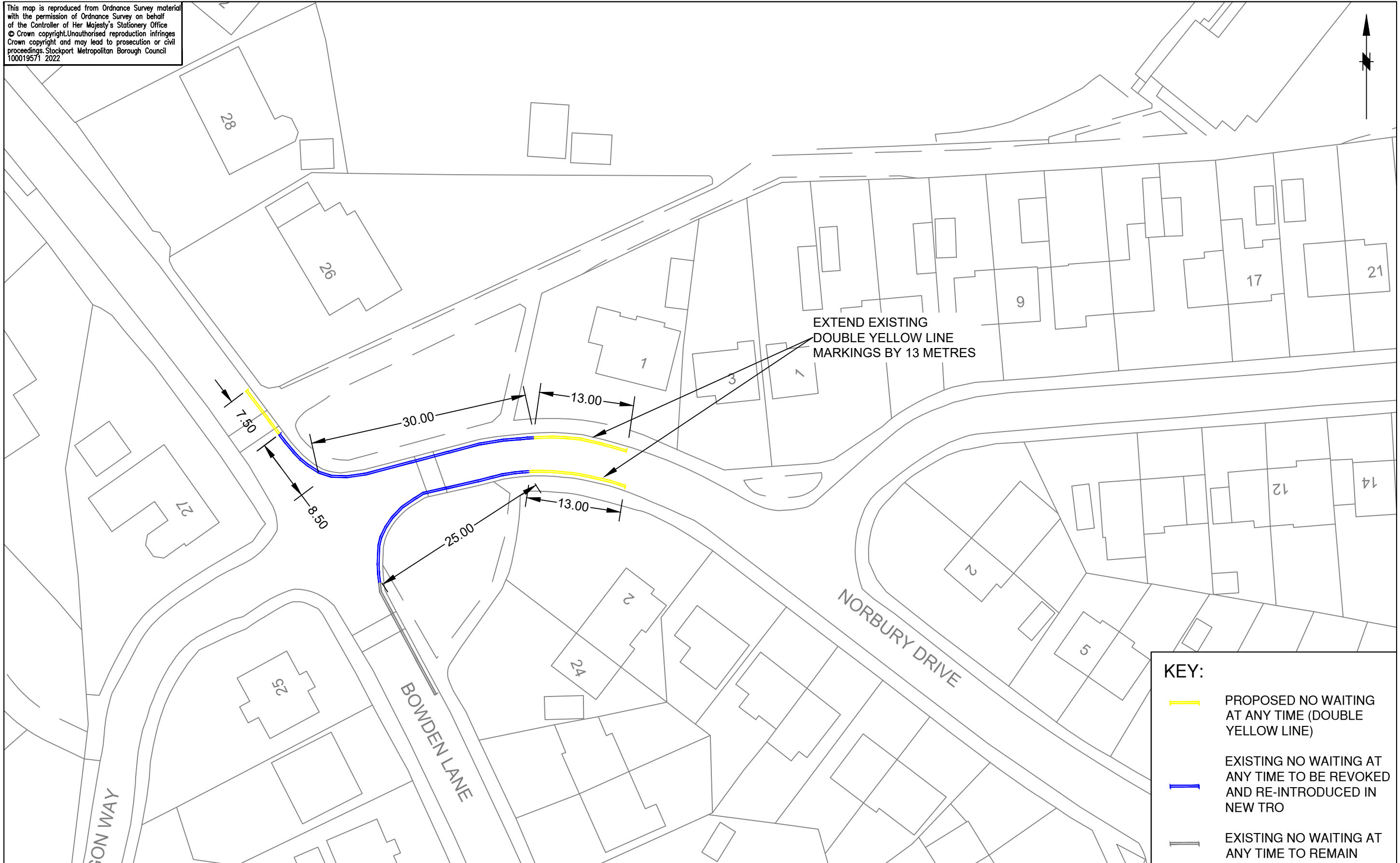

This map is reproduced from Ordnance Survey material with the permission of Ordnance Survey on behalf of the Controller of Her Majesty's Stationery Office © Crown copyright. Unauthorised reproduction infringes Crown copyright and may lead to prosecution or civil proceedings. Stockport Metropolitan Borough Council 100019571 2022



**KEY:**

- PROPOSED NO WAITING AT ANY TIME (DOUBLE YELLOW LINE)
- EXISTING NO WAITING AT ANY TIME TO BE REVOKED AND RE-INTRODUCED IN NEW TRO
- EXISTING NO WAITING AT ANY TIME TO REMAIN



**STOCKPORT**  
METROPOLITAN BOROUGH COUNCIL  
HIGHWAYS AND TRANSPORTATION  
STOPFORD HOUSE  
STOCKPORT SK1 3XE  
Tel : 0161 474

MARK GLYNN  
DIRECTOR OF PLACE MANAGEMENT

AMENDMENTS				
DRAWN	CHECKED	DATE	No	AMENDMENT

**JOB TITLE**  
NO WAITING AT ANY TIME EXTENSION

**DRAWING TITLE**  
NORBURY DRIVE

Drawn RPO	Engineer GB	Checked GB	Approved ES
Date 27/10/22	Date 15/11/22	Date 15/11/22	Date 15/11/22
Scale 1:500			
Drawing No. NM8 / 5213 / 01			Revision