



This map is reproduced from Ordnance Survey material with the permission of Ordnance Survey on behalf of the Controller of Her Majesty's Stationery Office © Crown copyright. Unauthorised reproduction infringes Crown copyright and may lead to prosecution or civil proceedings. Stockport Metropolitan Borough Council 100019571 2022

KEY

PROVIDE 20MPH/30MPH TERMINAL SIGNS ON NEW POST AND 20MPH/30PH ROUNDELS ON CARRIAGEWAY

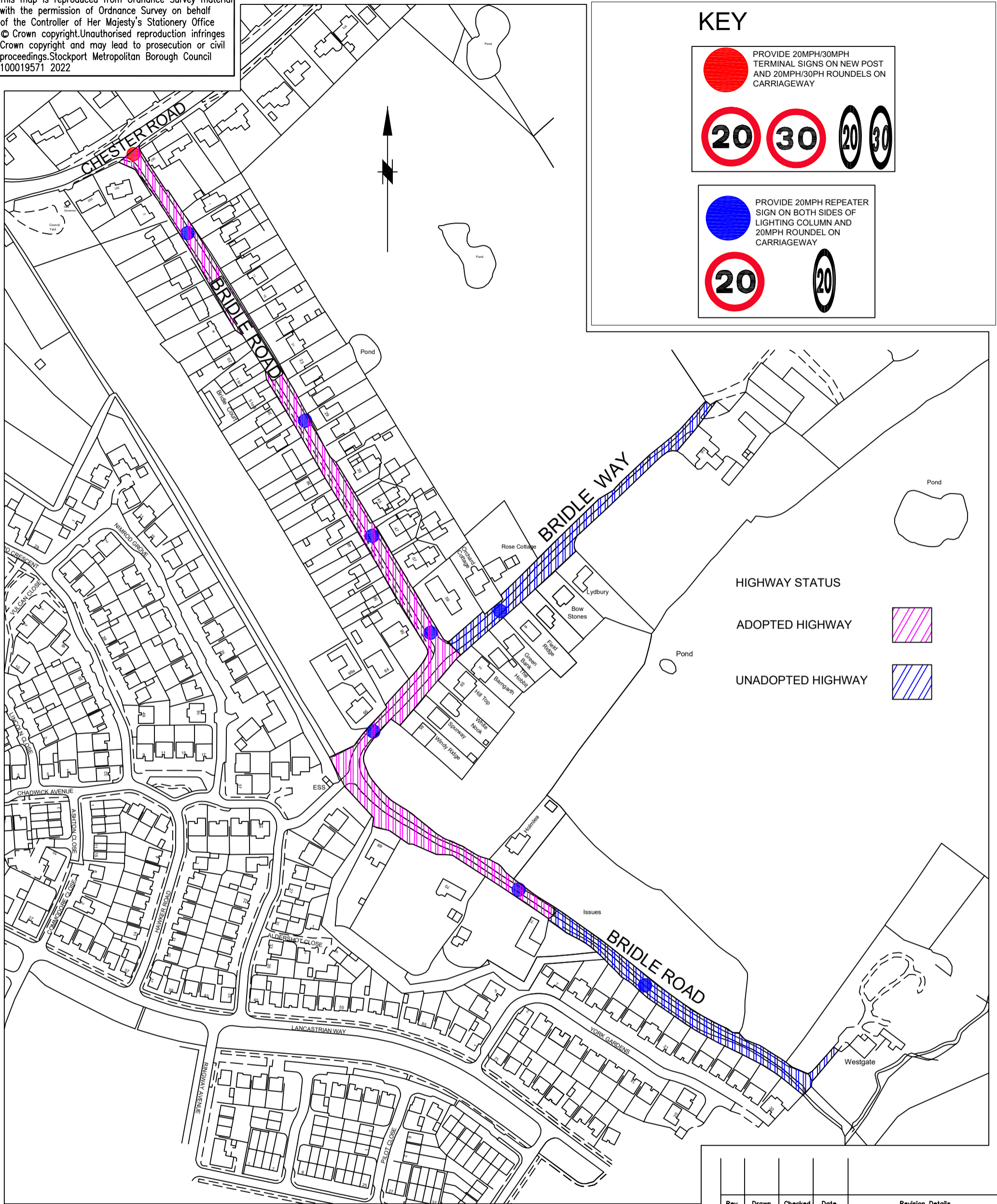

PROVIDE 20MPH REPEATER SIGN ON BOTH SIDES OF LIGHTING COLUMN AND 20MPH ROUNDEL ON CARRIAGEWAY

STOCKPORT
METROPOLITAN BOROUGH COUNCIL

HIGHWAYS AND TRANSPORTATION
STOFFORD HOUSE
STOCKPORT SK1 3XE
TEL

MARK GLYNN
DIRECTOR OF PLACE MANAGEMENT

JOB TITLE

BRIDLE ROAD, WOODFORD

DRAWN SA	ENGINEER SA	CHECKED NR	APPROVED EPS
DATE 26/09/22	DATE 26/09/22	DATE 26/09/22	DATE 26/09/23
SCALE NTS	SCG No. SCGNO		

DRAWING NUMBER NM8-5195/SLO Revision A

DRAWING TITLE
PROPOSED 20MPH SPEED LIMIT