

Revision:		
A	Visi to Centreline & Extended Yellow Lines	05/02/21
B	SMBC Suggested Kerb Build-Out	17/11/21
C	Minor Kerb Taper Amend in Response to RSA1	29/11/21



Note: The exact extent of new parking restrictions to be determined by the Highway Authority as part of a separate Traffic Regulation Order Process

Client:	Mr K Swindells		
Project:	The Garden House Marple		
Drawing Title:	Faywood Drive / Arkwright Road Proposed 'Build Out' Layout Extended Double Yellow Lines		
Drawing Number:	J000014-SK201	Revision:	C
Date:	05/02/21	Scale:	1:250@A3
Drawn By:	APB	Checked By:	-
Status:	Information		

This drawing is the copyright of Focus Transport Planning Ltd. and may not be loaned, copied or reproduced in any way, or used for any offer, quote, tender or construction purposes without prior written consent of the company.

DO NOT SCALE - Follow any figured dimensions.

This drawing has been prepared for feasibility purposes and does not represent a construction plan. All design aspects to be confirmed at the appropriate detailed design stage.

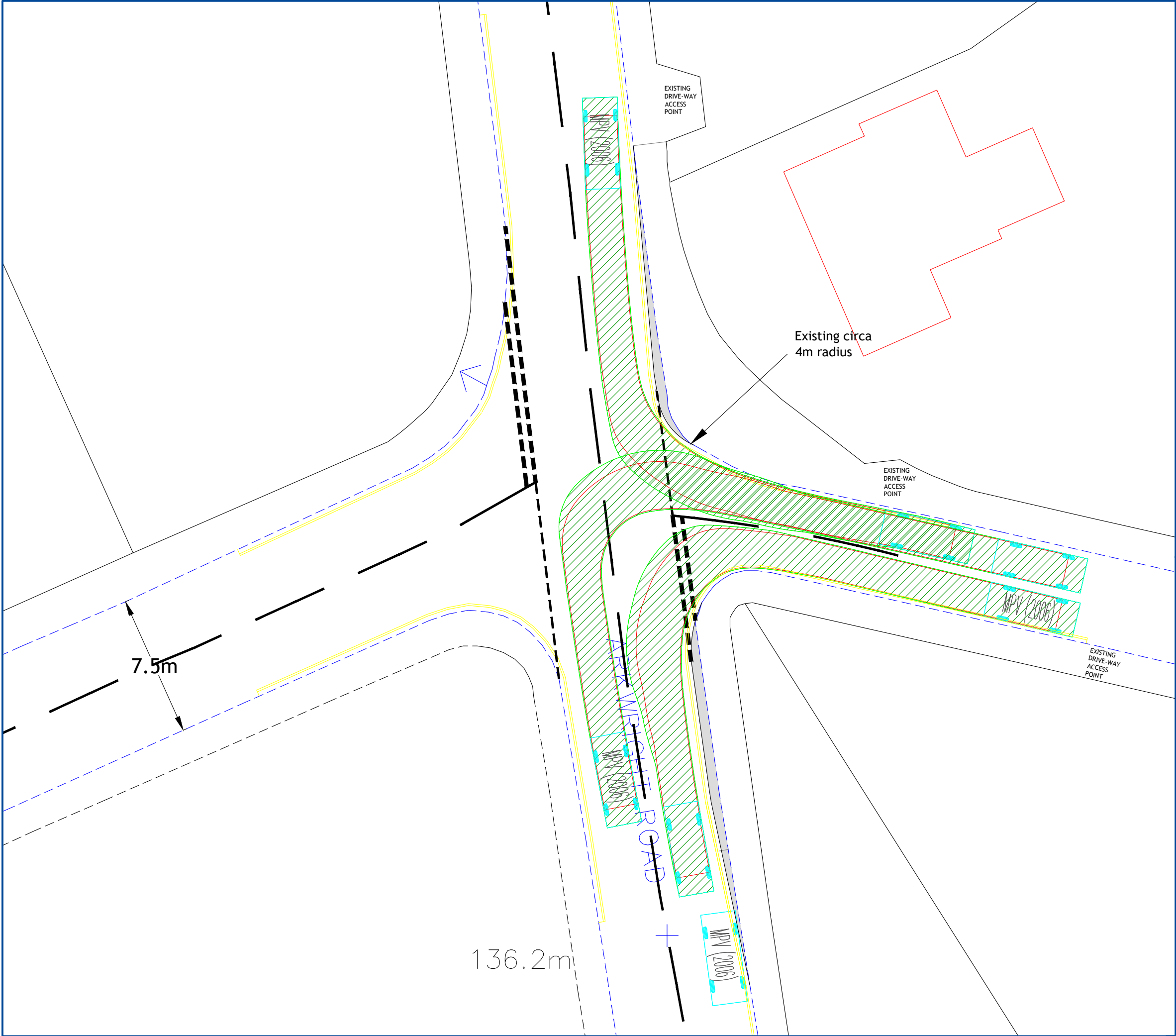

Revision:		
A	SMBC Suggested Kerb Build-Out	17/11/21
B	Minor Kerb Taper Amend in Response to RSA1	29/11/21

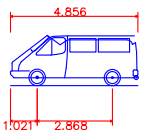

MPV (2006)	4.856m
Overall Length	4.856m
Overall Width	1.860m
Overall Body Height	1.919m
Min Body Ground Clearance	0.300m
Max Track Width	1.779m
Lock to lock time	4.00s
Kerb to Kerb Turning Radius	5.700m

Client:	The Garden House, Marple
Project:	The Garden House Appeal Against Enforcement Notice
Drawing Title:	Faywood Drive / Arkwright Road Proposed 'Build Out' Layout Vehicle Swept Paths - MPV Family Car
Drawing Number:	J000014-ATR201
Revision:	B
Date:	17/11/21
Scale:	1:200@A3
Drawn By:	APB
Checked By:	-

Status: Information

This drawing is the copyright of Focus Transport Planning Ltd. and may not be loaned, copied or reproduced in any way, or used for any offer, quote, tender or construction purposes without prior written consent of the company.

DO NOT SCALE - Follow any figured dimensions.

This drawing has been prepared for feasibility purposes and does not represent a construction plan. All design aspects to be confirmed at the appropriate detailed design stage.

Site 3, Portland House
Village Way, Winflow
SK9 2GH

0161 826 4631
www.focusdp.co.uk

FOCUS
TRANSPORT PLANNING

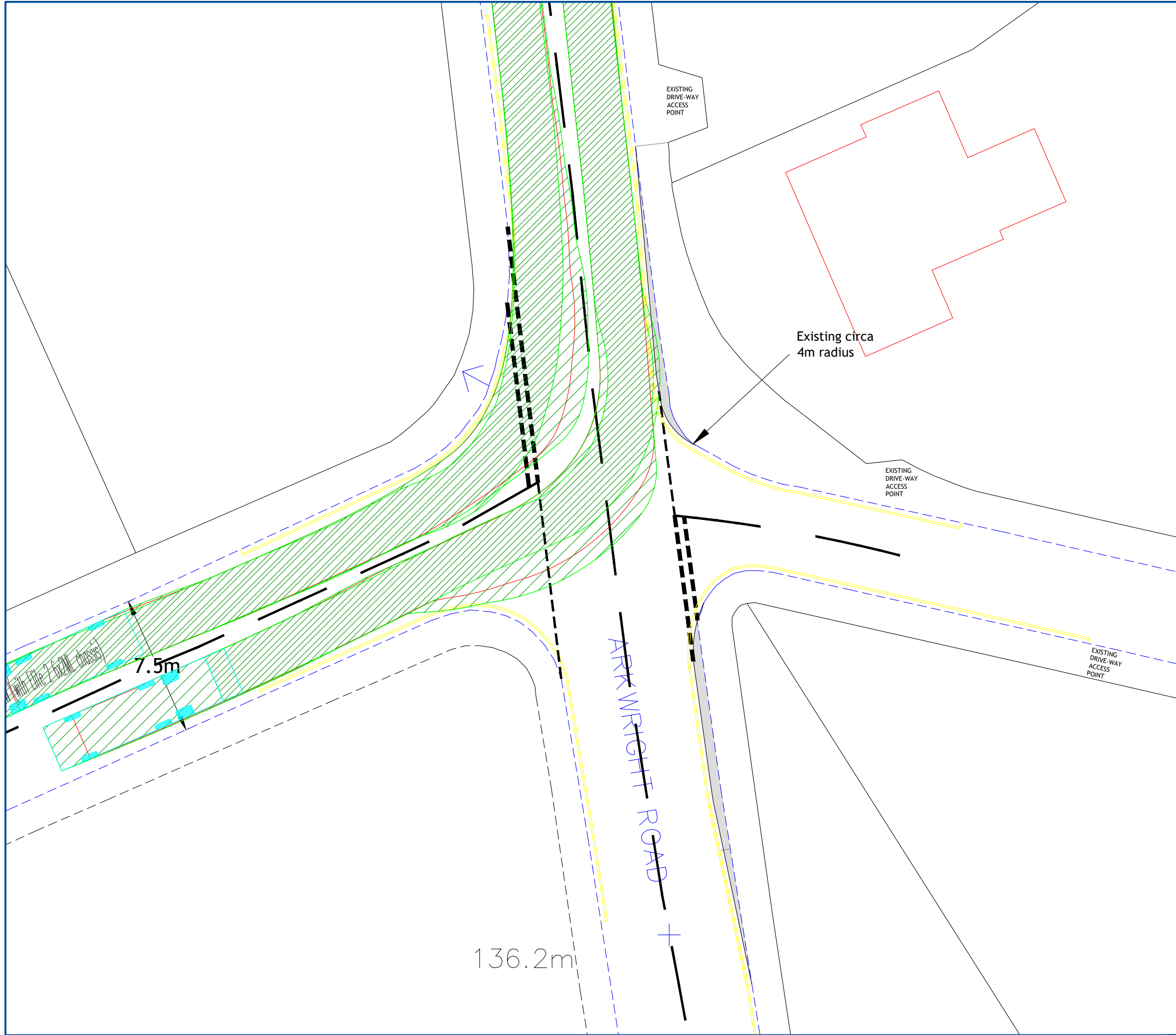

Revision:		
A	SMBC Suggested Kerb Build-Out	17/11/21
B	Minor Kerb Taper Amend in Response to RSA1	29/11/21

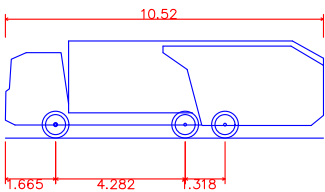

Phoenix 2-23W (with Elite 2 6x2ML chassis)
Overall Length 10.520m
Overall Width 2.530m
Overall Body Height 3.211m
Min Body Ground Clearance 0.416m
Track Width 2.530m
Lock to lock time 4.00s
Kerb to Kerb Turning Radius 10.250m

Client:	The Garden House, Marple		
Project:	The Garden House		
Drawing Title:	Faywood Drive / Arkwright Road Proposed 'Build Out' Layout Vehicle Swept Paths - Large RCV		
Drawing Number:	J000014-ATR202	Revision:	B
Date:	17/11/21	Scale:	1:200@A3
Drawn By:	APB	Checked By:	-

Status: Information

This drawing is the copyright of Focus Transport Planning Ltd. and may not be loaned, copied or reproduced in any way, or used for any offer, quote, tender or construction purposes without prior written consent of the company.

DO NOT SCALE - Follow any figured dimensions.

This drawing has been prepared for feasibility purposes and does not represent a construction plan. All design aspects to be confirmed at the appropriate detailed design stage.

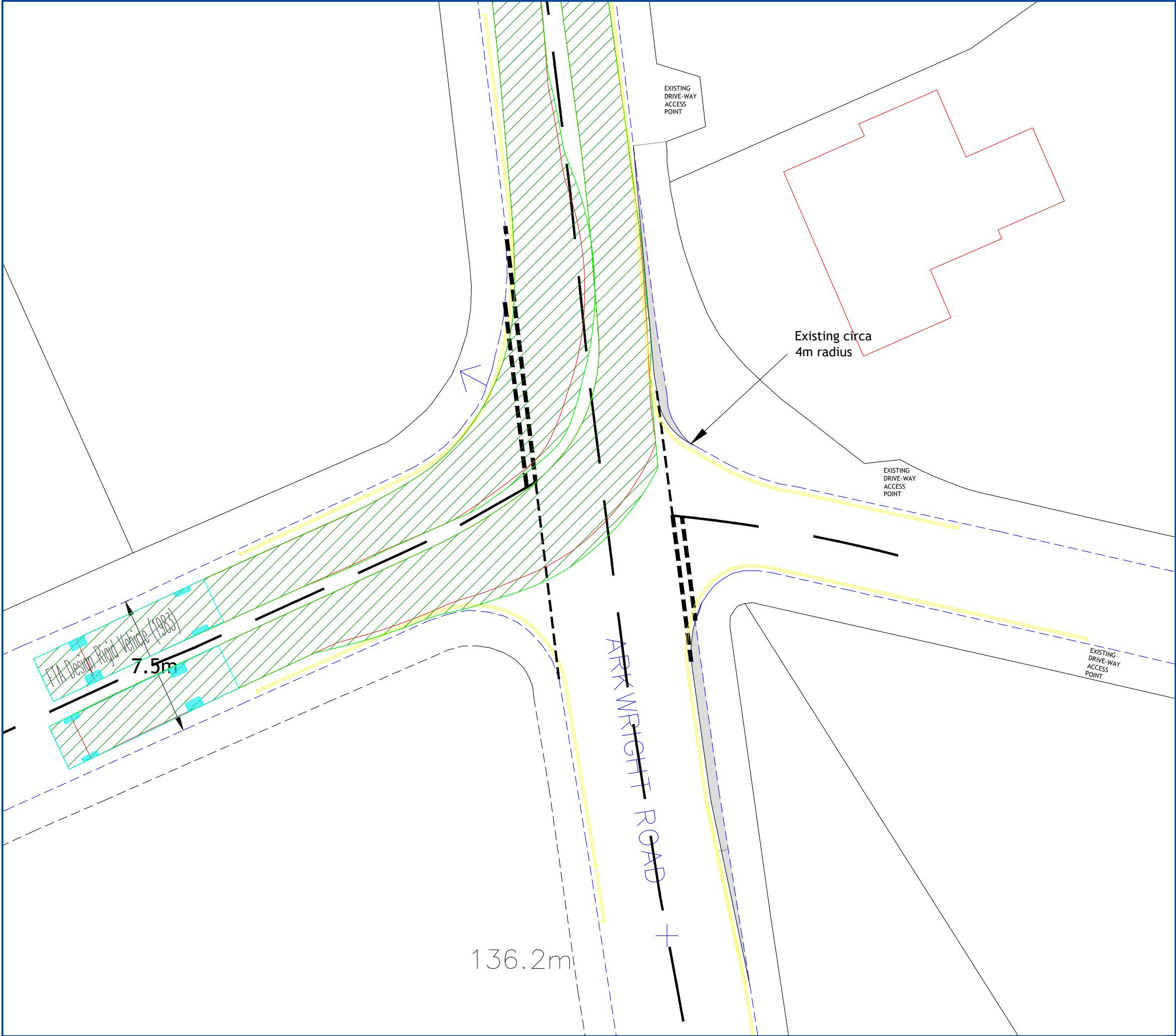

Revision:		
A	SMBC Suggested Kerb Build-Out	17/11/21
B	Minor Kerb Taper Amend in Response to RSA1	29/11/21

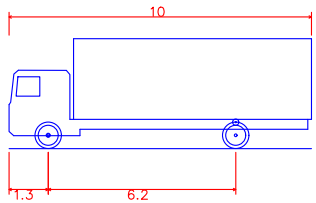

FTA Design Rigid Vehicle (1983)	
Overall Length	10.000m
Overall Width	2.500m
Overall Body Height	3.632m
Min Body Ground Clearance	0.427m
Track Width	2.500m
Lock to lock time	4.00s
Kerb to Kerb Turning Radius	12.000m

Client:	The Garden House, Marple
Project:	The Garden House
Drawing Title:	Faywood Drive / Arkwright Road Proposed 'Build Out' Layout Vehicle Swept Paths - Rigid HGV
Drawing Number:	J000014-ATR203
Revision:	B
Date:	17/11/21
Scale:	1:200@A3
Drawn By:	APB
Checked By:	-

Status:	Information
---------	-------------

This drawing is the copyright of Focus Transport Planning Ltd. and may not be loaned, copied or reproduced in any way, or used for any offer, quote, tender or construction purposes without prior written consent of the company.

DO NOT SCALE - Follow any figured dimensions.

This drawing has been prepared for feasibility purposes and does not represent a construction plan. All design aspects to be confirmed at the appropriate detailed design stage.

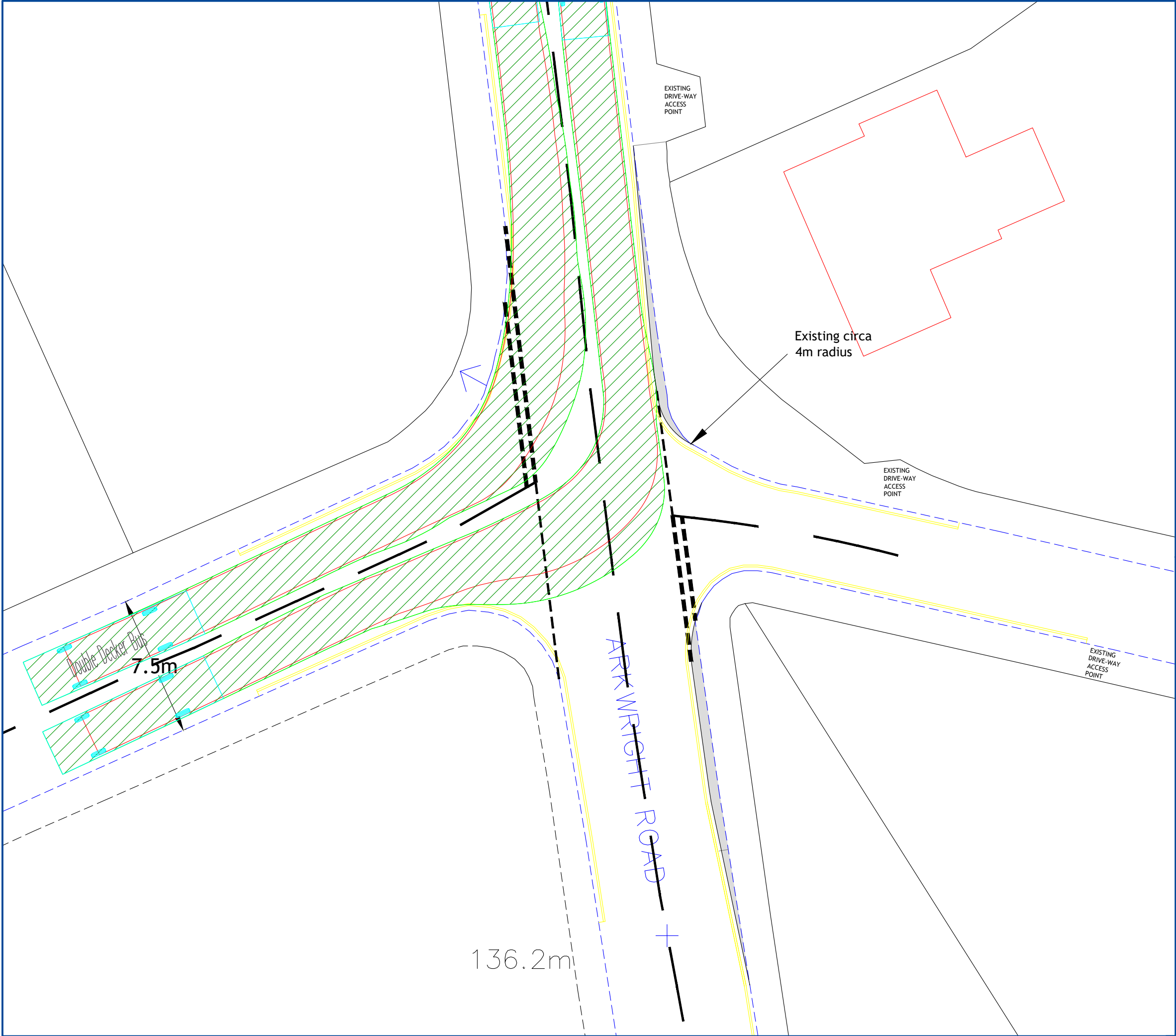

Revision:		
A	SMBC Suggested Kerb Build-Out	17/11/21
B	Minor Kerb Taper Amend in Response to RSA1	29/11/21

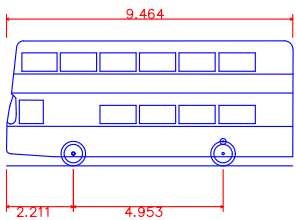

Double Decker Bus	
Overall Length	9.464m
Overall Width	2.500m
Overall Body Height	4.129m
Min Body Ground Clearance	0.300m
Track Width	2.300m
Lock to lock time	6.00s
Kerb to Kerb Turning Radius	8.972m

Client:	The Garden House, Marple
Project:	The Garden House
Drawing Title:	Faywood Drive / Arkwright Road Proposed 'Build Out' Layout Vehicle Swept Paths - Double Decker Bus
Drawing Number:	J000014-ATR204
Revision:	B
Date:	17/11/21
Scale:	1:200@A3
Drawn By:	APB
Checked By:	-

Status:	Information
---------	-------------

This drawing is the copyright of Focus Transport Planning Ltd. and may not be loaned, copied or reproduced in any way, or used for any offer, quote, tender or construction purposes without prior written consent of the company.

DO NOT SCALE - Follow any figured dimensions.

This drawing has been prepared for feasibility purposes and does not represent a construction plan. All design aspects to be confirmed at the appropriate detailed design stage.

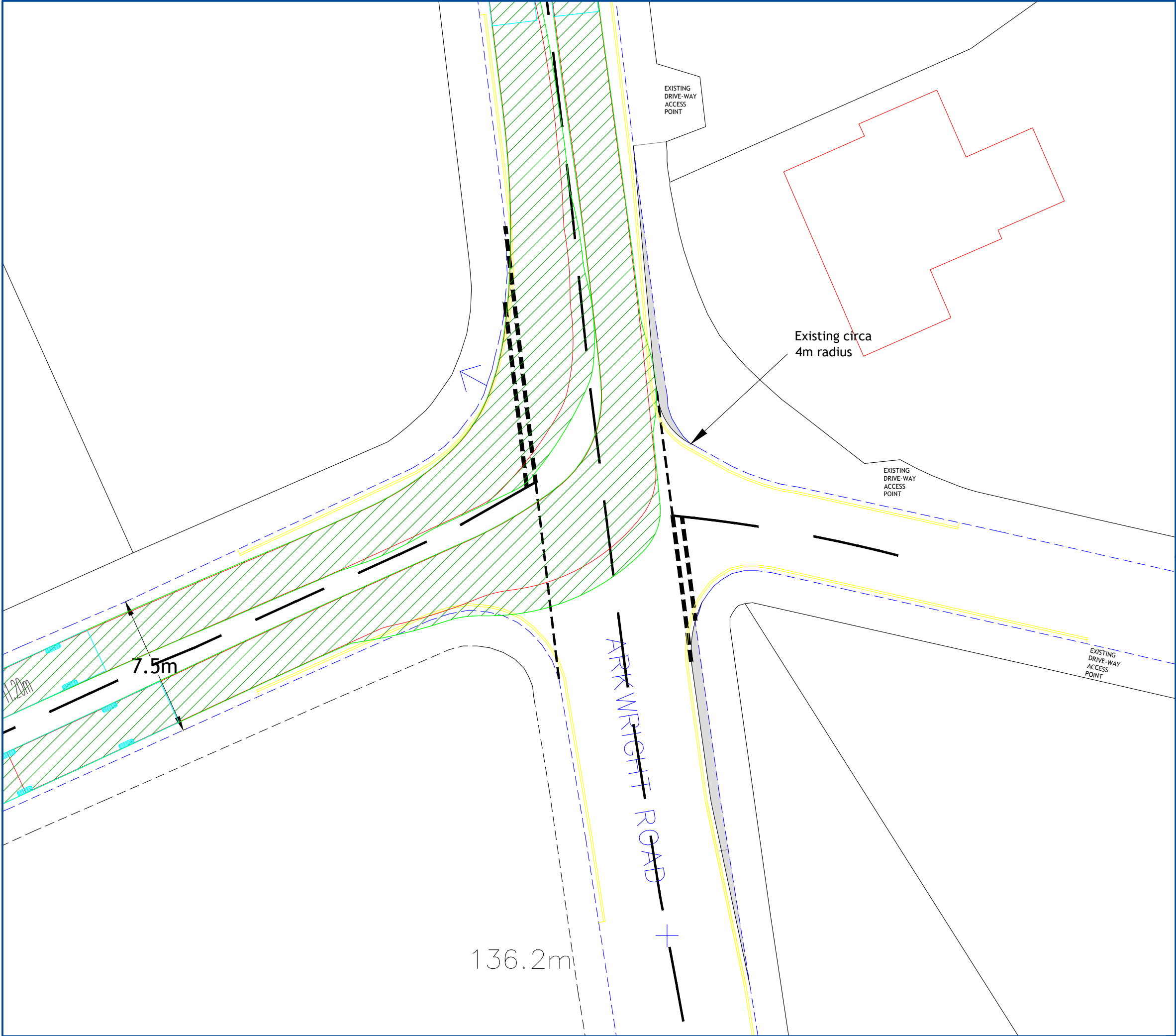

Revision:		
A	SMBC Suggested Kerb Build-Out	17/11/21
B	Minor Kerb Taper Amend in Response to RSA1	29/11/21

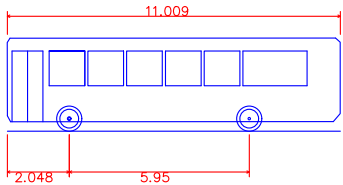

Dart SLF 11.20m	11.009m
Overall Length	2.401m
Overall Width	3.077m
Overall Body Height	0.312m
Min Body Ground Clearance	2.360m
Track Width	4.00s
Lock to lock time	9.518m
Kerb to Kerb Turning Radius	

Client:	The Garden House, Marple
Project:	The Garden House
Drawing Title:	Faywood Drive / Arkwright Road Proposed 'Build Out' Layout Vehicle Swept Paths - Single Deck Bus
Drawing Number:	J000014-ATR205
Revision:	B
Date:	17/11/21
Scale:	1:200@A3
Drawn By:	APB
Checked By:	-

Status:	Information
---------	-------------

This drawing is the copyright of Focus Transport Planning Ltd. and may not be loaned, copied or reproduced in any way, or used for any offer, quote, tender or construction purposes without prior written consent of the company.

DO NOT SCALE - Follow any figured dimensions.

This drawing has been prepared for feasibility purposes and does not represent a construction plan. All design aspects to be confirmed at the appropriate detailed design stage.

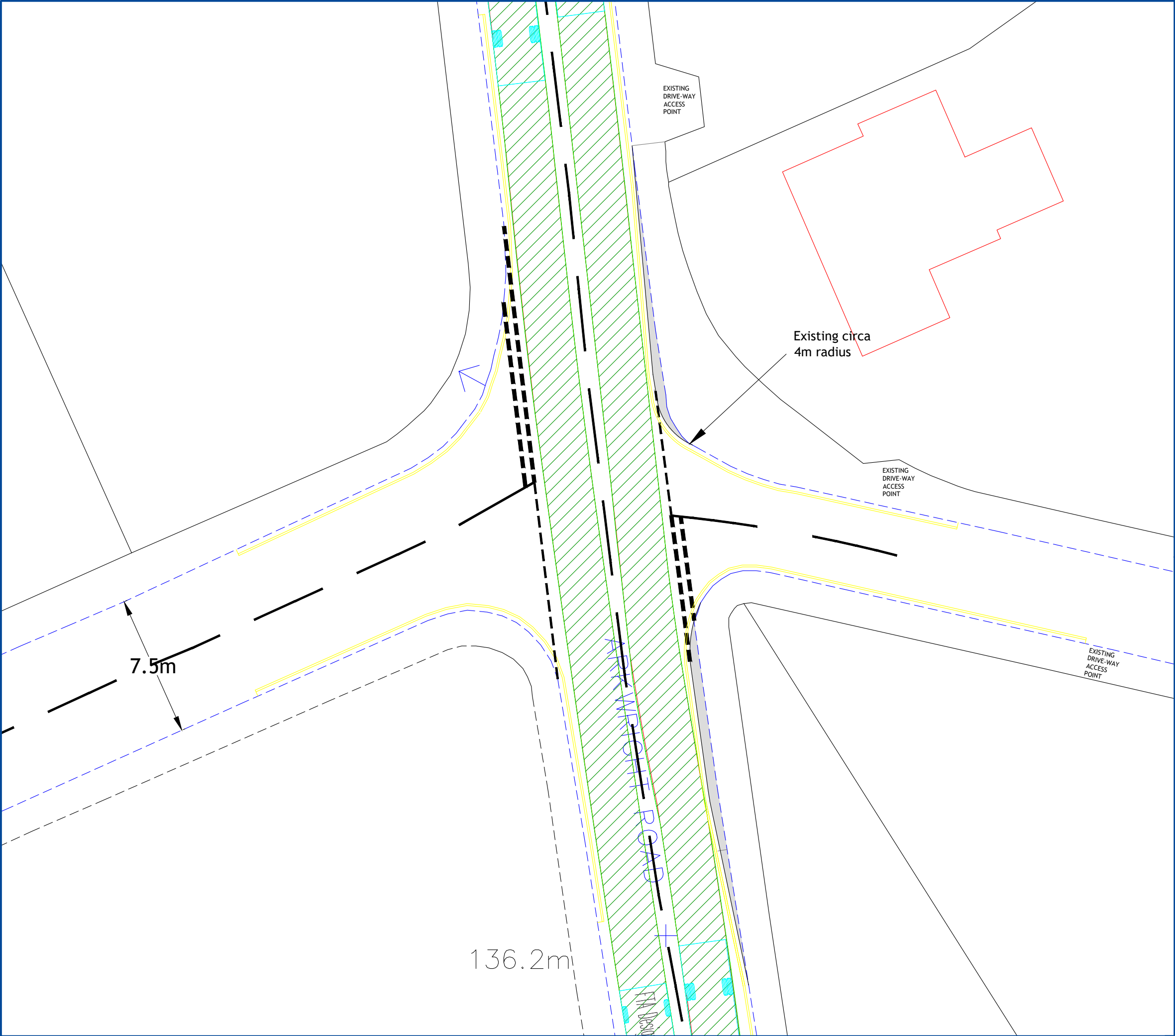

Revision:		
A	SMBC Suggested Kerb Build-Out	17/11/21
B	Minor Kerb Taper Amend in Response to RSA1	29/11/21

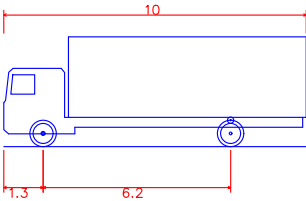

FTA Design Rigid Vehicle (1983)	
Overall Length	10.000m
Overall Width	2.500m
Overall Body Height	3.632m
Min Body Ground Clearance	0.427m
Track Width	2.500m
Lock to lock time	4.00s
Kerb to Kerb Turning Radius	12.000m

Client:	The Garden House, Marple
Project:	The Garden House
Drawing Title:	Faywood Drive / Arkwright Road Proposed 'Build Out' Layout Vehicle Swept Paths - Single Deck Bus
Drawing Number:	J000014-ATR206
Revision:	B
Date:	17/11/21
Scale:	1:200@A3
Drawn By:	APB
Checked By:	-

Status:	Information
This drawing is the copyright of Focus Transport Planning Ltd. and may not be loaned, copied or reproduced in any way, or used for any offer, quote, tender or construction purposes without prior written consent of the company.	
DO NOT SCALE - Follow any figured dimensions.	
This drawing has been prepared for feasibility purposes and does not represent a construction plan. All design aspects to be confirmed at the appropriate detailed design stage.	