

This map is reproduced from Ordnance Survey material with the permission of Ordnance Survey on behalf of the Controller of Her Majesty's Stationery Office © Crown copyright. Unauthorised reproduction infringes Crown copyright and may lead to prosecution or civil proceedings. Stockport Metropolitan Borough Council 100019571 2020

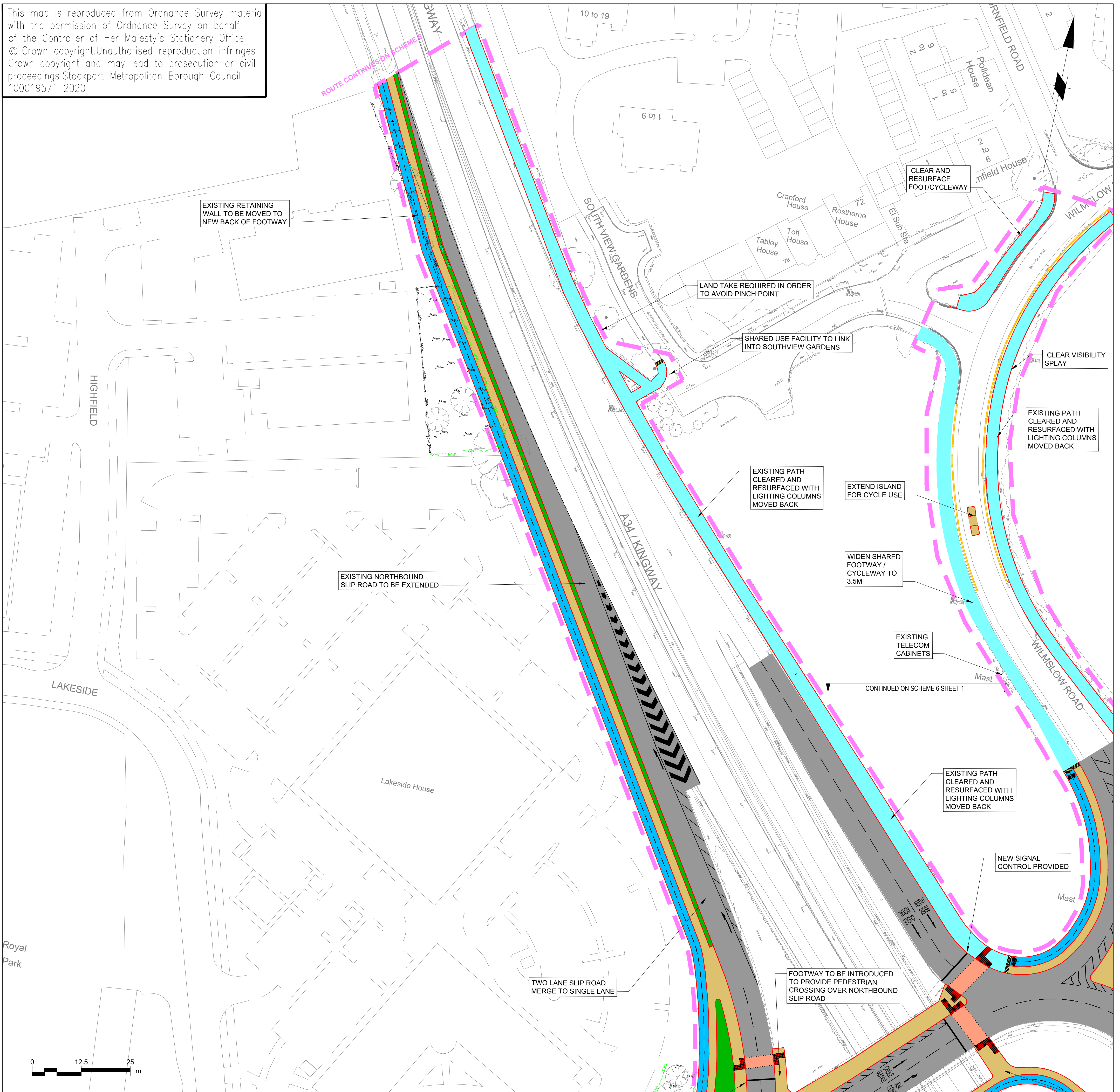

**KEY**

- CARRIAGEWAY RESURFACING
- FOOTWAY
- SHARED FOOTWAY / CYCLEWAY
- SEGREGATED CYCLEWAY
- VERGE / EMBANKMENT
- CONTROLLED TACTILE PAVING
- HAZARD TACTILE PAVING FOR SHARED USE AREAS
- PEDESTRIAN / CYCLE SIGNAL CROSSING
- PROPOSED NEW KERB
- SCHEME EXTENTS

**NOTES**

1. DRAWN TO 1:500 SCALE @ A1.
2. ALL PROPOSALS ARE SHOWN INDICATIVELY FOR CONSULTATION PURPOSES AND ARE SUBJECT TO CHANGE.
3. PLEASE REFER TO CONSULTATION LEAFLETS FOR SCHEME DESCRIPTIONS AND FURTHER INFORMATION.
4. THE DESIGN HAS BEEN DRAWN ON AN ORDNANCE SURVEY BACKGROUND MAP.



**STOCKPORT**  
METROPOLITAN BOROUGH COUNCIL

HIGHWAYS AND TRANSPORTATION  
STOPFORD HOUSE  
STOCKPORT SK1 3XE  
Tel: 0161 474

**FOR FEASIBILITY**

CAROLINE SIMPSON  
CORPORATE DIRECTOR  
PLACE

B	ATC	JG	28/10/21	ROUTE ADJACENT ROYAL CRES. AMENDED AND DESIGN REVIEW COMMENTS FOR FEASIBILITY
A	HC	PH	25/11/20	
Rev.	Drawn	Checked	Date	Revision Details

DRAWN	ENGINEER	CHECKED	APPROVED
HC	DOG	PH	NW
DATE	DATE	DATE	DATE
24/11/20	25/11/20	27/11/20	13/01/21

SCALE 1:500

DRAWING NUMBER F/0600/006/002

Revision B

JOB TITLE **A34 MRN CORRIDOR IMPROVEMENT PLAN**

DRAWING TITLE **SCHEME 6 - SHEET 2 - CHEADLE ROYAL JUNCTION**