

This map is reproduced from Ordnance Survey material with the permission of Ordnance Survey on behalf of the Controller of Her Majesty's Stationery Office. Crown copyright. Unauthorised reproduction infringes Crown copyright and may lead to prosecution or civil proceedings. Stockport Metropolitan Borough Council 10001531/ 2020

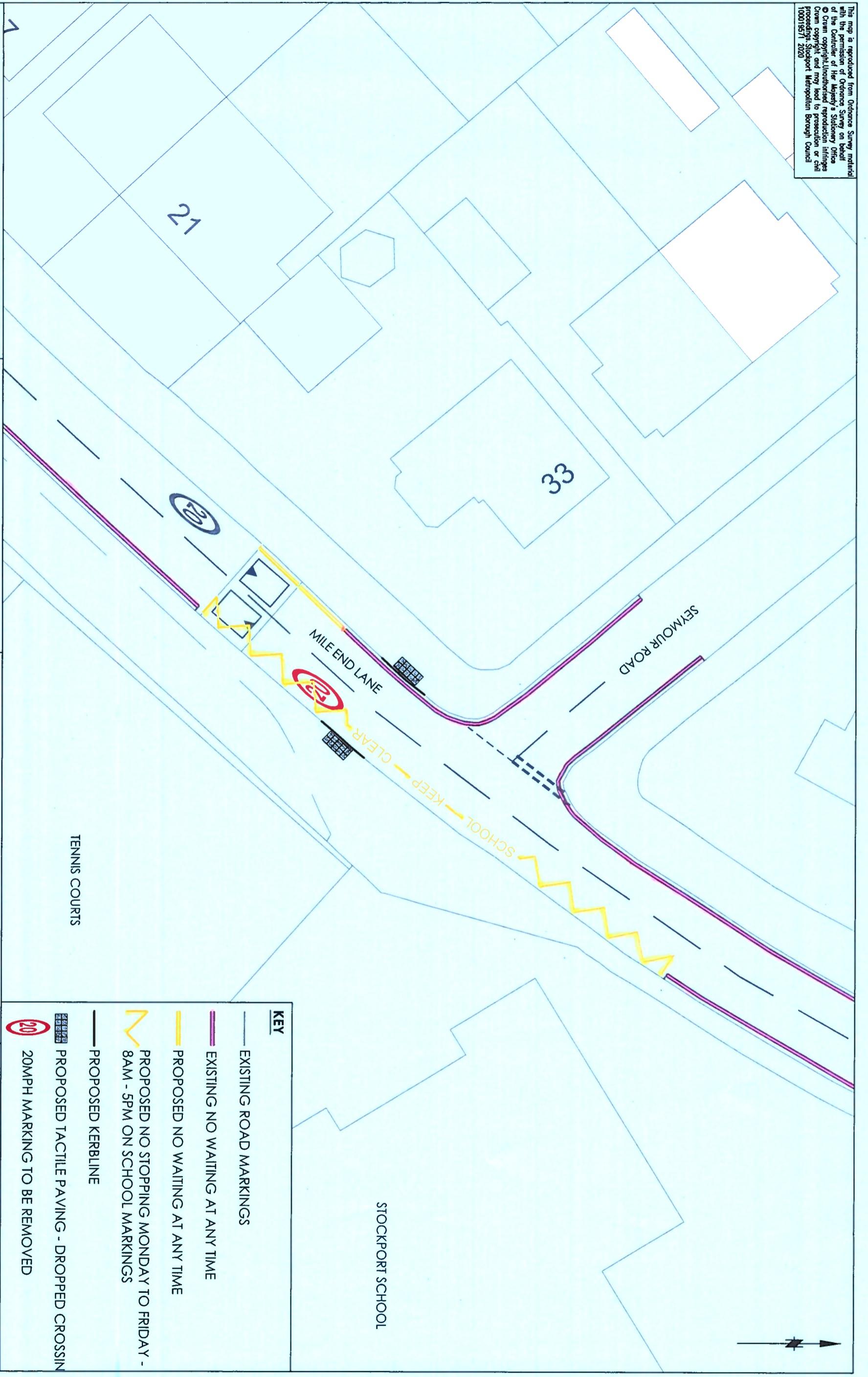

KEY

- EXISTING ROAD MARKINGS
- EXISTING NO WAITING AT ANY TIME
- PROPOSED NO WAITING AT ANY TIME
- PROPOSED NO STOPPING MONDAY TO FRIDAY - 8AM - 5PM ON SCHOOL MARKINGS
- PROPOSED KERBLINE
- PROPOSED TACTILE PAVING - DROPPED CROSSIN
- Ⓚ 20MPH MARKING TO BE REMOVED

AMENDMENTS

DRAWN	CHECKED	DATE	No	AMENDMENT

JOB TITLE

STOCKPORT SCHOOL, GREAT MOOR

DRAWING TITLE

PROPOSED TROS - 1 OF 3

Drawn	DL	Engineer	DL	Checked	DJL	Approved	
Date	08/10/21	Date	08/10/21	Date	08/10/21	Date	

Scale 1:250

Drawing No. NM8-5173-001

Revision P01

STOCKPORT
METROPOLITAN BOROUGH COUNCIL

HIGHWAYS AND TRANSPORTATION
STOCKPORT HOUSE
STOCKPORT SK1 3YE
Tel : 0161 474

CAROLINE SIMPSON
DEPUTY CHIEF EXECUTIVE