

This map is reproduced from Ordnance Survey material with the permission of Ordnance Survey on behalf of the Controller of Her Majesty's Stationery Office © Crown copyright. Unauthorised reproduction infringes Crown copyright and may lead to prosecution of civil proceedings. Stockport Metropolitan Borough Council 100019571 2021

- KEY:
- NEW FOOTWAY
 - EXISTING FOOTWAY
 - SHARED FOOTWAY / CYCLEWAY
 - CONTROLLED TACTILE PAVING
 - UNCONTROLLED TACTILE PAVING
 - PEDESTRIAN / CYCLE SIGNAL CROSSING
 - TRAFFIC CALMING FEATURE
 - CORDUROY TACTILE PAVING
 - PROPOSED VERGE/VEGETATION
 - PROPOSED NEW KERB
 - EXISTING LIGHTING COLUMN
 - NEW LIGHTING COLUMN
 - TREE TO BE REMOVED

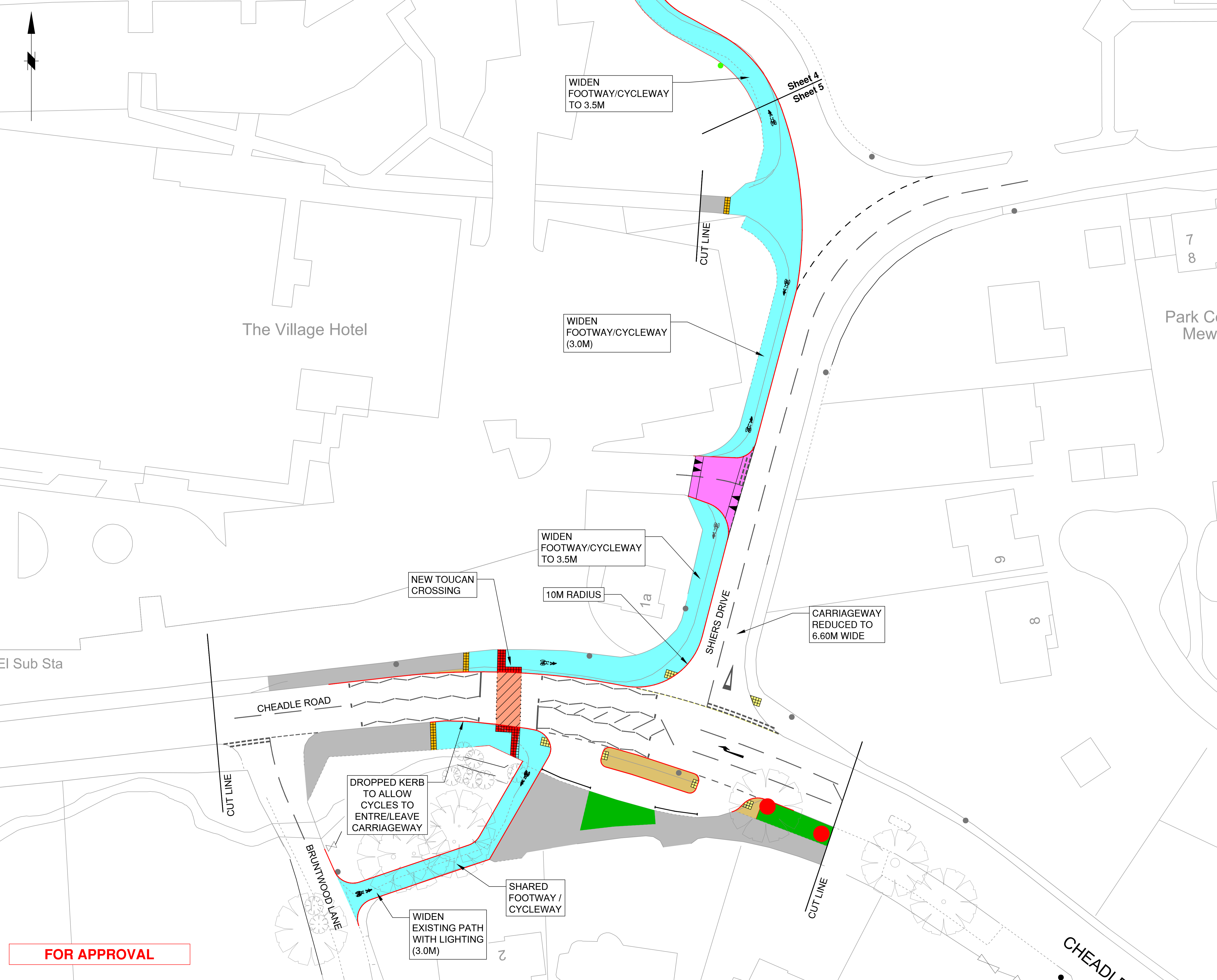
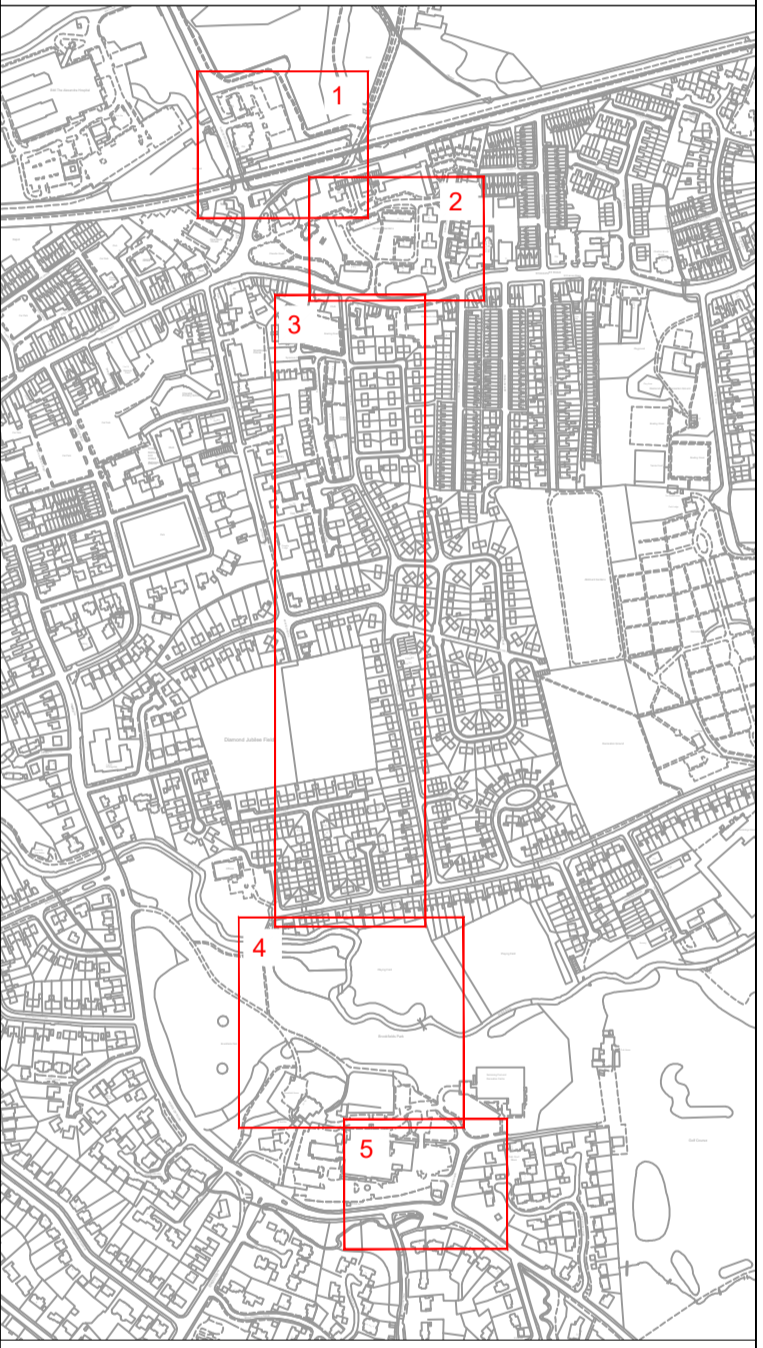

FOR APPROVAL

Rev.	Drawn	Checked	Date	Revision Details
AMENDMENTS				

STOCKPORT
METROPOLITAN BOROUGH COUNCIL
HIGHWAYS AND TRANSPORTATION
STAFFORD HOUSE
STOCKPORT SK5 3JZ
TEL 0161 474

**CHEADLE TOWNS FUND
WALKING & CYCLING PROPOSALS
CONSULTATION**

Drawing Title
**SHIERS DRIVE TO
BRUNTWOD LANE
(SHEET 5 OF 5)**

Drawn	Engineer	Checked	Approved
GPL	KF	KF	NDW
Date	Date	Date	Date
07/10/21	07/10/21	07/10/21	15/10/21
Size	Scale		
A1	1:500@A1		
Drawing No.			Revision
F/0292/A/100/005			