

This map is reproduced from Ordnance Survey material with the permission of Ordnance Survey on behalf of the Controller of Her Majesty's Stationery Office © Crown copyright. Unauthorised reproduction infringes Crown copyright and may lead to prosecution or civil proceedings. Stockport Metropolitan Borough Council 100019571 2019

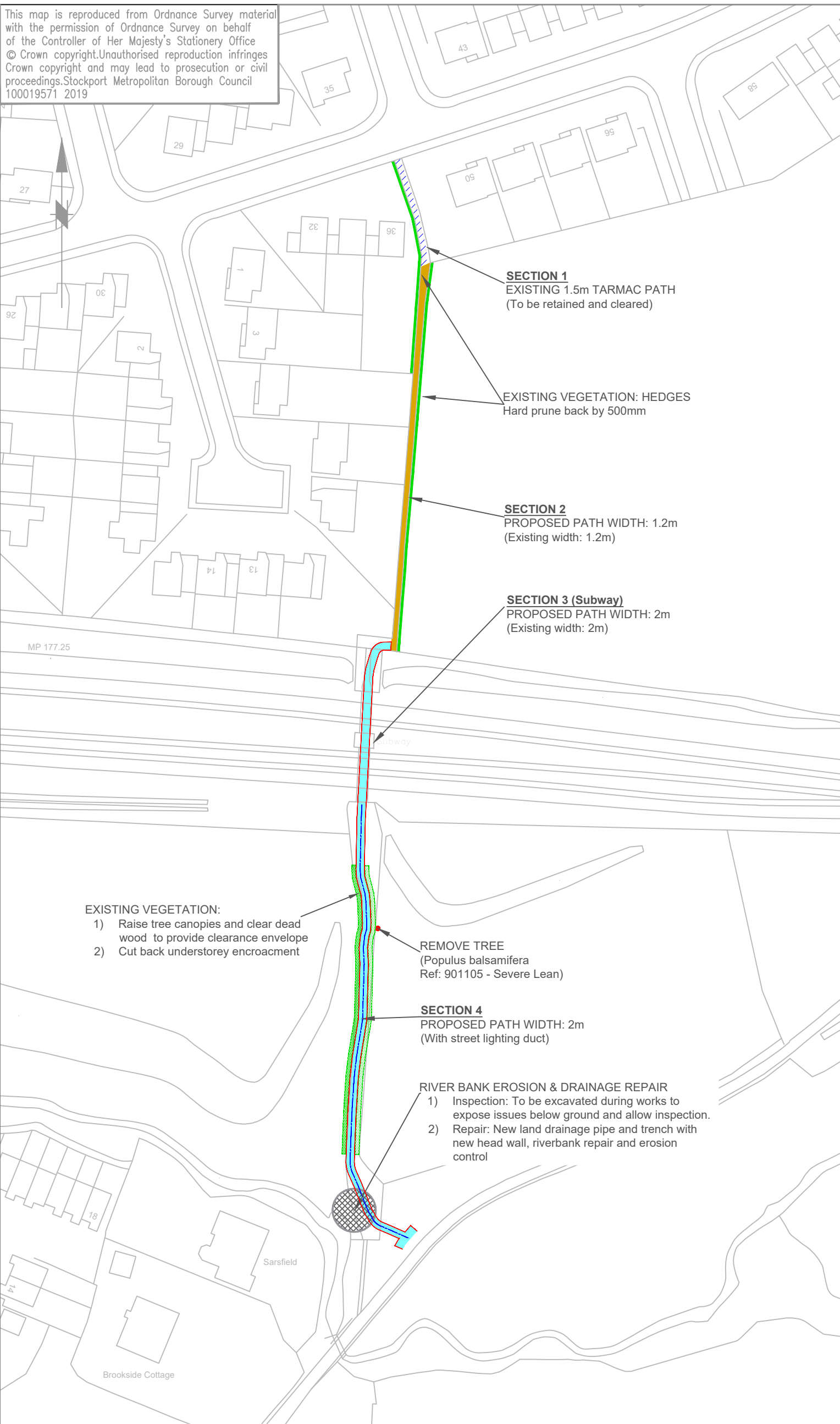

KEY	
	Proposed Timber Edge Standard Detail: STP/NH/01
	Proposed Footpath Surface Flexipave Standard Detail: STP/NH/02
	Proposed Footpath Surface Ultitrec (Surface dressing)
	Existing Tarmac Footpath To be retained Surface to be cleared
	Proposed Street Lighting Duct

- EXISTING VEGETATION:
- 1) Raise tree canopies and clear dead wood to provide clearance envelope
  - 2) Cut back understorey encroachment

REMOVE TREE  
(Populus balsamifera  
Ref: 901105 - Severe Lean)

SECTION 4  
PROPOSED PATH WIDTH: 2m  
(With street lighting duct)

- RIVER BANK EROSION & DRAINAGE REPAIR
- 1) Inspection: To be excavated during works to expose issues below ground and allow inspection.
  - 2) Repair: New land drainage pipe and trench with new head wall, riverbank repair and erosion control

Rev.	Drawn	Checked	Date	Revision Details



**STOCKPORT**  
METROPOLITAN BOROUGH COUNCIL

HIGHWAYS AND TRANSPORTATION  
STOPFORD HOUSE  
STOCKPORT SK1 3XE  
Tel: 0161 474 4503

CAROLINE SIMPSON  
CORPORATE DIRECTOR  
PLACE

JOB TITLE

A6MARR CMM - Hazel Grove (PROW 77)

DRAWN TB	ENGINEER TB	CHECKED AM	APPROVED NW
DATE 18/10/21	DATE 18/10/21	DATE 02/11/21	DATE 05/11/21
SCALE 1:1000		SCG No.	
DRAWING NUMBER F/1015A/0000/001			Revision
DRAWING TITLE GENERAL ARRANGEMENT			