

This map is reproduced from Ordnance Survey material with the permission of Ordnance Survey on behalf of the Controller of Her Majesty's Stationery Office © Crown copyright. Unauthorised reproduction infringes Crown copyright and may lead to prosecution or civil proceedings. Stockport Metropolitan Borough Council 100019571 2020

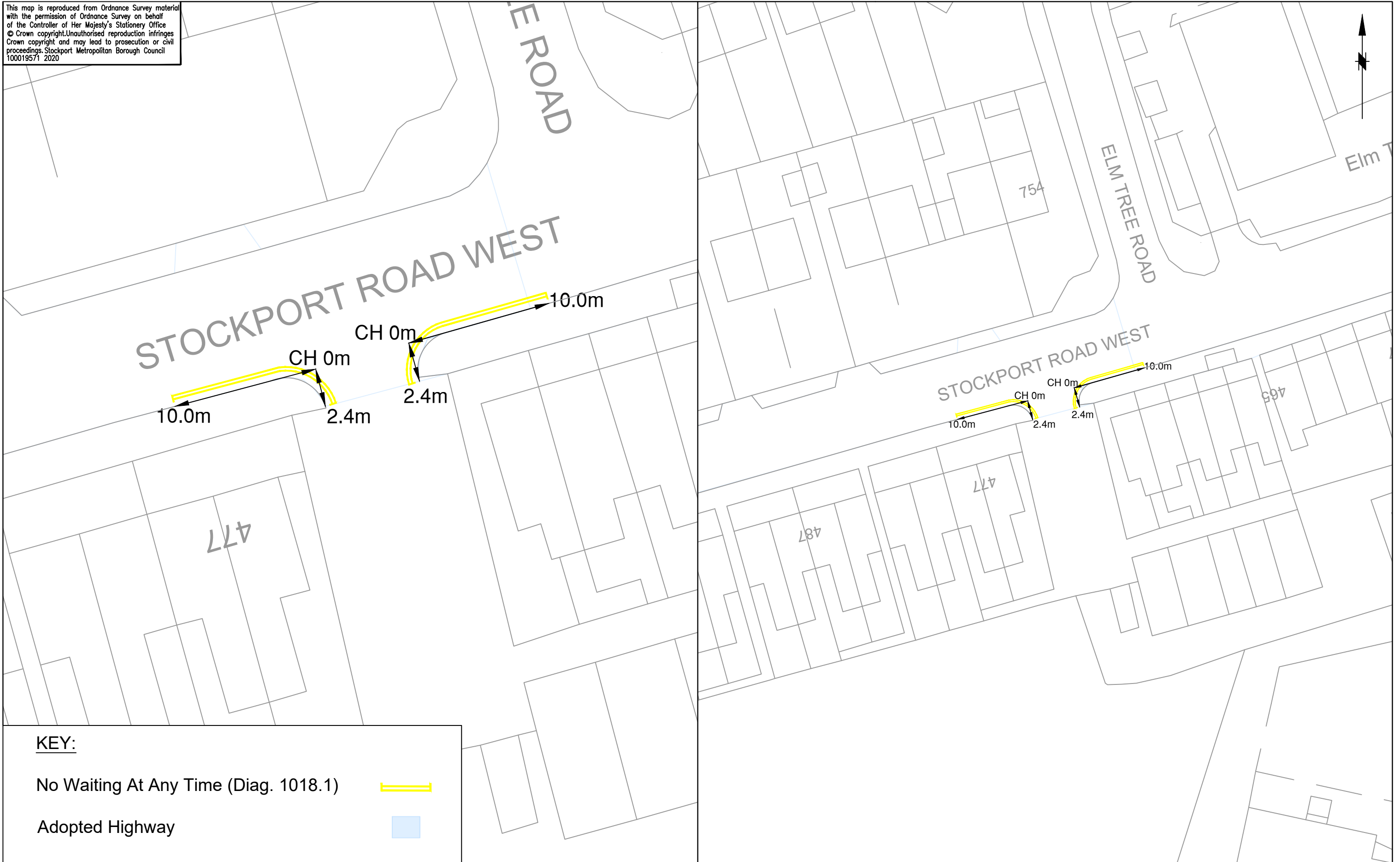

KEY:

No Waiting At Any Time (Diag. 1018.1)



Adopted Highway



STOCKPORT

METROPOLITAN BOROUGH COUNCIL

HIGHWAYS AND TRANSPORTATION
STOPFORD HOUSE
STOCKPORT SK1 3XE
Tel : 0161 474

CAROLINE SIMPSON
CORPORATE DIRECTOR
PLACE

AMENDMENTS

DRAWN	CHECKED	DATE	No	AMENDMENT

JOB TITLE

NM8 5170: 475 - 477 Stockport Road West

DRAWING TITLE

No Waiting At Any Time

Drawn AD	Engineer AD	Checked NR	Approved JB
Date 08/21	Date 08/21	Date 08/21	Date 08/21
Scale 1:250 & 1:500 @ A3			
Drawing No. NM8-5170-001			Revision

This map is reproduced from Ordnance Survey material with the permission of Ordnance Survey on behalf of the Controller of Her Majesty's Stationery Office © Crown copyright. Unauthorised reproduction infringes Crown copyright and may lead to prosecution or civil proceedings. Stockport Metropolitan Borough Council 100019571 2021



KEY:

No Waiting At Any Time
Parking Restrictions
(Double Yellow Lines)



STOCKPORT

METROPOLITAN BOROUGH COUNCIL

HIGHWAYS AND TRANSPORTATION
STOPFORD HOUSE
STOCKPORT SK1 3XE
Tel : 0161 474

CAROLINE SIMPSON
CORPORATE DIRECTOR
PLACE

AMENDMENTS

DRAWN	CHECKED	DATE	No	AMENDMENT

JOB TITLE

Elm Tree Road, Bredbury

DRAWING TITLE



No Waiting At Any Time Restrictions



PHOTO SHOWING TRANSITION KERB AT FARM ENTRANCE

Drawn AD	Engineer AD	Checked JP	Approved JB
Date 05/21	Date 05/21	Date 05/21	Date 05/21
Scale 1:500 @ A3			
Drawing No. NM8-5164-01			Revision

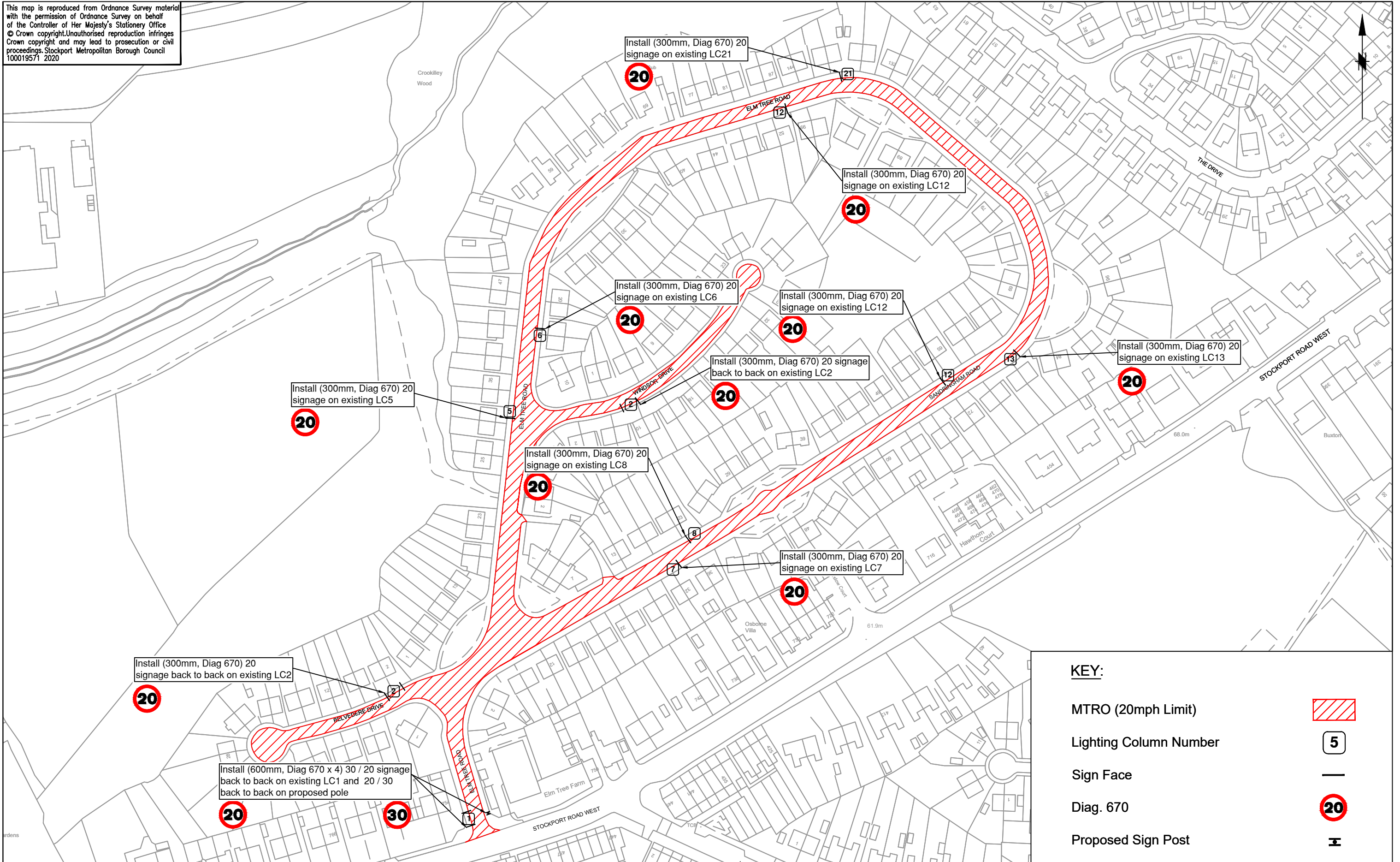
This map is reproduced from Ordnance Survey material with the permission of Ordnance Survey on behalf of the Controller of Her Majesty's Stationery Office © Crown copyright. Unauthorised reproduction infringes Crown copyright and may lead to prosecution or civil proceedings. Stockport Metropolitan Borough Council 100019571 2020

STOCKPORT
METROPOLITAN BOROUGH COUNCIL
HIGHWAYS AND TRANSPORTATION
STOPFORD HOUSE
STOCKPORT SK1 3XE
Tel : 0161 474

CAROLINE SIMPSON
CORPORATE DIRECTOR
PLACE

AMENDMENTS				
DRAWN	CHECKED	DATE	No	AMENDMENT

JOB TITLE
Elm Tree Road and Surrounding Roads

DRAWING TITLE
MTRO (20mph Limit) PROPOSED SIGNAGE LAYOUT

Drawn AD Date 05/21	Engineer AD Date 05/21	Checked JP Date 05/21	Approved JB Date 05/21
Scale NTS - A3			
Drawing No. NM8/5163/01			Revision