

This map is reproduced from Ordnance Survey material with the permission of Ordnance Survey on behalf of the Controller of Her Majesty's Stationery Office © Crown copyright. Unauthorised reproduction infringes Crown copyright and may lead to prosecution or civil proceedings. Stockport Metropolitan Borough Council 100019571 2020

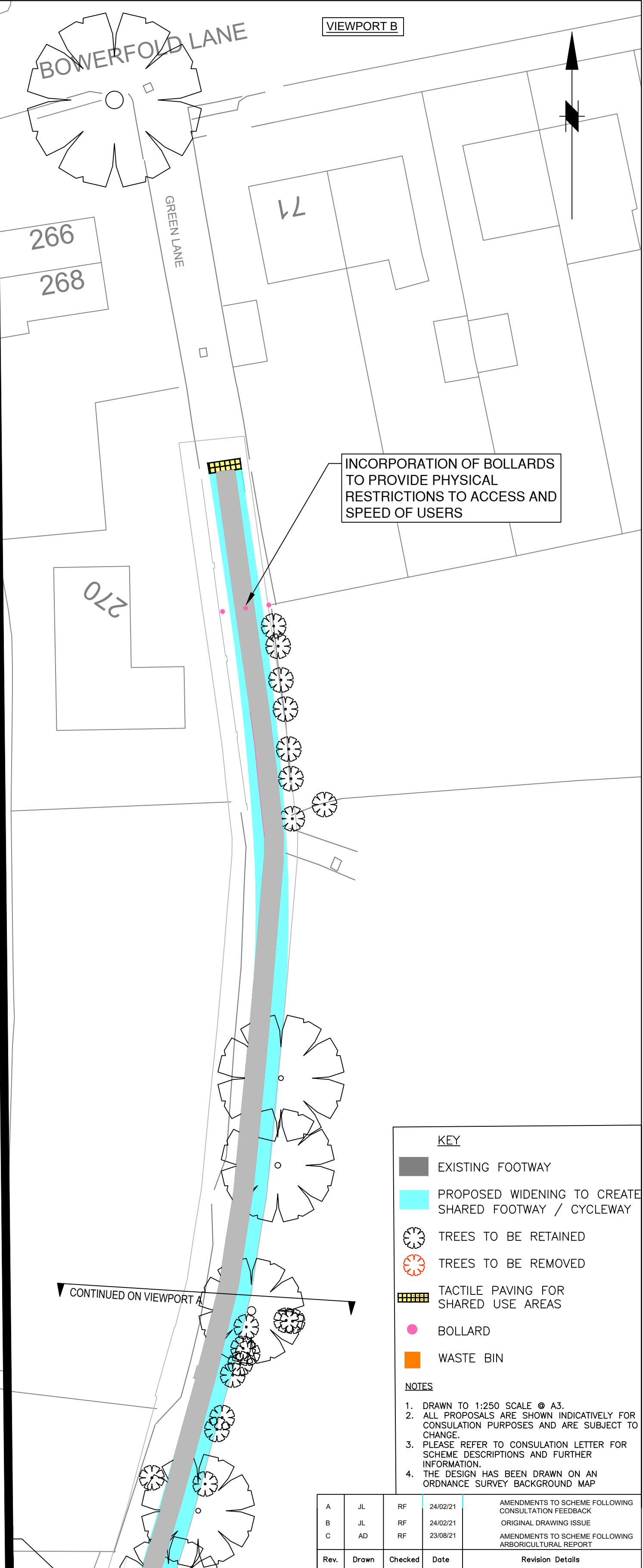
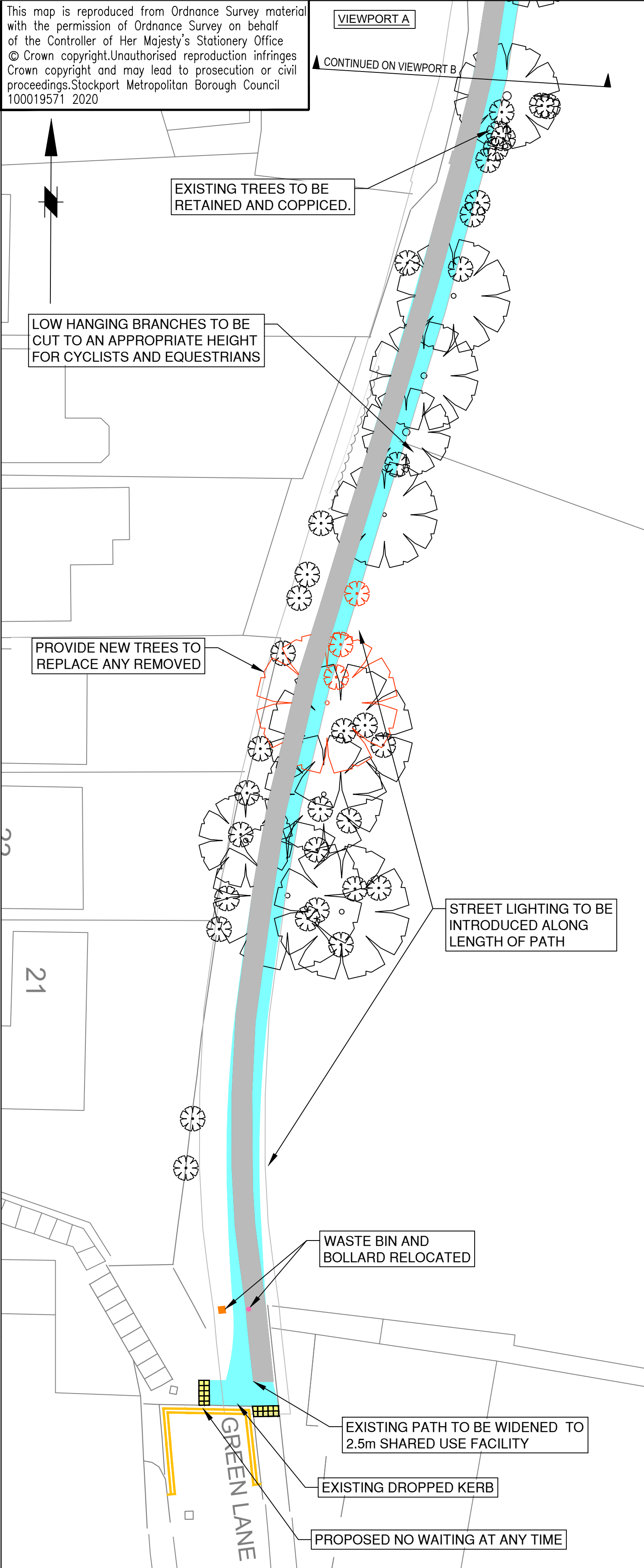

**KEY**

- EXISTING FOOTWAY
- PROPOSED WIDENING TO CREATE SHARED FOOTWAY / CYCLEWAY
- TREES TO BE RETAINED
- TREES TO BE REMOVED
- TACTILE PAVING FOR SHARED USE AREAS
- BOLLARD
- WASTE BIN

**NOTES**

- DRAWN TO 1:250 SCALE @ A3.
- ALL PROPOSALS ARE SHOWN INDICATIVELY FOR CONSULTATION PURPOSES AND ARE SUBJECT TO CHANGE.
- PLEASE REFER TO CONSULTATION LETTER FOR SCHEME DESCRIPTIONS AND FURTHER INFORMATION.
- THE DESIGN HAS BEEN DRAWN ON AN ORDNANCE SURVEY BACKGROUND MAP

A	JL	RF	24/02/21	AMENDMENTS TO SCHEME FOLLOWING CONSULTATION FEEDBACK
B	JL	RF	24/02/21	ORIGINAL DRAWING ISSUE
C	AD	RF	23/08/21	AMENDMENTS TO SCHEME FOLLOWING ARBORICULTURAL REPORT
Rev.	Drawn	Checked	Date	Revision Details



**STOCKPORT**  
METROPOLITAN BOROUGH COUNCIL

**FOR  
FEASIBILITY**

HIGHWAYS AND TRANSPORTATION  
STOPFORD HOUSE  
STOCKPORT SK1 3UR  
Tel: 0161 474 4908

CAROLINE SIMPSON  
DEPUTY CHIEF EXECUTIVE

JOB TITLE

**LSH FOOTPATH IMPROVEMENTS**

DRAWN AD	ENGINEER AD	CHECKED RF	APPROVED RF
DATE 23/08/21	DATE 23/08/21	DATE 23/08/21	DATE 23/08/21
SCALE 1:250 @ A2			
DRAWING NUMBER 5180/001/FP			Revision C
DRAWING TITLE <b>GREEN LANE SHARED FOOTWAY / CYCLEWAY</b>			