

Rev						Date						Drawn By						Checked By						Rev						Date						Revision Notes						Drawn By						Checked By						Rev						Date						Revision Notes						Drawn By						Checked By						Drawing Status						Suitability						Drawing No:						Rev:																																																																																																																																																																																																																																																																																																																																																																																																																																																																																																																																																																																																																																																																																																																																																																																																																																																																																																																																																																																																																																																																																																																																																																																																																																																																																																																																																																																																																																																																																																																																																																																																																																																																																																																																																																																																																																																																																																																																																																																																																																																																																																																																																																																																																																																																																																																																																																																																																																																																																																																																																																																																																																																																																																																																																																																																																																																																																																																																																																																																																																																																																																																																																																																																																																																																																																																																																																																																																																																																																																																																																																																																																																																																																																																																																																																																																																															
P1						17/12/15						ISSUED FOR PLANNING						CP						PR																																																																																																																																																																																																																																																																																																																																																																																																																																																																																																																																																																																																																																																																																																																																																																																																																																																																																																																																																																																																																																																																																																																																																																																																																																																																																																																																																																																																																																																																																																																																																																																																																																																																																																																																																																																																																																																																																																																																																																																																																																																																																																																																																																																																																																																																																																																																																																																																																																																																																																																																																																																																																																																																																																																																																																																																																																																																																																																																																																																																																																																																																																																																																																																																																																																																																																																																																																																																																																																																																																																																																																																																																																																																																																																																																																																																																																																																																																																													

Do not scale this drawing
Do not derive dimensions from digital media

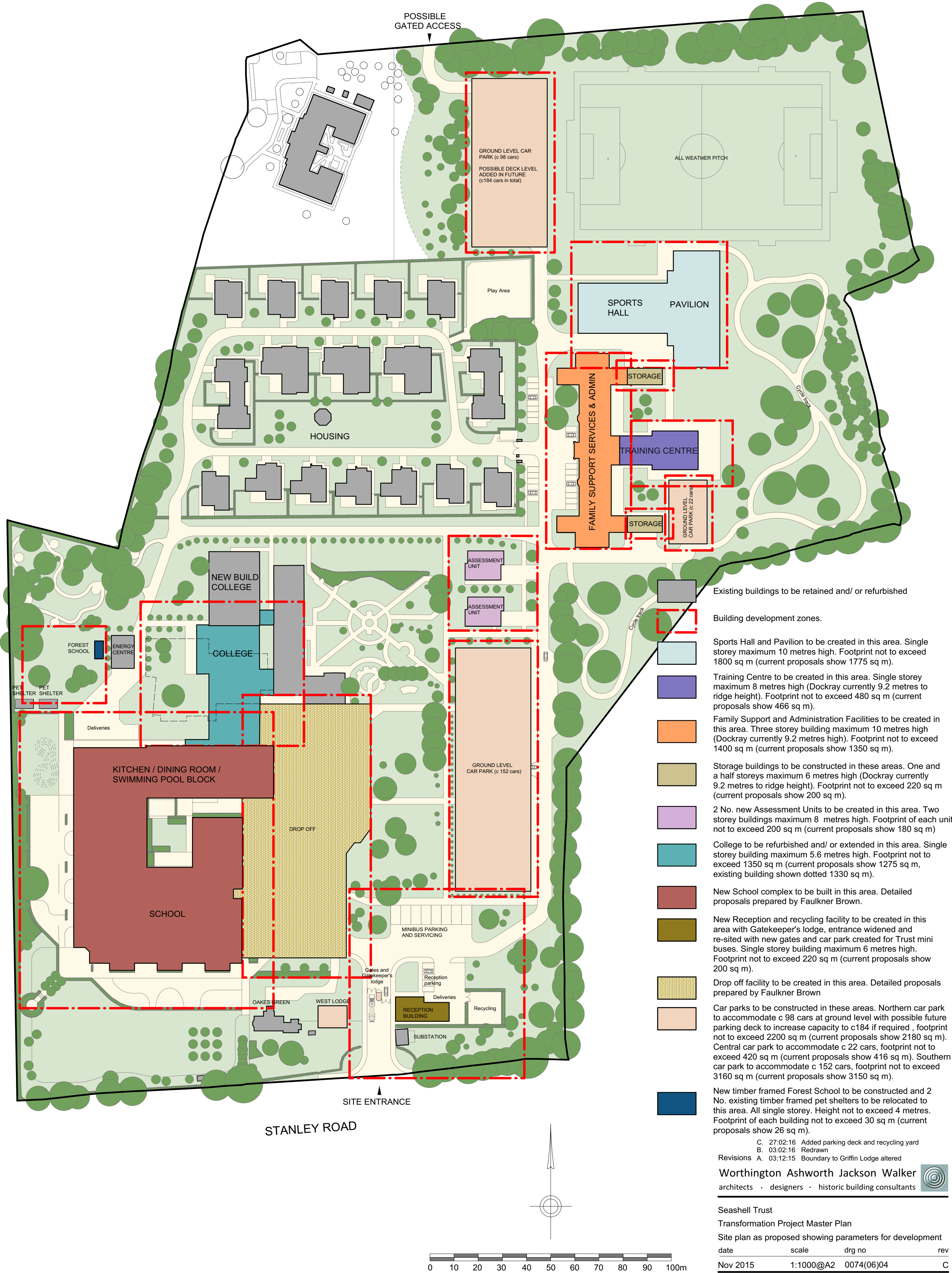

- Site Hoarding
- Construction of new School, Shared Services Wing.
- Creation of new drop off area to serve School and College.
- Haul road created for construction of School retained and hoarded off for later refurbishment / construction of College.
- Remnants of one way system and temporary car park created to facilitate construction of drop off area, retained pending construction of main car park.
- Temporary car park constructed to north of site.
- Temporary car park constructed to south of Dockray.
- OUTLINE CONSENT CURRENTLY SOUGHT

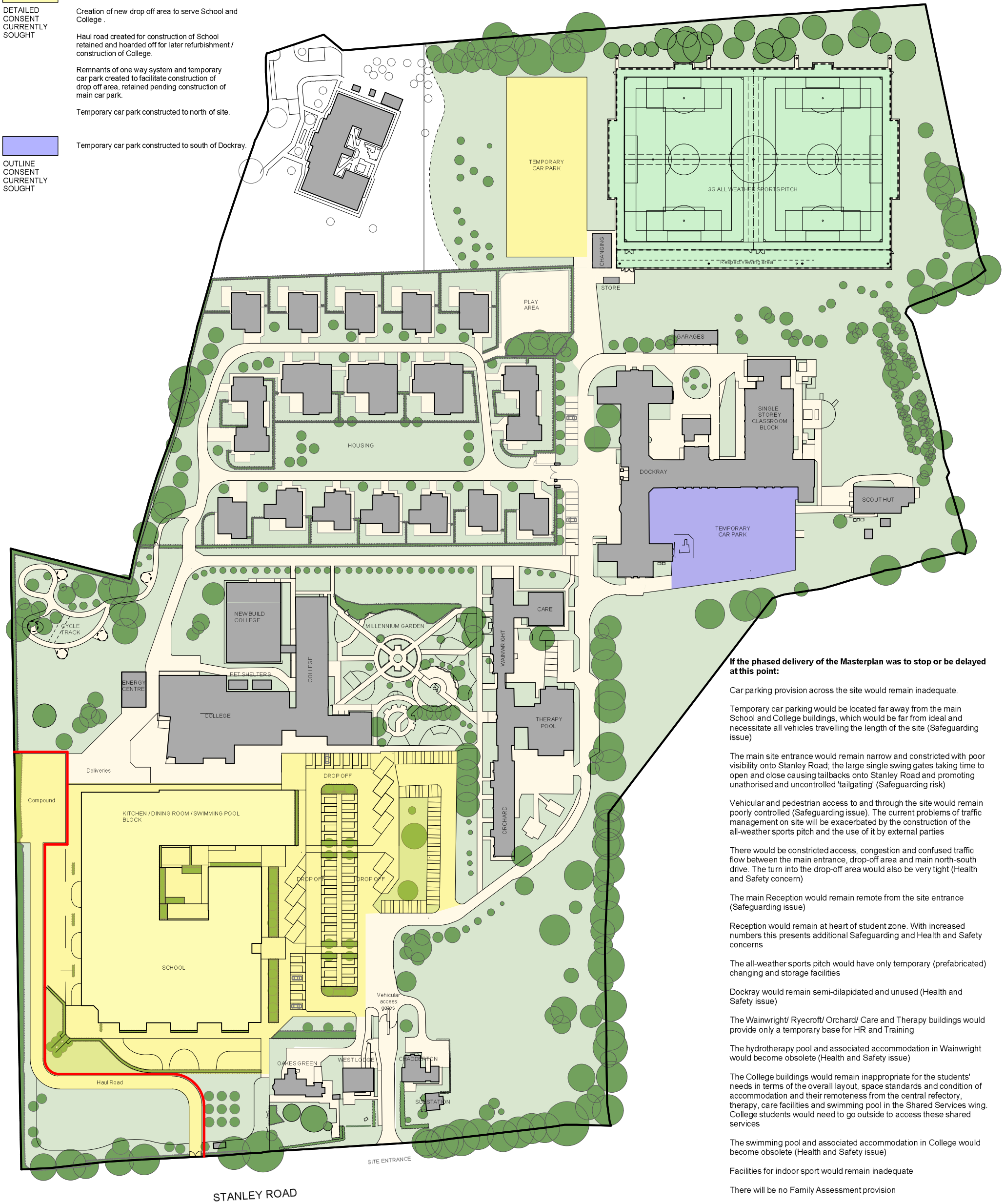

If the phased delivery of the Masterplan was to stop or be delayed at this point:

- Car parking provision across the site would remain inadequate.
- Temporary car parking would be located far away from the main School and College buildings, which would be far from ideal and necessitate all vehicles travelling the length of the site (Safeguarding issue)
- The main site entrance would remain narrow and constricted with poor visibility onto Stanley Road; the large single swing gates taking time to open and close causing tailbacks onto Stanley Road and promoting unauthorised and uncontrolled 'tailgating' (Safeguarding risk)
- Vehicular and pedestrian access to and through the site would remain poorly controlled (Safeguarding issue). The current problems of traffic management on site will be exacerbated by the construction of the all-weather sports pitch and the use of it by external parties
- There would be constricted access, congestion and confused traffic flow between the main entrance, drop-off area and main north-south drive. The turn into the drop-off area would also be very tight (Health and Safety concern)
- The main Reception would remain remote from the site entrance (Safeguarding issue)
- Reception would remain at heart of student zone. With increased numbers this presents additional Safeguarding and Health and Safety concerns
- The all-weather sports pitch would have only temporary (prefabricated) changing and storage facilities
- Dockray would remain semi-dilapidated and unused (Health and Safety issue)
- The Wainwright/ Ryecroft/ Orchard/ Care and Therapy buildings would provide only a temporary base for HR and Training
- The hydrotherapy pool and associated accommodation in Wainwright would become obsolete (Health and Safety issue)
- The College buildings would remain inappropriate for the students' needs in terms of the overall layout, space standards and condition of accommodation and their remoteness from the central refectory, therapy, care facilities and swimming pool in the Shared Services wing. College students would need to go outside to access these shared services
- The swimming pool and associated accommodation in College would become obsolete (Health and Safety issue)
- Facilities for indoor sport would remain inadequate
- There will be no Family Assessment provision
- There would be no centralised refuse collection/ recycling facility
- There would be no Forest School

C. 09.03.17 Drawing revised to show phases of detailed and outline consent
B. 10.02.17 Issued for Planning
A. 08.02.17 Amended in line with MA comments

Revisions

Worthington Ashworth Jackson Walker
architects • designers • historic building consultants

Seashell Trust
Master plan principle phases of development
SITE PLAN AS PROPOSED - PHASE B - SCHOOL

date	scale	drg no	rev
Feb 17	1:1000@A2	0074(06)102	C

Orchard, Wainwright, Therapy and Care Suite demolished and temporary car parks removed to make way for new (south) car park, up to 2No Assessment Units and completion of landscaping to central portion of site.

OUTLINE CONSENT CURRENTLY SOUGHT

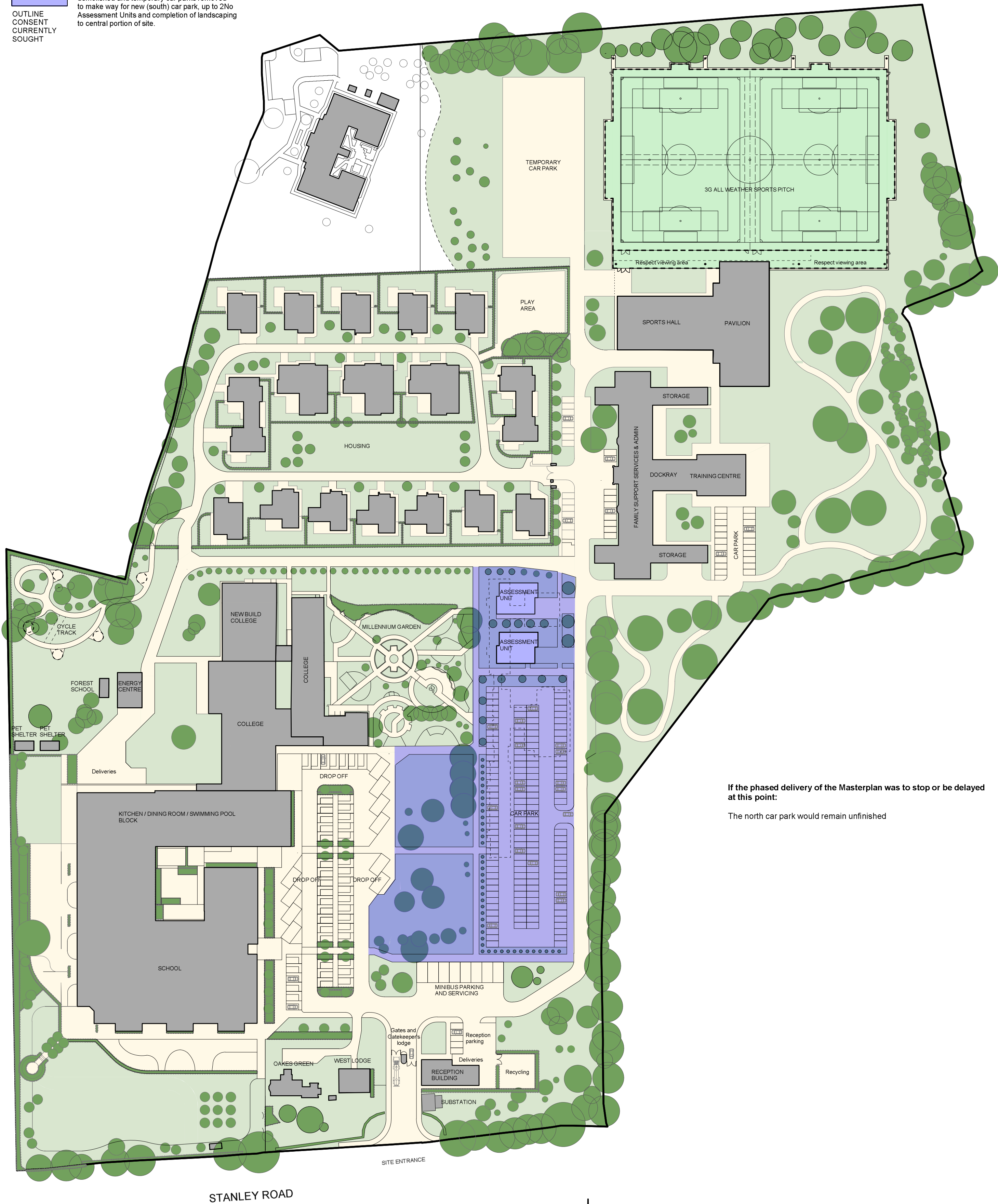

If the phased delivery of the Masterplan was to stop or be delayed at this point:
The north car park would remain unfinished

C. 09.03.17 Drawing revised to show phases of detailed and outline consent
B. 10.02.17 Issued for Planning
A. 08.02.17 Amended in line with MA comments

Revisions

Worthington Ashworth Jackson Walker

architects • designers • historic building consultants

Seashell Trust

Master plan principle phases of development

SITE PLAN AS PROPOSED - PHASE G - SOUTH CAR PARK

date	scale	drg no	rev
Feb 17	1:1000@A2	0074(06)107	C

Carrwood House • 109 Shaw Heath • Stockport • SK2 6QH • 0161 477 2616 • info@wajw.co.uk

OUTLINE
CONSENT
CURRENTLY
SOUGHT

Converting temporary car park to north of site
to a permanent facility with road link and access
gate to northern site boundary.

Landscaping to mounded area to the west with
associated tree planting

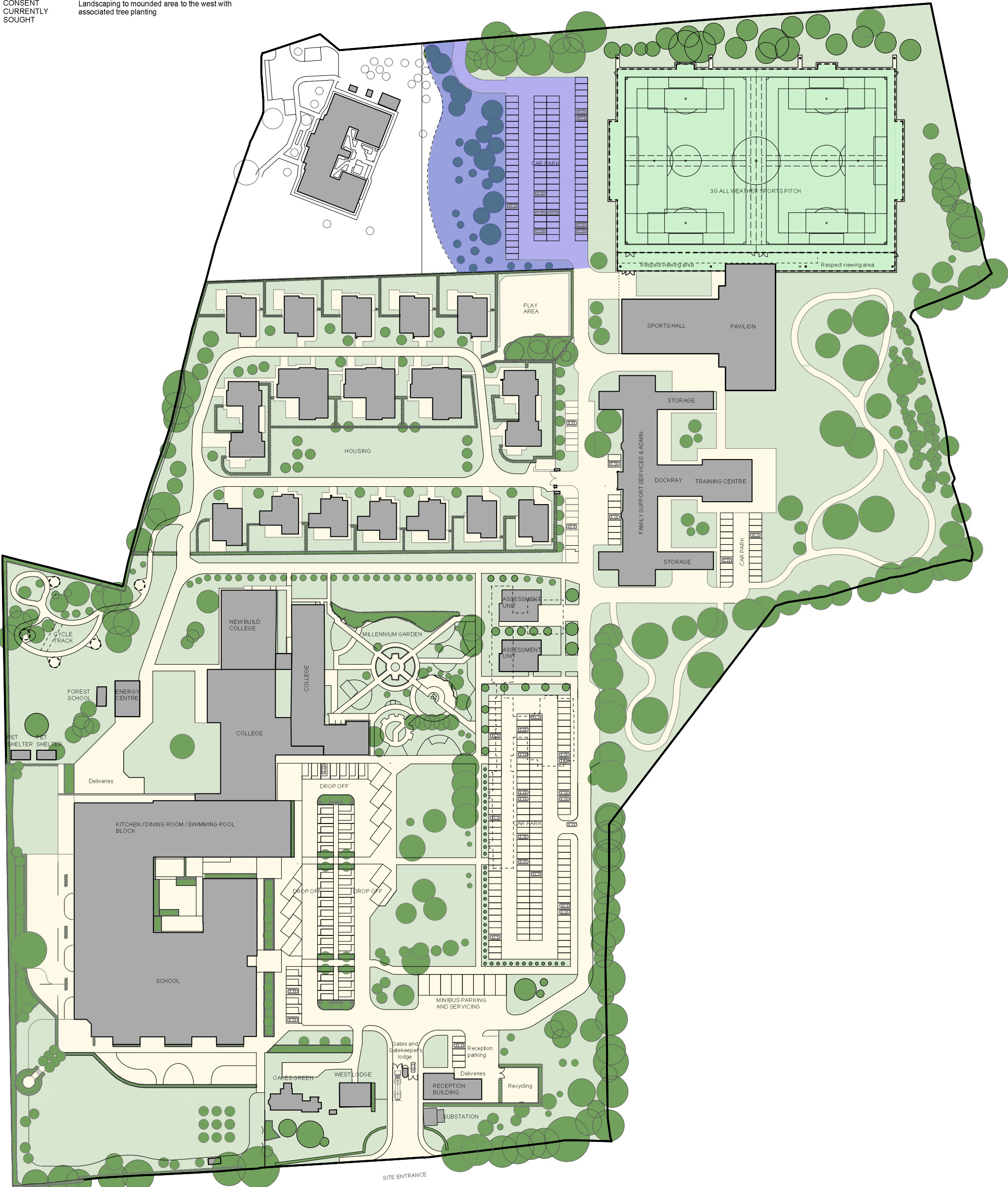

STANLEY ROAD

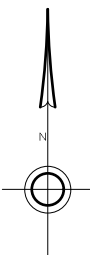

C. 09.03.17 Drawing revised to show phases of detailed and outline consent
B. 10.02.17 Issued for Planning
A. 08.02.17 Amended in line with MA comments

Revisions

Worthington Ashworth Jackson Walker
architects • designers • historic building consultants



Seashell Trust
Master plan principle phases of development
SITE PLAN AS PROPOSED - PHASE H - NORTH CAR PARK
date scale drg no rev
Feb 17 1:1000@A2 0074(06)108 C