

TP23 - Existing

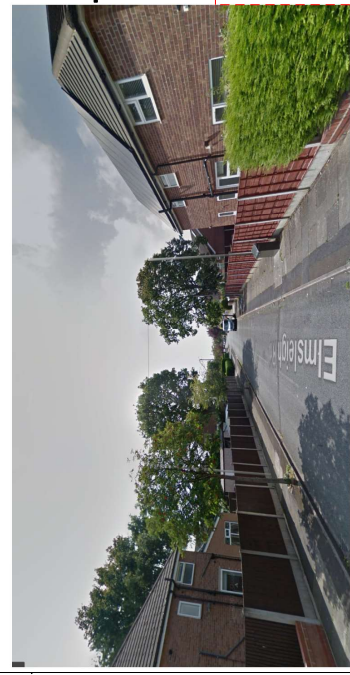

TP23 - Proposed

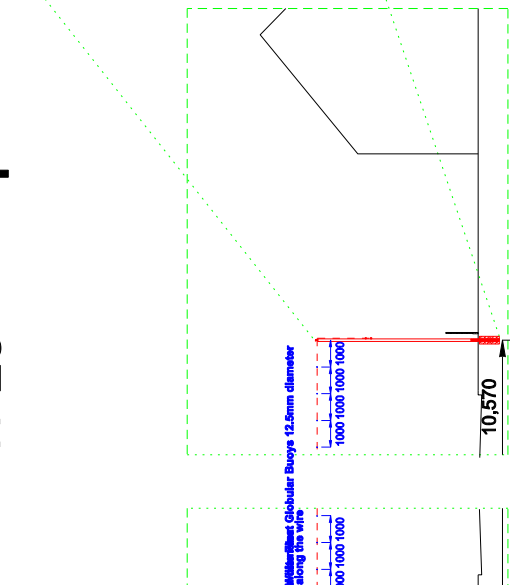
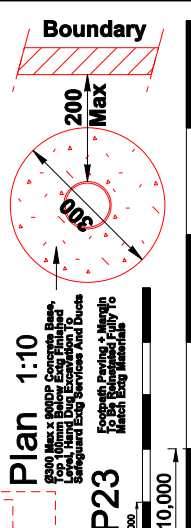
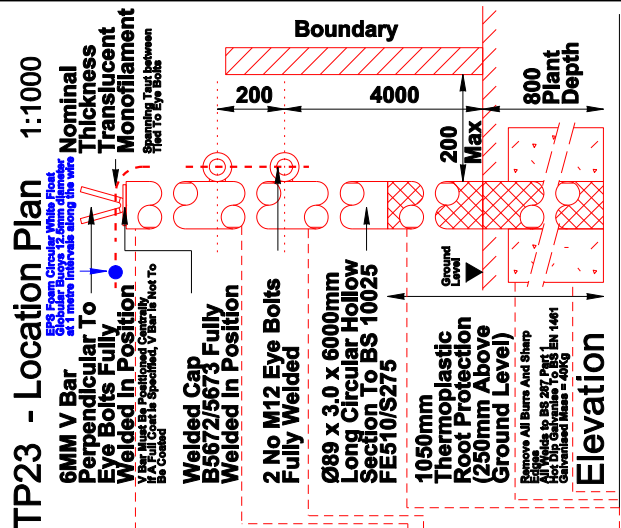
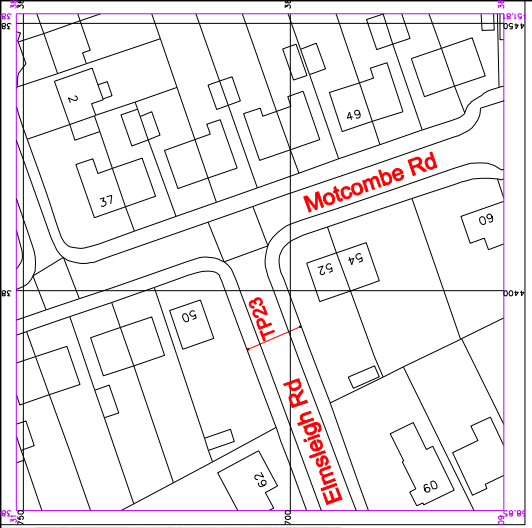

TP23 - Elevation
1:200

TP23

TP23 - Plan
1:50

Erection of street furniture in 33 locations, including steel poles, clear nylon wire, arches and posts in association with an Eruv

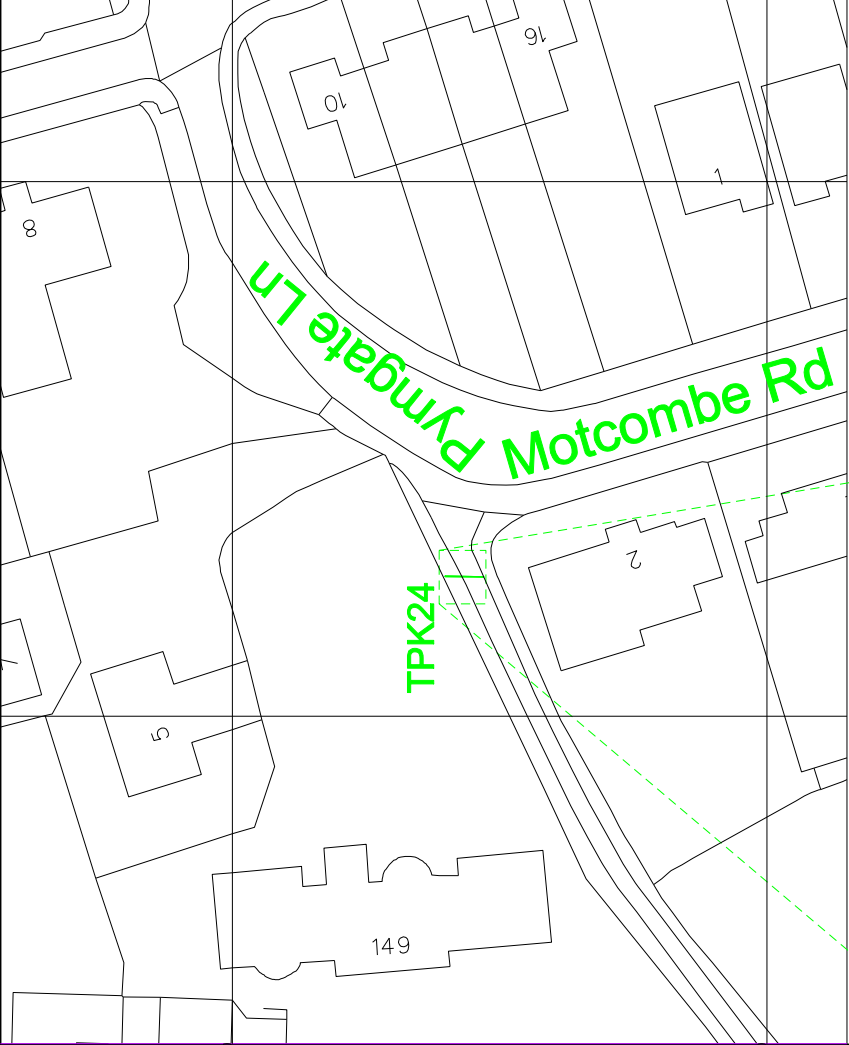

TPK24 - Site Plan 1:500

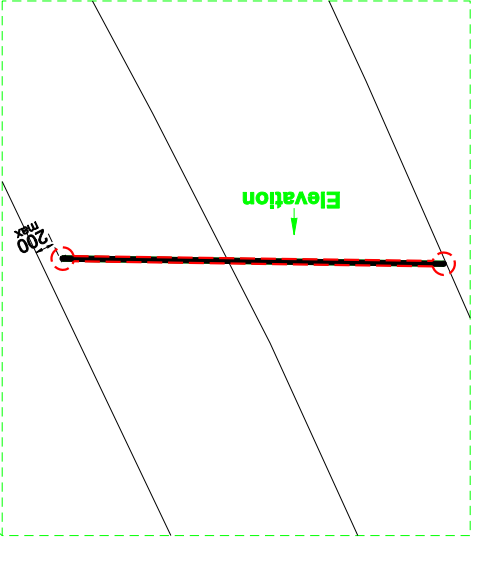

TPK24 - Plan 1:50

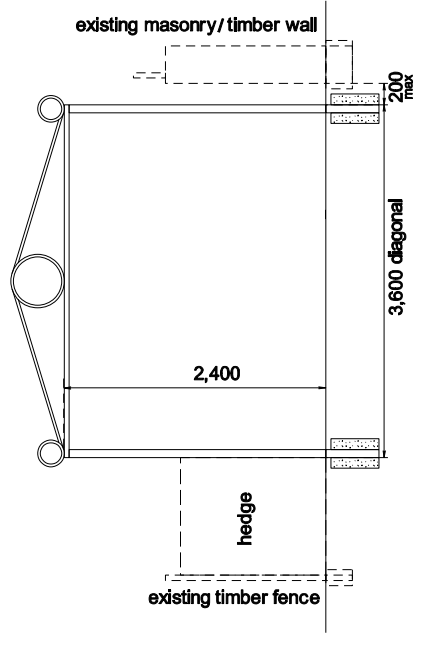

TPK24 - Elevation 1:50



TPK24 - Existing

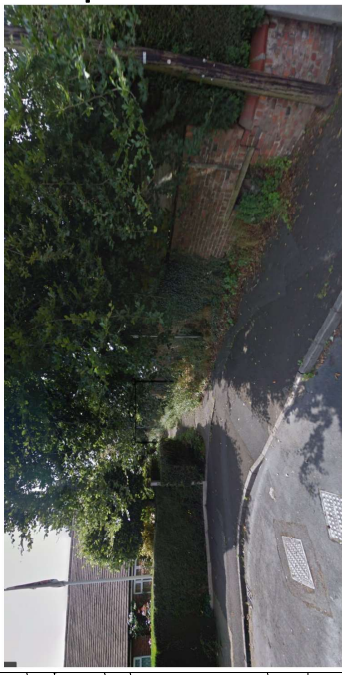

TPK24 - Proposed

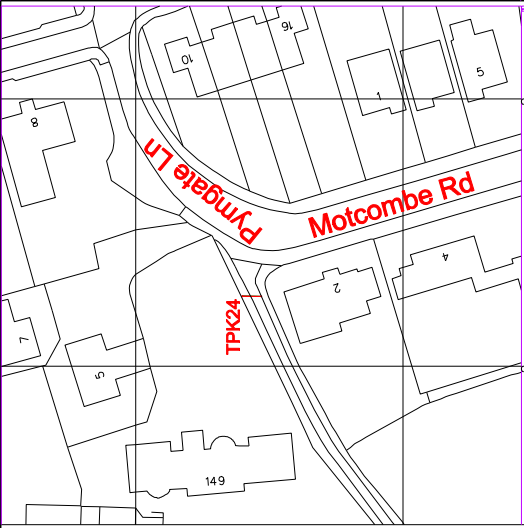

TPK24 - Location Plan 1:1000



1:1000



1:500



TPK24

TPK across footpath at corner of Pymgate Ln
 2400mm High by 75mm Dia -
 Galvanised Steel posts
 and wrought iron scrollwork atop
 with Black Powder Coating

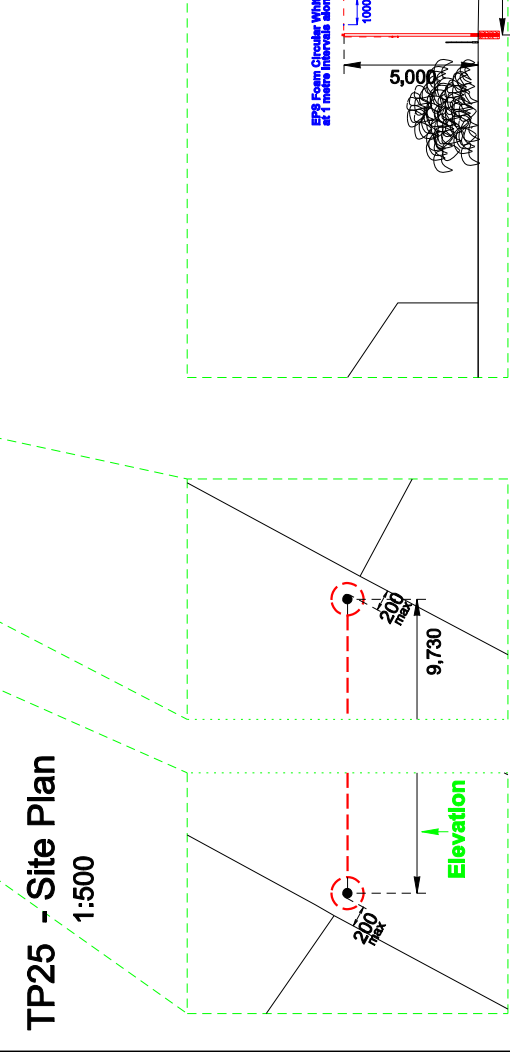
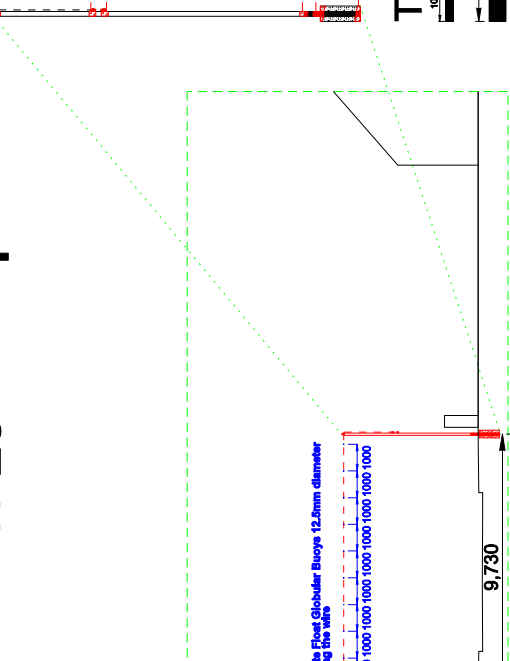
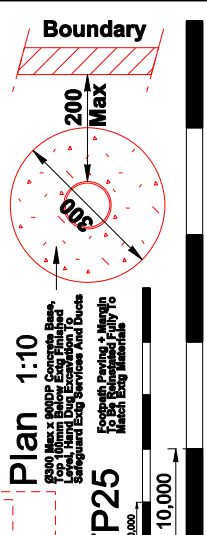
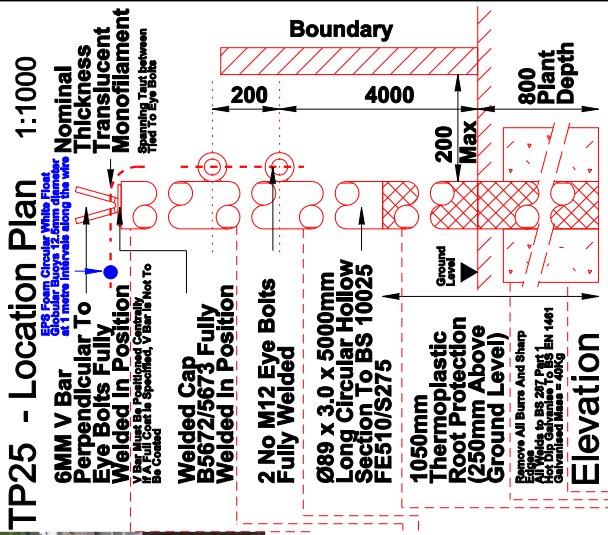
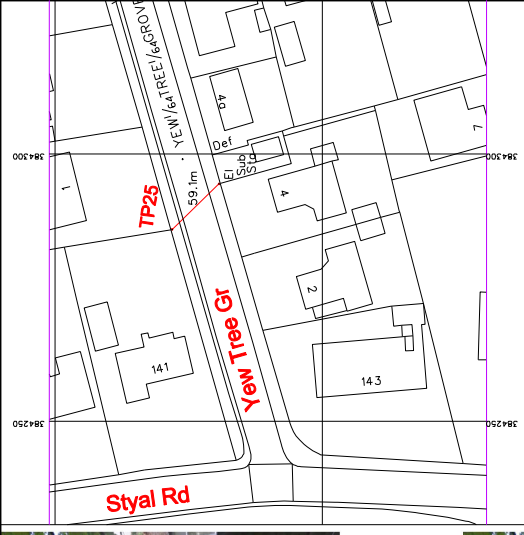
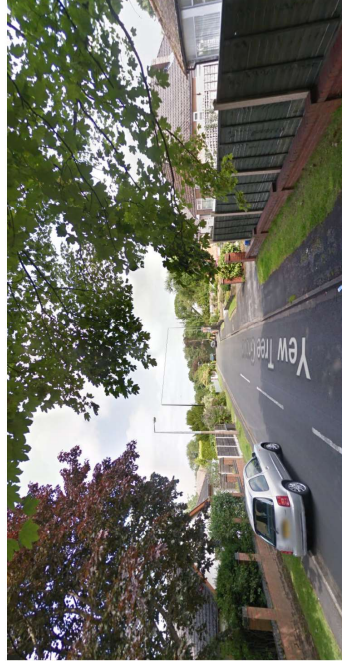
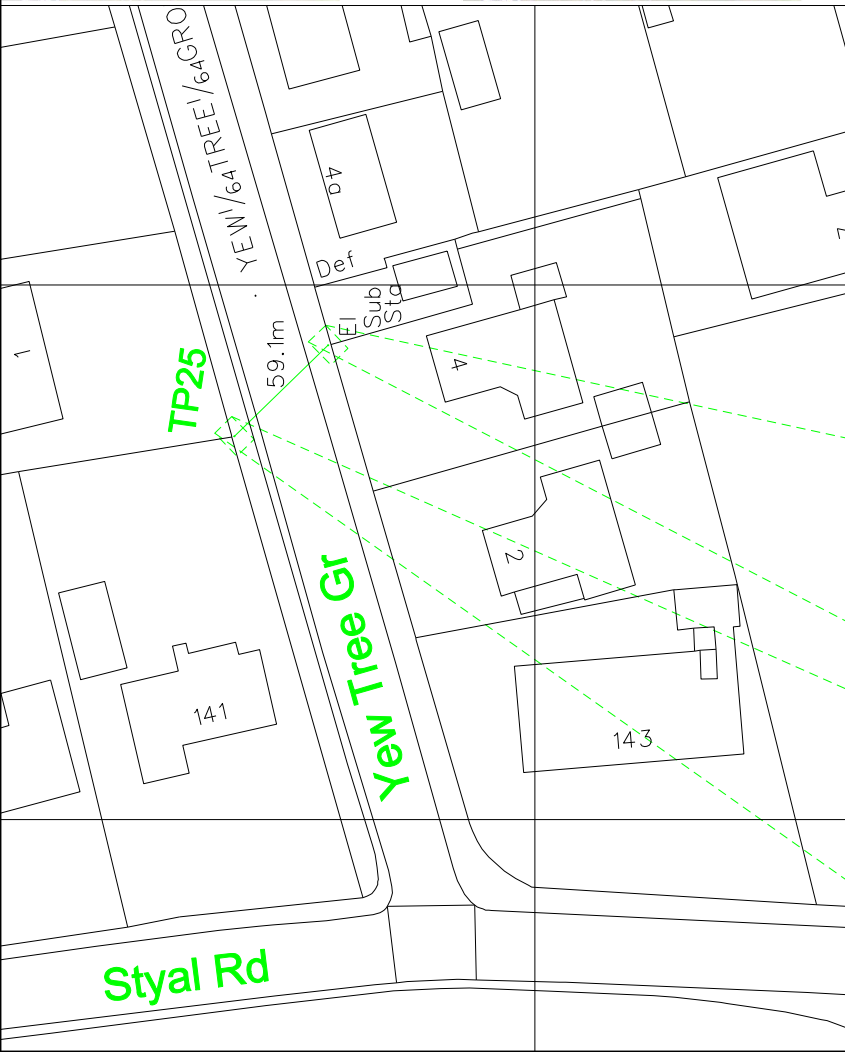

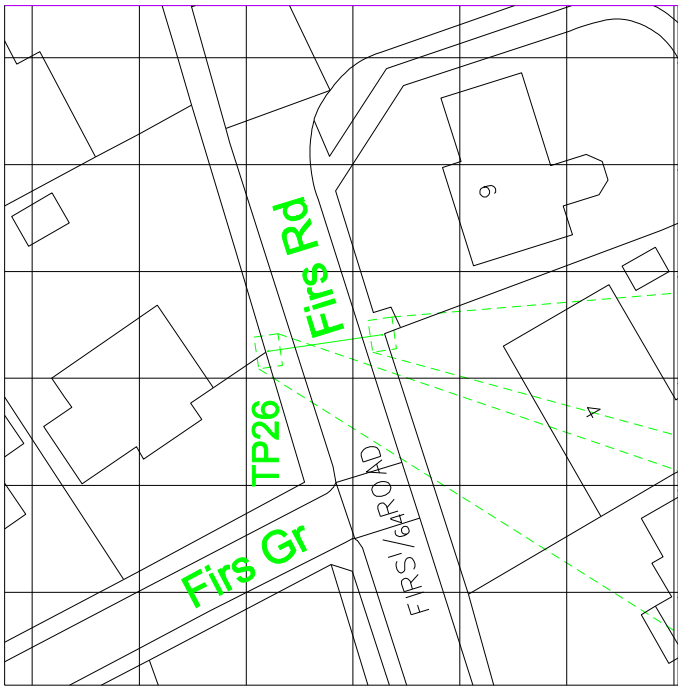

TP26 - Site Plan
1:500



TP26 - Existing



TP26 - Proposed

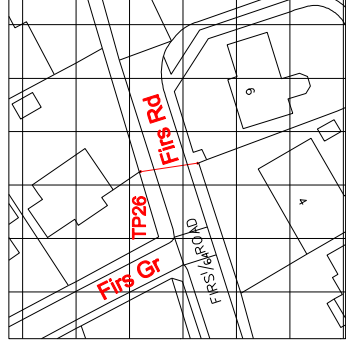

TP26 - Location Plan
1:1000

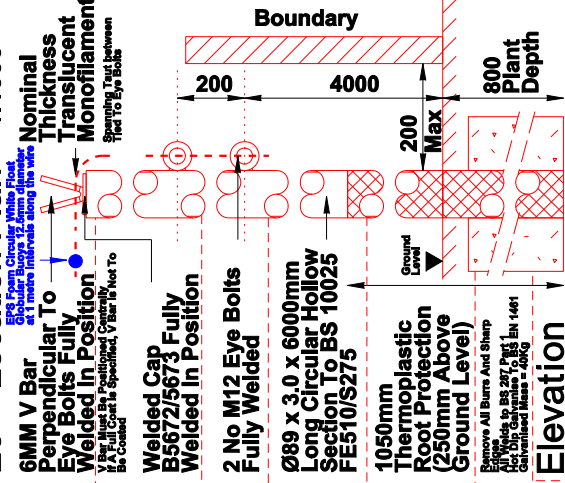

EP8 Foam Circular White Float Globular Buoys 12.5mm diameter at 1 metre intervals along the wire

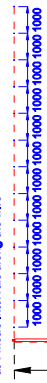

TP26 - Elevation
1:200

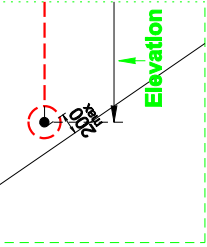

TP26 - Plan
1:50

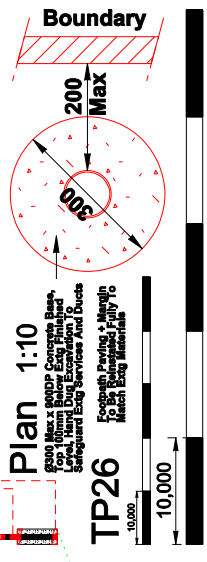

TP26 - Elevation
1:200



TP26 - Plan
1:50

Cheadle and Gatley Eruv Committee
Erection of street furniture in 33 locations, including steel poles, clear nylon wire, arches and posts in association with an Eruv

TP26

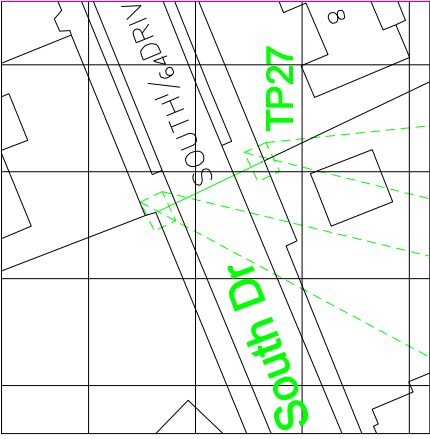

Styal Rd

South Dr

TP27

TP27 - Site Plan
1:500

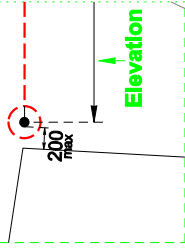

TP27 - Plan
1:50

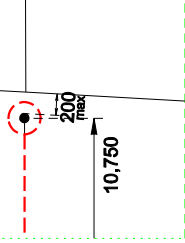

TP27 - Elevation
1:200



TP27 - Existing



TP27 - Proposed

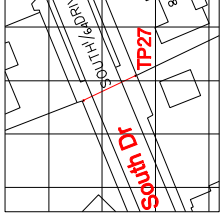

Styal Rd

TP27 - Location Plan
1:1000

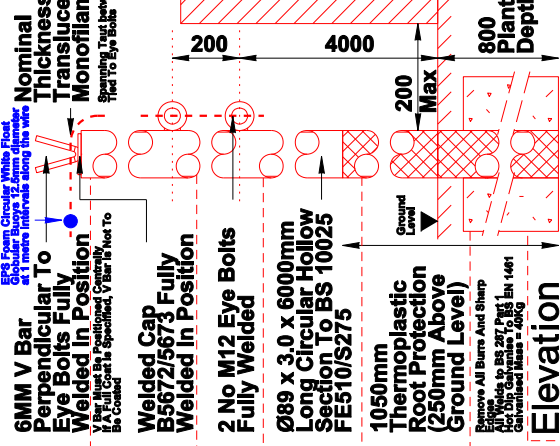

TP27 - Elevation
1:10

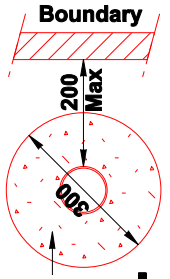

TP27 - Plan
1:10

2 x 6m
89mm Dia - Galvanised steel post
with wire Across South Drive

Cheadle and Gatley
Eruv Committee

Erection of street furniture in 33 locations,
including steel poles, clear nylon wire,
arches and posts in association with an Eruv

TP27

PLANNING

DO NOT SCALE FROM THIS DRAWING
If any discrepancy is noted, refer to the drawing
on site and report any such discrepancy to the
contractor or the planning department in writing.

FOR ELECTRONIC DATA ISSUE
Information for downloading and printing should be read
only from those values stated in text on the drawing.

SCALE: A3
DATE: 15/05/2017
NTR
© COPYRIGHT
May 2017

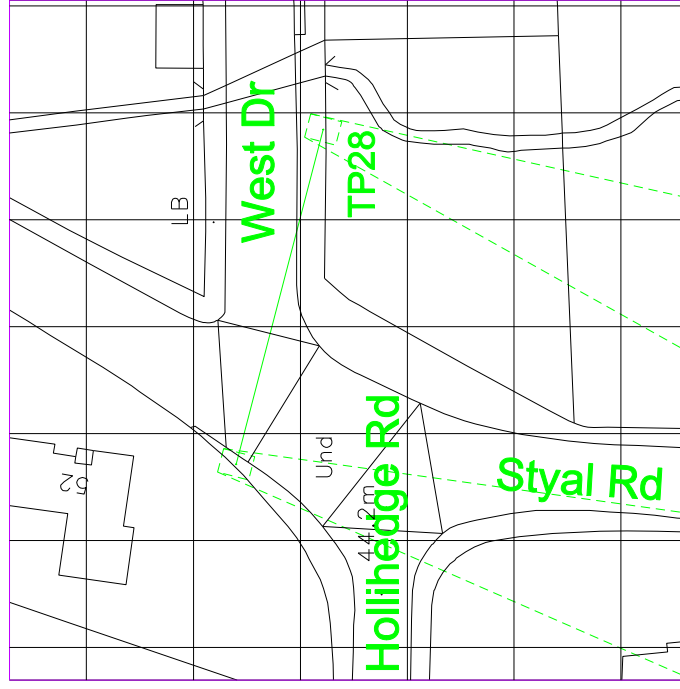

TP28 - Site Plan
1:500



TP28 - Existing

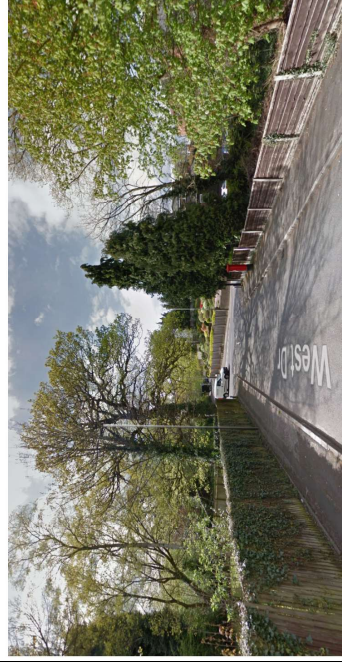

TP28 - Proposed

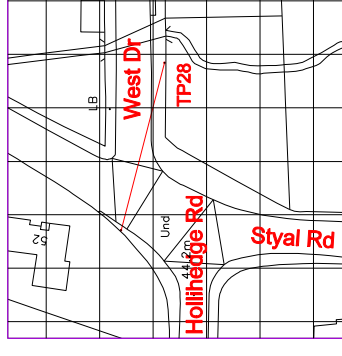

TP28 - Location Plan
1:1000

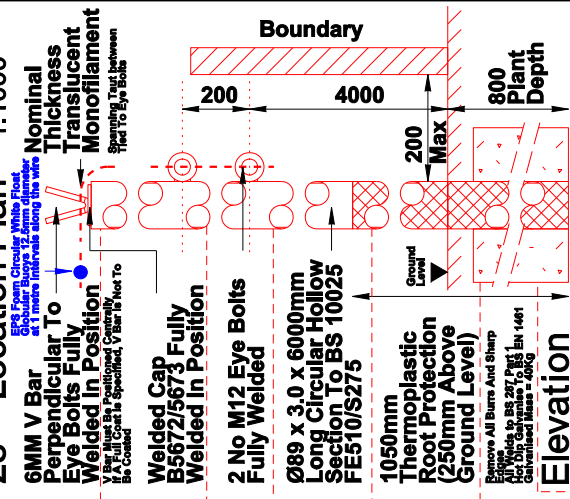

Plan 1:10

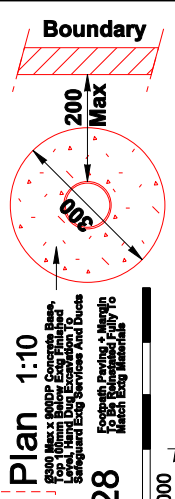

TP28

2 x 6m

89mm Dia - Galvanised steel post

From West Drive with wire

across Styal Road

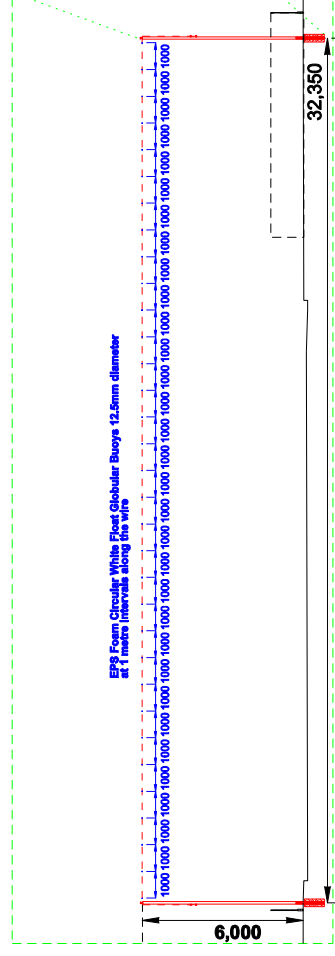

TP28 - Elevation

1:200

Erection of street furniture in 33 locations, including steel poles, clear nylon wire, arches and posts in association with an Eruv

Cheadle and Gatley Eruv Committee

TP28

PLANNING

SCALE: A3
DATE
NTR
MAY 2017
© COPYRIGHT
This document is the property of
Cheadle and Gatley Eruv Committee. It is to be used only for the purposes
intended and may not be copied, reproduced or distributed in any form
without the prior written consent of the committee. Any unauthorised use
will be a breach of copyright law.

DO NOT SCALE FROM THIS DRAWING
If any discrepancy arises between the drawing and the written
specification, the written specification shall prevail.
FOR ELECTRONIC DATA ISSUE
This drawing is the property of Cheadle and Gatley Eruv Committee. It is to be used only for the purposes
intended and may not be copied, reproduced or distributed in any form
without the prior written consent of the committee. Any unauthorised use
will be a breach of copyright law.

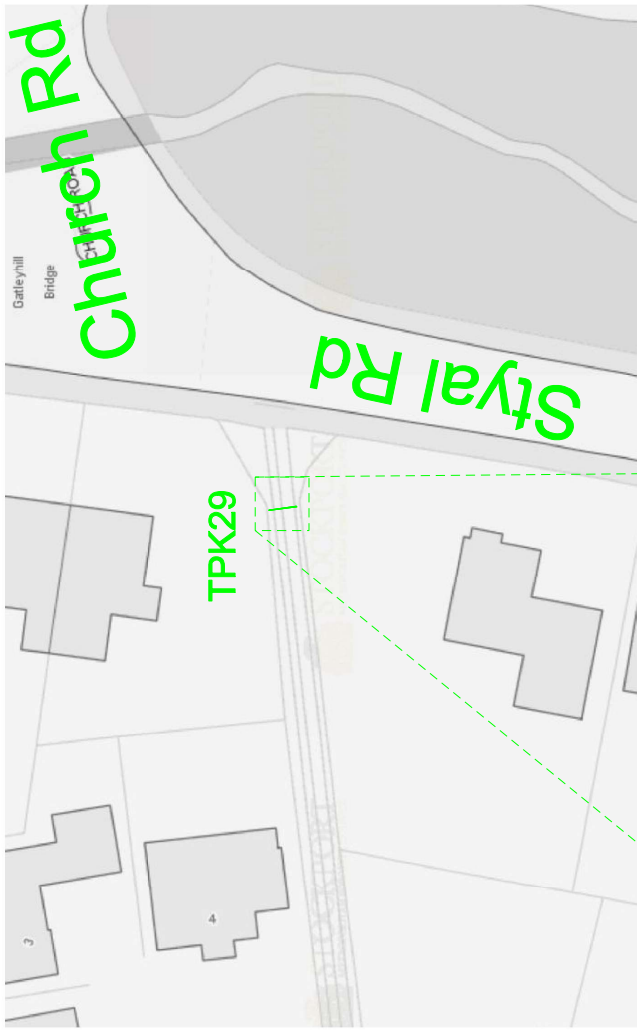

TPK29 - Site Plan 1:500

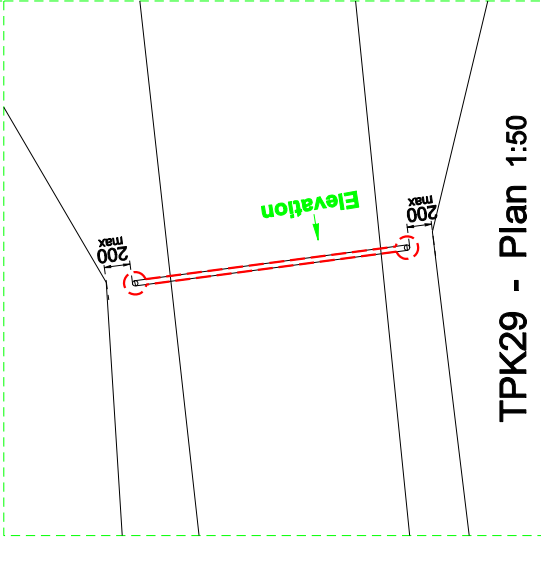

TPK29 - Plan 1:50



TPK29 - Existing



TPK29 - Proposed

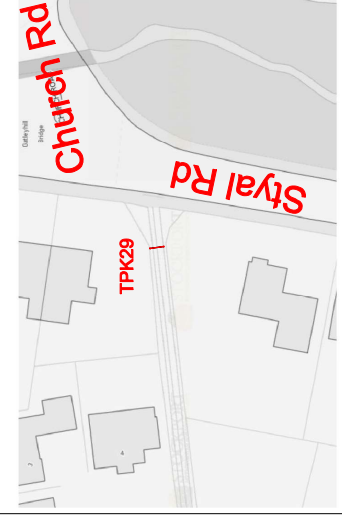

TPK29 - Location Plan
1:1000

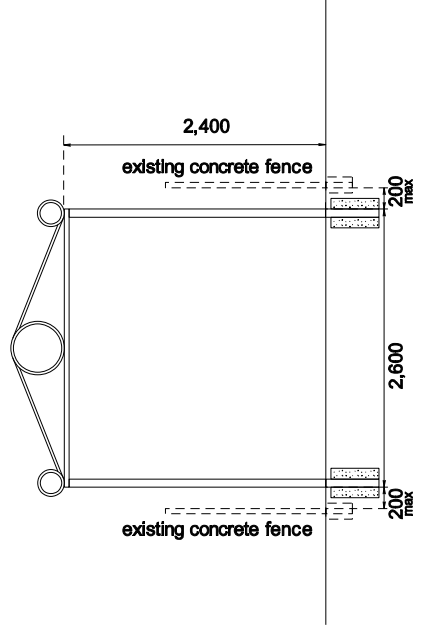

TPK29 - Elevation
1:50



TPK29
 TPK across footpath connecting
 Styal Rd and Halstead Gr at
 Styal Rd end
 2400mm High by 75mm Dia -
 Galvanised Steel posts
 and wrought iron scrollwork atop
 with Black Powder Coating

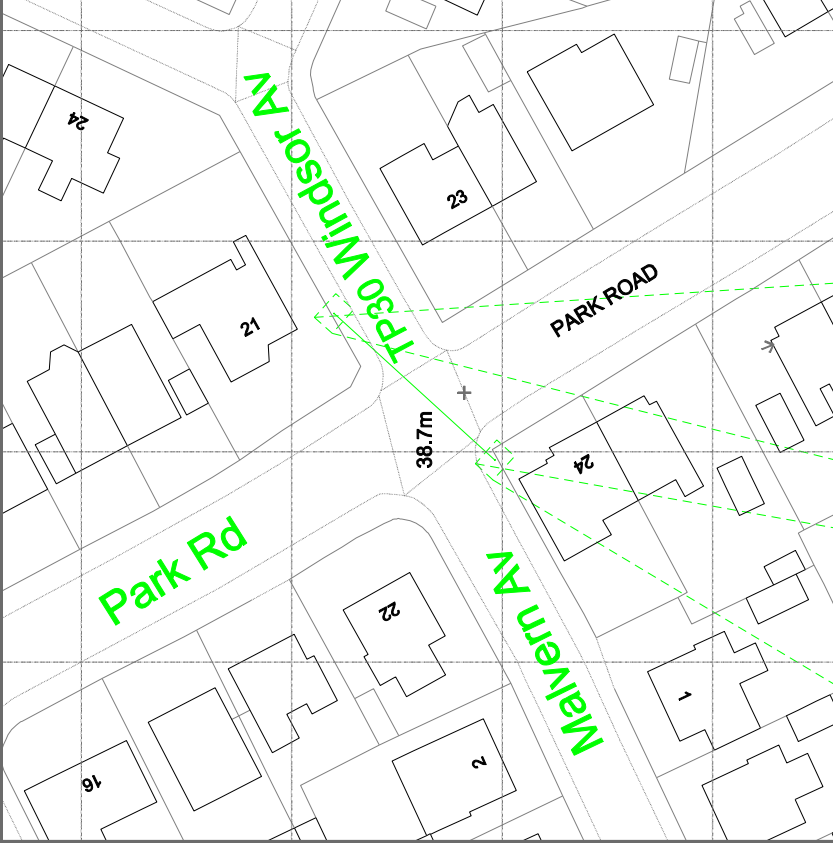

TP30 - Site Plan
1:500



TP30 - Existing



TP30 - Proposed

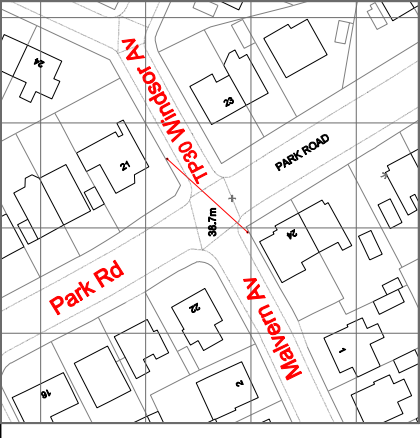

TP30 - Location Plan
1:1000

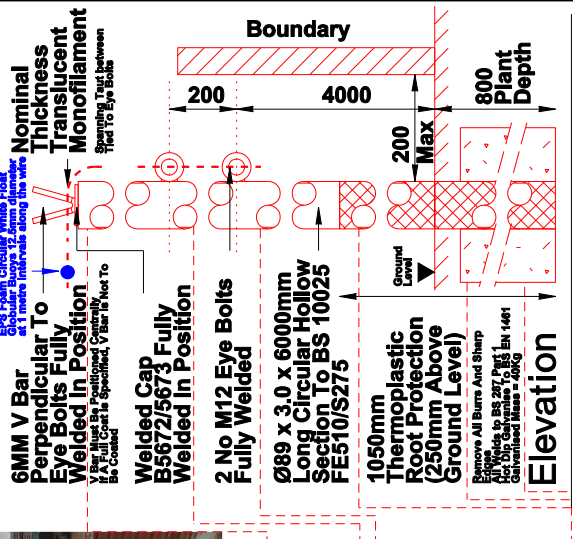

TP30 Elevation

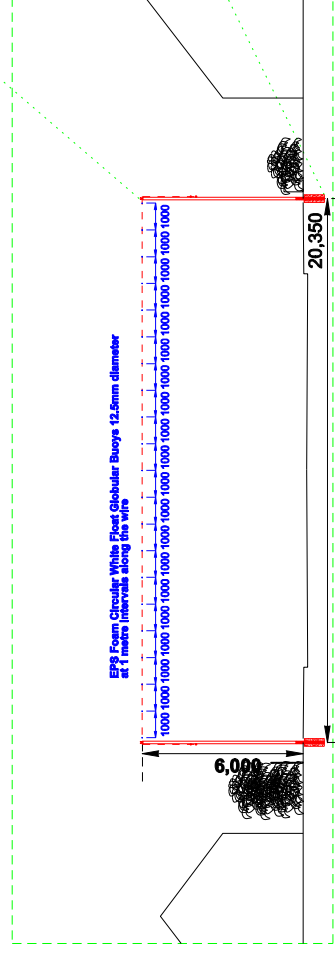

TP30 - Elevation
1:200

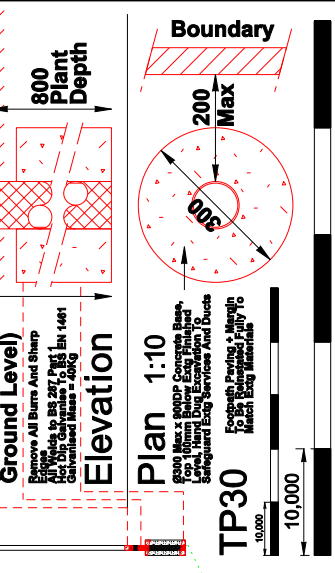

TP30 Plan 1:10

2 x 6m
89mm Dia - Galvanised steel post
with wire across Park Road

Cheadle and Gatley
Eruv Committee

Erection of street furniture in 33 locations,
including steel poles, clear nylon wire,
arches and posts in association with an Eruv

SCALE: A3 NTR DATE: 15/05/2017
© COPYRIGHT: 2017
This drawing is the property of the client and is to be used only for the purposes of the project for which it was prepared. It is not to be used for any other purpose without the written consent of the client. The client is responsible for the accuracy of the information provided and for the accuracy of the data used in the drawing. The client is responsible for the accuracy of the information provided and for the accuracy of the data used in the drawing. The client is responsible for the accuracy of the information provided and for the accuracy of the data used in the drawing.

DO NOT SCALE FROM THIS DRAWING
FOR ELECTRONIC DATA ISSUE
Information for dimensions: All dimensions are in millimetres unless otherwise stated. All dimensions are in millimetres unless otherwise stated. All dimensions are in millimetres unless otherwise stated.

PLANNING



TP31 - Site Plan
1:500



TP31 - Existing

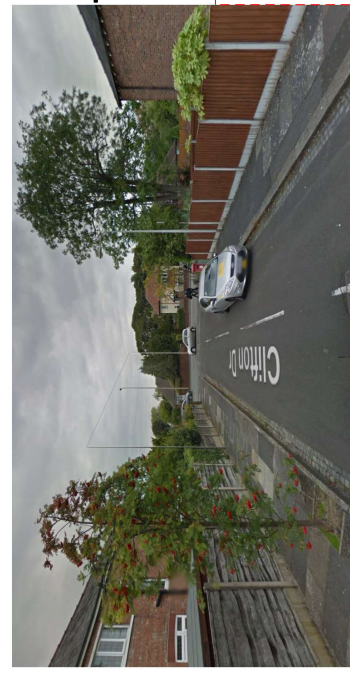

TP31 - Proposed

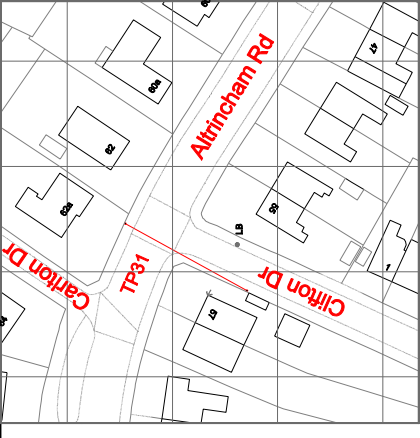

TP31 - Location Plan
1:1000

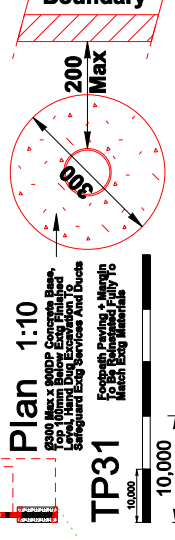
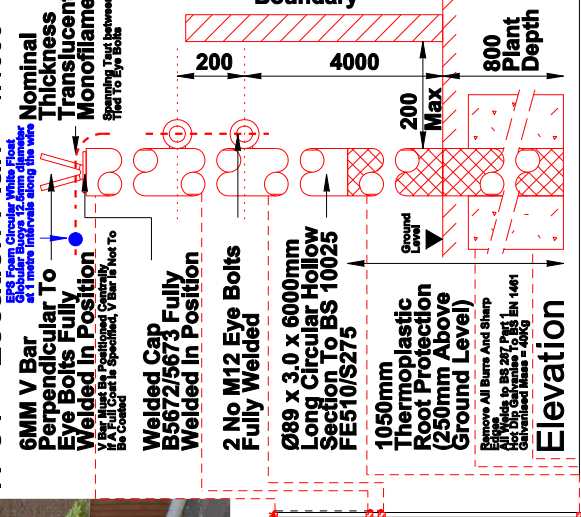

TP31 - Elevation
1:200

TP31 - Plan
1:50

TP31 - Elevation
1:200

Cheadle and Gatley Eruv Committee

Erection of street furniture in 33 locations, including steel poles, clear nylon wire, arches and posts in association with an Eruv

TP31

SCALE: A3 NTS DATE
MAY 2017
PLANNING

DO NOT SCALE FROM THIS DRAWING
This drawing is intended to be used as a guide only. It is not to be used for construction purposes. It is the responsibility of the client to ensure that the drawing is used in accordance with the relevant standards and specifications. The client is responsible for the accuracy and completeness of the information provided. The client is responsible for the accuracy and completeness of the information provided. The client is responsible for the accuracy and completeness of the information provided.

FOR ELECTRONIC DATA ISSUE
This drawing is intended to be used as a guide only. It is not to be used for construction purposes. It is the responsibility of the client to ensure that the drawing is used in accordance with the relevant standards and specifications. The client is responsible for the accuracy and completeness of the information provided. The client is responsible for the accuracy and completeness of the information provided. The client is responsible for the accuracy and completeness of the information provided.

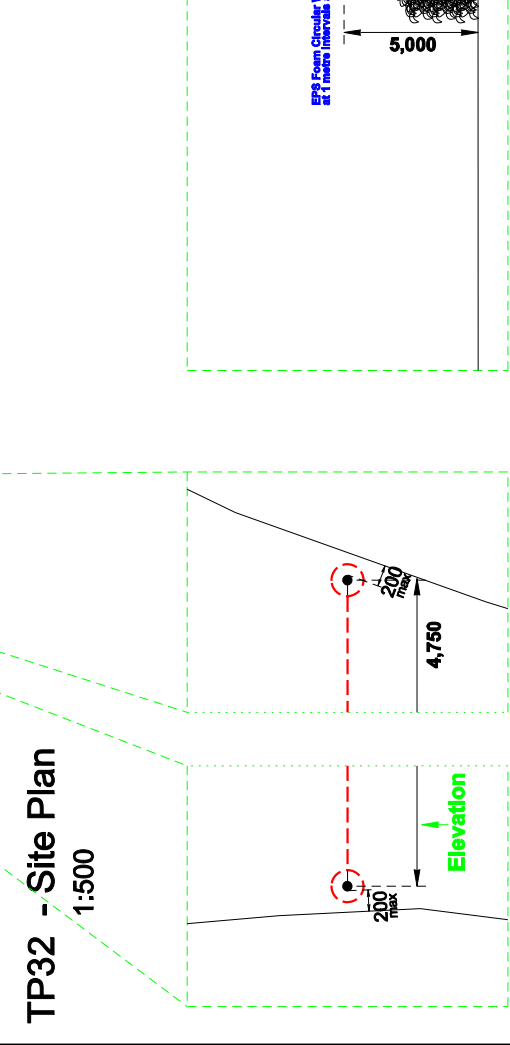
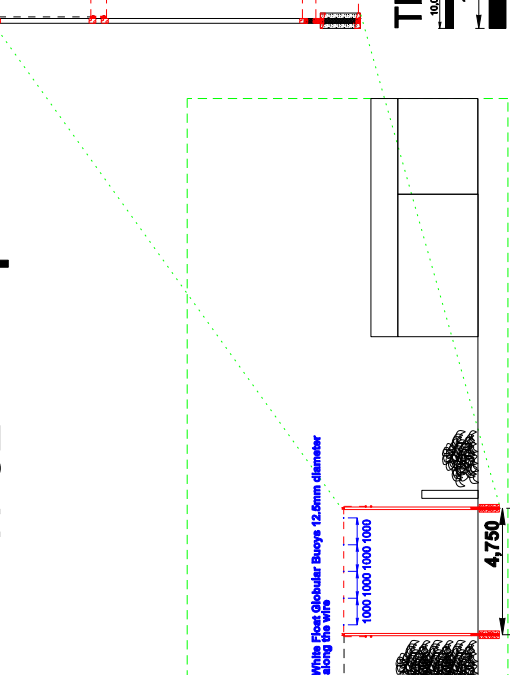
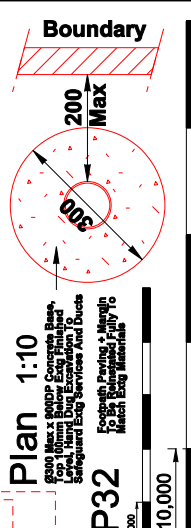
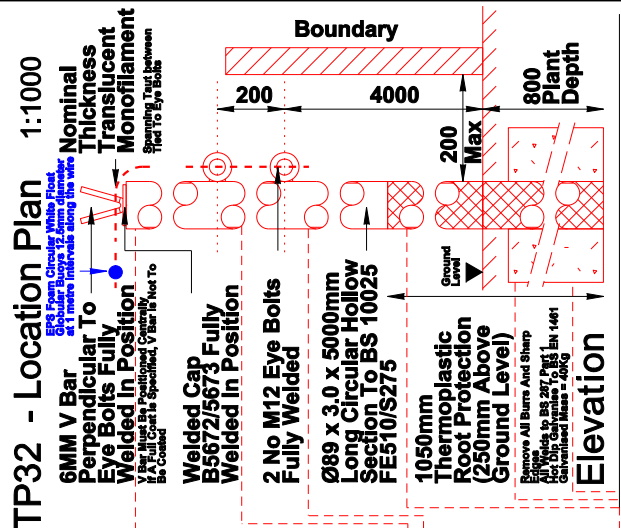
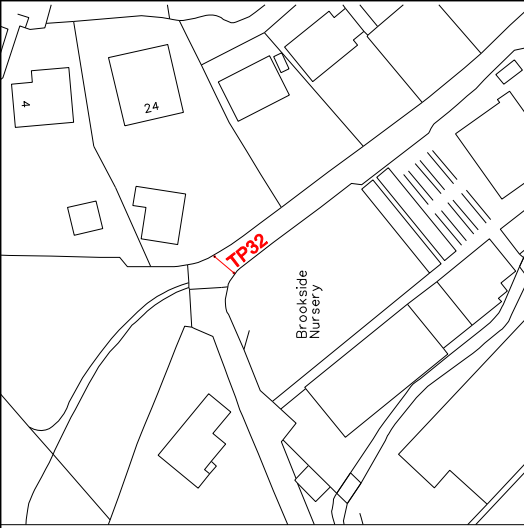
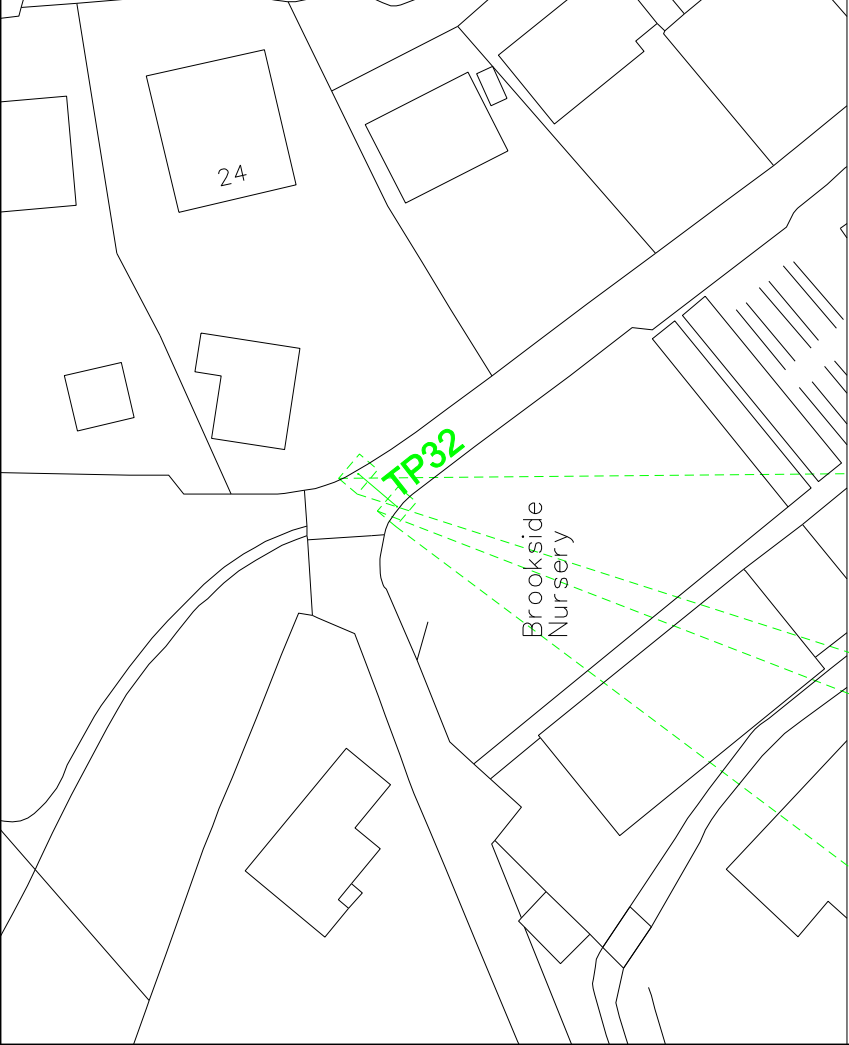

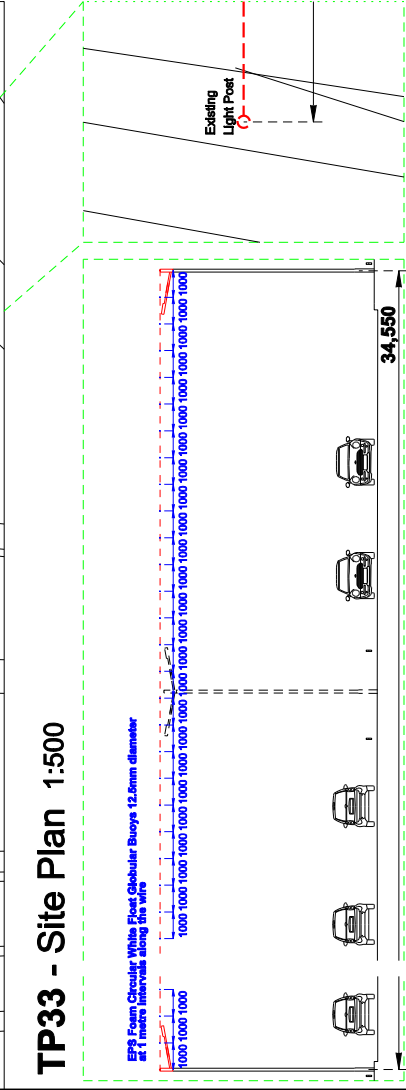
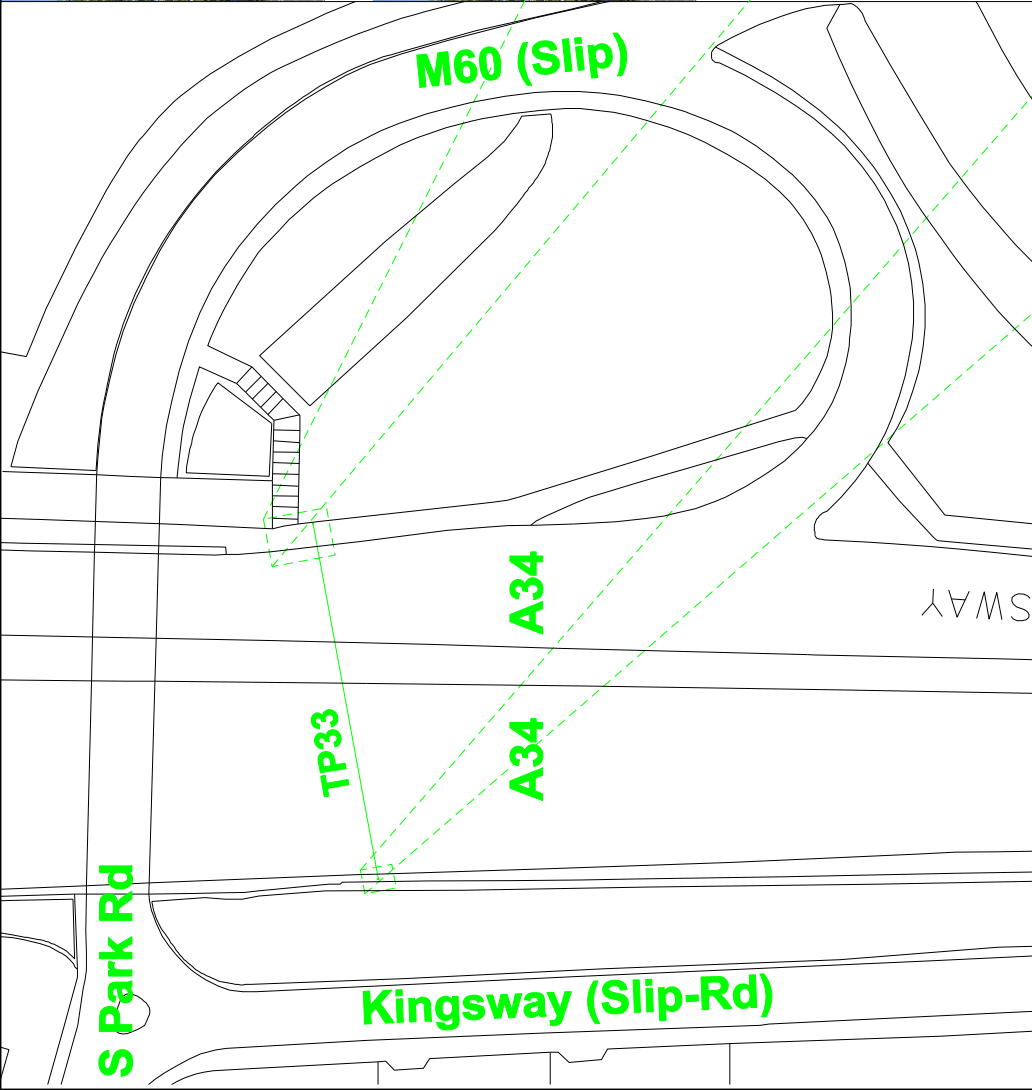
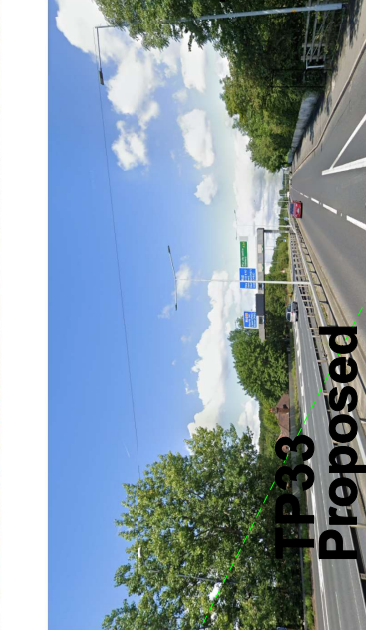
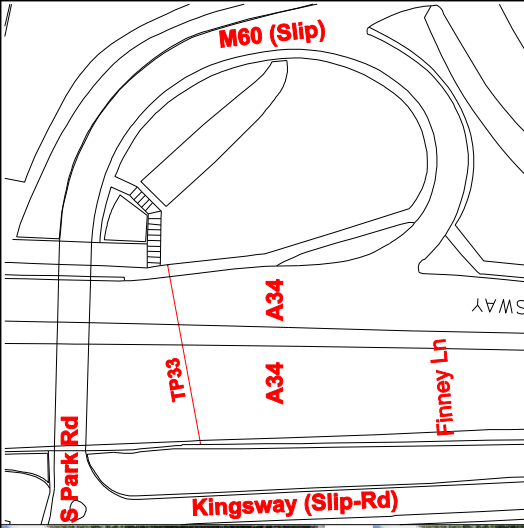

Light Post Head Attachment Detail
To be agreed with Stockport Lighting Department

TP33 Across A34
using existing lampposts with head attachments for wire 'eye bolt' at corresponding height of L/P Details to be agreed With relevant Officers

EPF From Circular White Post Globular Buoys 12.8mm diameter at 1 metre intervals along the wire



TP33 - Elevation 1:200

Erection of street furniture in 33 locations, including steel poles, clear nylon wire, arches and posts in association with an Eruv

Cheadle and Gatley Eruv Committee

TP33 - Plan 1:50

SCALE: A3
DATE: 17th May 2017
NTR
© COPYRIGHT
This document is issued by Yorkshire LPS in the interests of transparency and to allow the public to view the information held by the company. It is not to be used for any other purpose without the prior written consent of Yorkshire LPS. Any reproduction or distribution of this document is prohibited unless otherwise agreed in writing.



FOR ELECTRONIC DATA ISSUE
This document is issued by Yorkshire LPS in the interests of transparency and to allow the public to view the information held by the company. It is not to be used for any other purpose without the prior written consent of Yorkshire LPS. Any reproduction or distribution of this document is prohibited unless otherwise agreed in writing.